

PUTCO TRADITIONAL LOCKER RAIL INSTRUCTION 2014 CHEVY AND GMC

Section I – Installation Preparation

Kit Contents

Item #	Quantity Req.	Description
1	4	End Castings
2	2	Tubes
3	1	Hardware kit
4	2	Rubber expanders
5	1	Cover plate – RH
6	1	Cover plate - LH
7	2	Bracket – Rear mount

Hardware Kit Contents

Item #	Quantity Req.	Description
1	2	5/16" X 2 1/2" Bolts
2	4	Black or SS and rubber Gaskets
3	4	Black bushing
4	2	5/16" X 3" Full threaded bolts
5	4	Plastic washer
6	2	3/8" Flat washer
7	2	3/8"-16 Hex bolt - SS
8	4	Threaded Plate

Additional Items Required For Installation

Item #	Quantity Req.	Description
1	None	

Conflicts

Note:







Recommended Tools

Safety Tools	
Eye Protection (if drilling)	
Special Tools	
Corded or Cordless Drill (if drilling)	
Torque Wrench	
Installation Tools	
1/4" Allen wrench	
5/16" Drill bit (if drilling)	
9/16" Wrench	
Special Chemicals	
Streak free cleaner	Automotive wax

Recommended Sequence of Application

Item #	Accessory	
1	Bolt hardware to castings	
2	Insert castings into tube	
3	Insert assembly into stake pockets	

Legend

	STOP: Damage to the vehicle may occur. Do not proceed until process has been complied with.
	OPERATOR SAFETY: Use caution to avoid risk of injury.
	CRITICAL PROCESS: Proceed with caution to ensure a quality installation. These points will be audited on a completed vehicle installation.
	GENERAL PROCESS: This highlights specific processes to ensure a quality installation. These points will be audited during the accessory installation.
	TOOLS & EQUIPMENT: Calls out the specific tools and equipment recommended for this process.
	REVISION MARK: This mark highlights a change in installation with respect to previous issue.

FOR TECHNICAL ASSISTANCE CALL

1-800-357-9261

Monday –Friday 8:00am – 5:00pm (CST)

PUTCO TRADITIONAL LOCKER RAIL INSTRUCTION - 2014 CHEVY AND GMC

A. Pre-installation Preparation

- ➡ 1. Verify kit contents.
- ➡ 2. Remove protective wrapping from tubes and castings. Place on a non-abrasive surface.
- ➡ 3. Remove the hardware from the box.

B. Assemble castings and mounting hardware for the front two stake pockets

- ➡ Put plastic washer on the bolt and insert the bolt through the top of the casting
- ➡ Insert the gasket, expander, and threaded plate on the bottom and finger tighten. (Figure B1)
- ➡ The front stake pocket holes are covered with a plastic bed cap. Using a “Dremel” or similar tool, cut out the plastic covering the hole, as indicated by the molded outline in the plastic bed cover.
- ➡ Place a bushing on each casting so that the tabs face towards the tube.

C. Assemble castings and mounting hardware for the rear two stake pockets

- ➡ Put plastic washer on the bolt and insert the bolt through the top of the casting
- ➡ Insert the gasket, cover plate, bracket w/clip nut and threaded plate on the bottom of the casting and finger tighten. (Figure C1) You need to have the correct cover plate with the smooth side up and ensure that the shoulder on the bottom goes into the stake pocket. (Figure D2)

Note: There are RH and LH cover plates.

- ➡ Place a bushing on each casting so that the tabs face towards the tube.

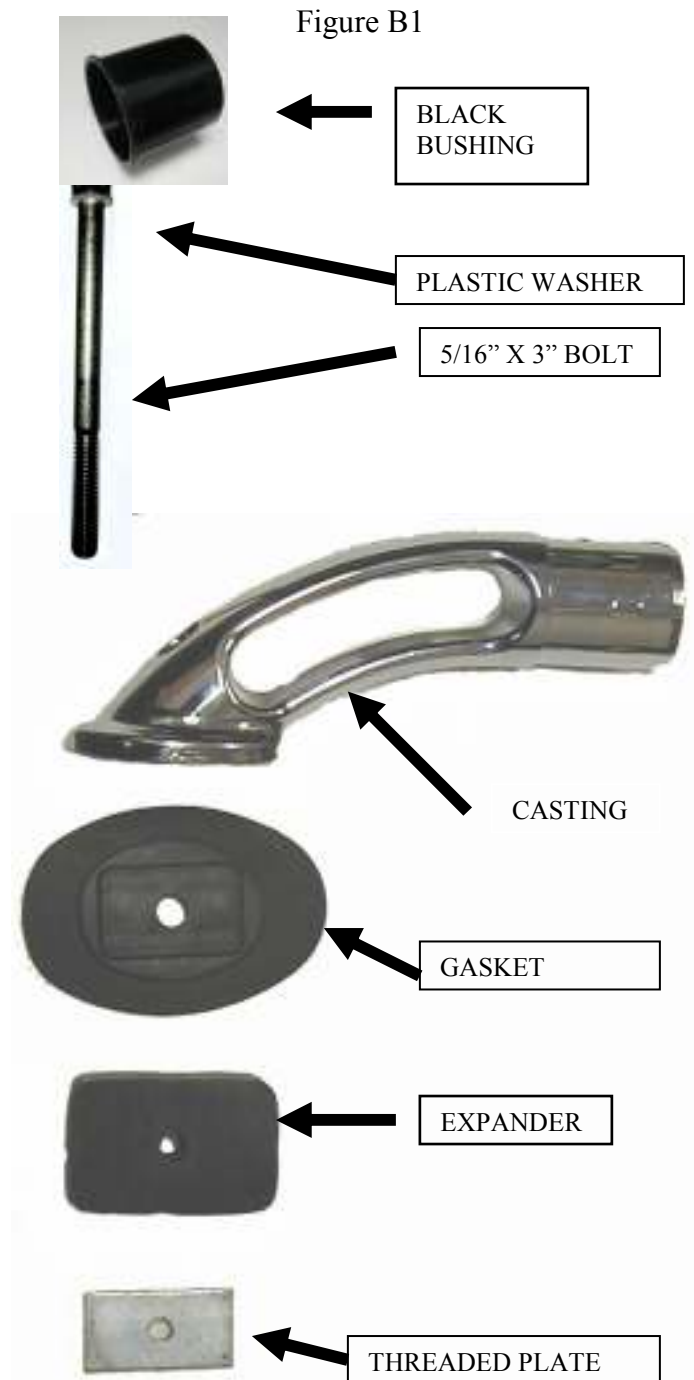

PUTCO TRADITIONAL LOCKER RAIL INSTRUCTION - 2014 CHEVY AND GMC

C. Insert the casting into the tubes

- ➡ 1. Insert a casting into each end of the tube.
 - ⚠ i. **IMPORTANT:** if installing with a tool box place one assembled casting on each tube.
 - ⚠ ii. **IMPORTANT:** if tube is tight on casting use a rubber mallet to install. Be careful not to scratch the casting.

D. Install assembled rail on truck with stake pockets.

- ➡ 1. Insert the assembled rail into the stake pockets on the vehicle.
- ➡ 2. Install the two 3/8" bolts with washers into the clip nuts on the rear brackets thru the inside surface of the truck box. Tighten with 9/16" wrench. (Figure D1)

E. Install assembled rail on truck with tool box

See Putco catalog or contact Putco for the "Diamond Donut" option to mount your rails directly to the side of your toolbox.

- ➡ 1. Place a casting, without the bolt, gasket, expander or back plate, into the open end of the tube.
- ➡ 2. Place assembled tube onto truck by inserting the cover plate and bracket of the assembled casting into the rear stake pocket.
- ⚠ 3. Center the front casting, left to right, on your truck's bed rail near the toolbox.
- ⚠ 4. Mark the center of the hole in the casting on your truck's bed rail.
- ✚ 5. Using your drill and 5/16" drill bit, center the drill bit on the mark you made from Step 4

REAR STAKE POCKET ASSEMBLY
FIGURE C1

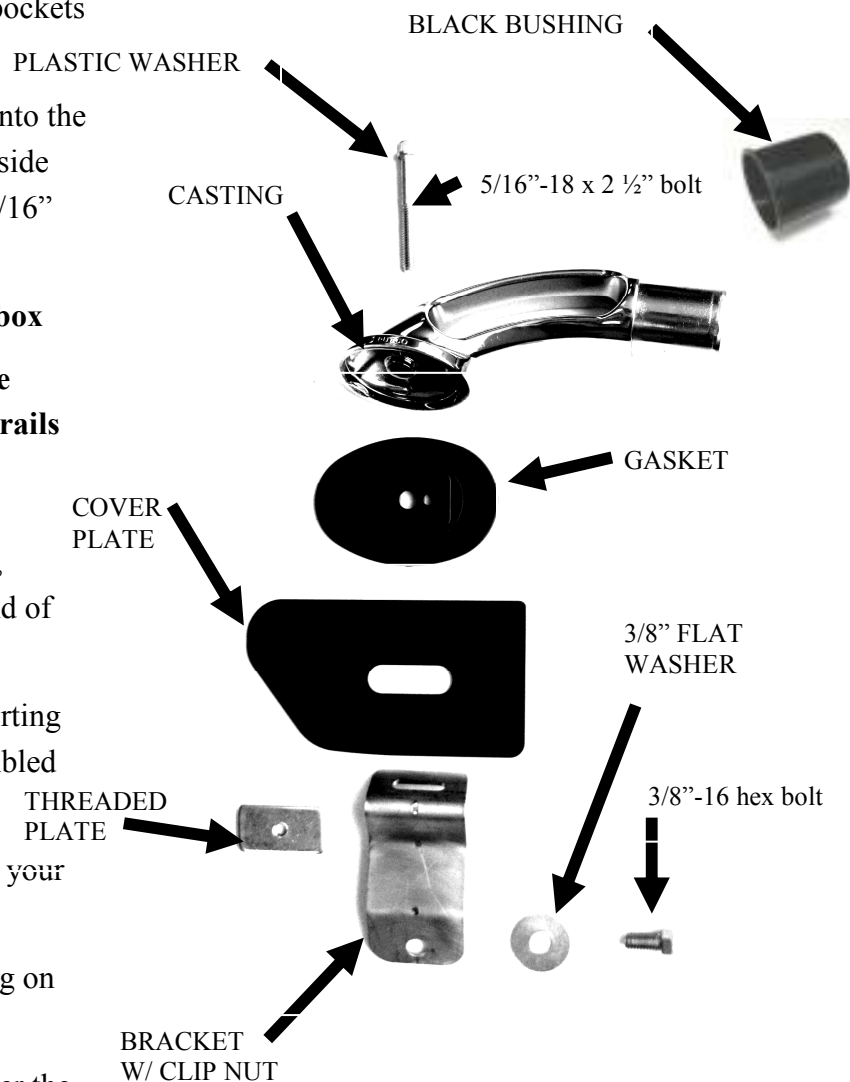

PUTCO TRADITIONAL LOCKER RAIL INSTRUCTION - 2014 CHEVY AND GMC

above and drill straight through the bed rail of your truck.

- ➡ 6. Place the rail assembly back onto the bed of your truck, again by placing the cover plate and bracket into the rear stake pocket of the same side you just drilled.
 - ➡ 7. At the front casting, place a 5/16" X 3" bolt through the casting, oval gasket and the hole you drilled in Step 5. Place the expander block on the bolt and turn on a treaded plate and hand tighten.
 - ➡ 8. Repeat the steps in this section for other side.
- Fig. E1

F. Clean rails

- ➡ 1. Clean the rails with a streak free cleaner.
- ➡ 2. Apply a protective coating of high quality automotive wax.

FIGURE D1



FIGURE D2

