

EnCore Cover Installation Supplement

SUPPLEMENT to INSTALLATION INSTRUCTIONS

Step 1

- A** — Position EnCore Side Rail on truckbed 1" back from the cab rail sheetmetal edge.
If the truck has a bedliner, the distance will be smaller.

NOTE: Make sure that both side rails are exactly the same distance.

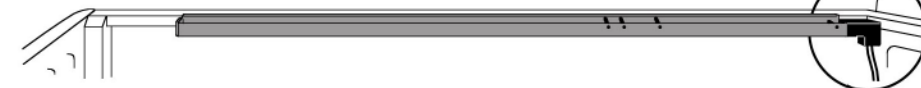

- B** — Carefully locate clamps as follows.

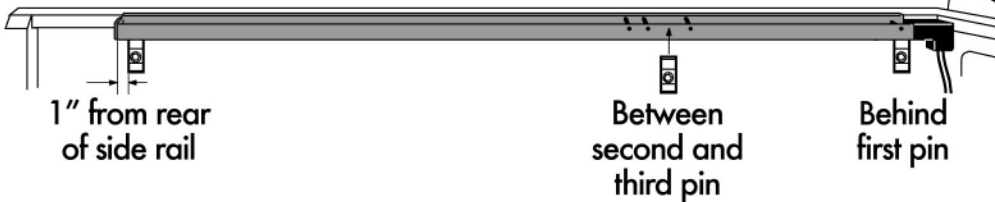

- C** — Hold Rail in place and PUSH side rail DOWN as you attach the clamps.
You will need assistance with this step.

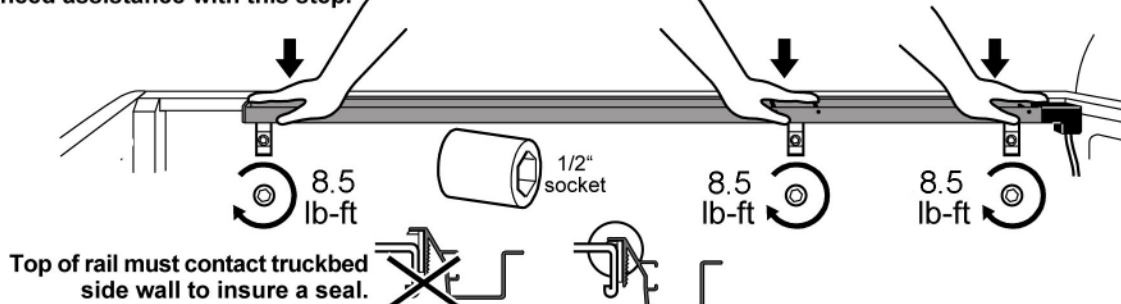

- D** — Adjust clamp position to make sure side rail is level and in contact with truckbed side wall.

Clamp too low
pulling side rail down



Clamp too high
pushing side rail up

Step 2

- A** — Check to see that each tail panel latch makes proper contact with the EnCore side rails.

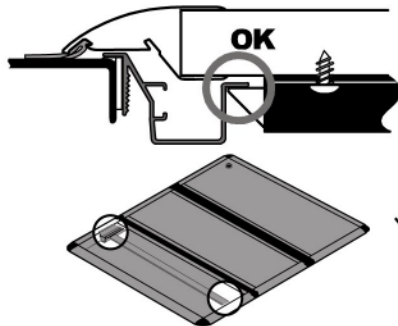

If tail panel latch
doesn't contact side
rail properly...

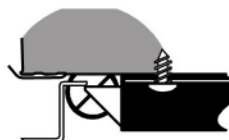

...hand-loosen latch screws
and slide the latch toward
the side rail.
Retighten
screws by hand.

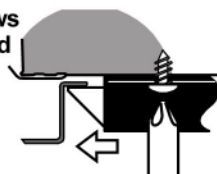
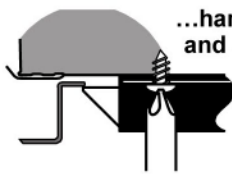

If the tail panel latch is not
tight to the EnCore Side Rail,
add spacer to side rail lip.

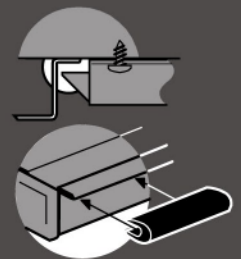

extang
AMERICA'S BEST
SELLING TONNEAUS

Extang Corporation
1901 E. Ellsworth Rd.
Ann Arbor, MI 48108
734 677-0444, Fax: 734 677-8409

Register your warranty at:

www.extang.com

Item No. 0231s-1202 RH Printed in U.S.A.