

S7110

2008-2010 DODGE CHALLENGER SRT8®
6.1L HEMI CAT BACK, DUAL SPLIT REAR

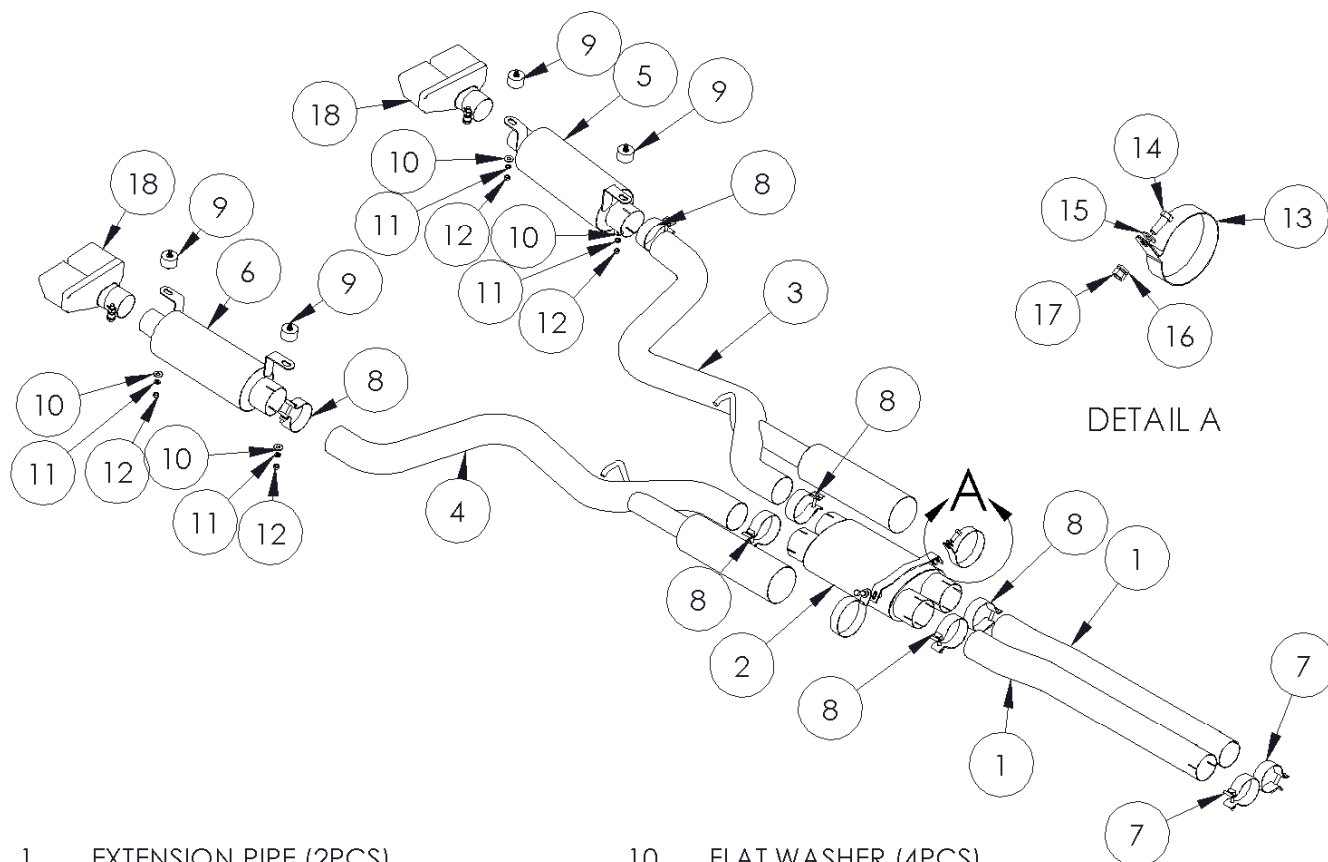

- | | |
|-------------------------------------|-------------------------------|
| 1. EXTENSION PIPE (2PCS) | 10. FLAT WASHER (4PCS) |
| 2. RESONATOR ASSEMBLY | 11. LOCK WASHER (4PCS) |
| 3. TAILPIPE ASSEMBLY DRIVER SIDE | 12. M8 HEX NUT (4PCS) |
| 4. TAILPIPE ASSEMBLY PASSENGER SIDE | 13. TUBE SUPPORT (2PCS) |
| 5. MUFFLER ASSEMBLY DRIVER SIDE | 14. 3/8" X 1" HEX BOLT (2PCS) |
| 6. MUFFLER ASSEMBLY PASSENGER SIDE | 15. 3/8" FLAT WASHER (2PCS) |
| 7. 2 3/4" BAND CLAMP (2PCS) | 16. 3/8" LOCK WASHER (2PCS) |
| 8. 3" BAND CLAMP (6PCS) | 17. 3/8" HEX NUT (2PCS) |
| 9. M8 EXHAUST HANGER (4PCS) | 18. EXHAUST TIP (2PCS) |

PLEASE READ BEFORE STARTING INSTALLATION

While MBRP Inc. has made every effort to ensure that all components of this system are of superior quality and properly packaged it is the installer's responsibility to ensure the following before removal of the factory exhaust:

- that ALL components shown above are present.
- that ALL mating components fit together.
- that there are no damaged components.
- that the system you have purchased is appropriate for your vehicle year, model and configuration.
- that the system will not interfere with any modifications previously installed or planned.
- that you have read and understand these instructions.

If you have any questions or are uncertain about any aspect of the installation of this system to your vehicle please contact your dealer before commencing installation.



2008-2010 DODGE CHALLENGER SRT8®

Removal of Stock System:



Figure 1

1. Apply a penetrating lubricant liberally to all exhaust fasteners, hangers and rubber insulators.

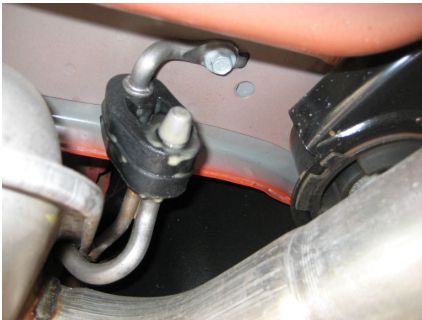

Figure 2

2. Remove the nuts from the flange on the rear of the muffler (on the driver side). Remove the rubber insulator. **Refer to Figure 1.**

3. Remove the two factory hangers by removing the hardware on the driver side. Remove the driver side muffler and tail pipe. **Refer to Figure 2.**



Figure 3

4. Loosen the band clamps on the factory exhaust located in front of the X-pipe. **Refer to Figure 3.**



Figure 4

5. Remove the two factory hangers by removing the hardware on the passenger side. Remove the rubber isolator behind the dual muffler. Remove the passenger side exhaust from the X-pipe back. **Refer to Figure 4.**

Installation of MBRP Inc. Performance Exhaust:

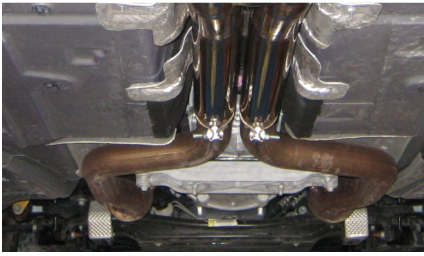

Figure 5

1. Slide two **2 3/4" Band Clamps** over the remaining factory exhaust pipes. Install the **Extension Pipes** using the **2 3/4" Band Clamps** leaving them loose enough for some adjustment. **Refer to Figure 5.**



Figure 6

2. Slide two **3" Band Clamps** over the **Extension Pipes** and install the **Resonator Assembly** onto the **Extension Pipes**. **Refer to Figure 6.**

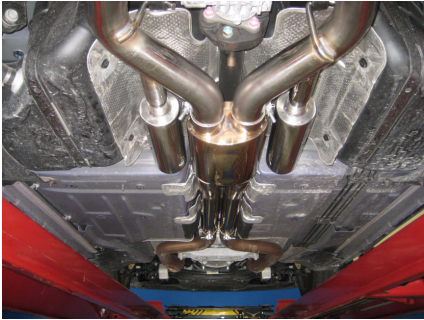

Figure 7

3. Slide a **3" Band Clamp** over the **Resonator Assembly** on the driver side outlet and slide the appropriate end of the **Tail Pipe Assembly Driver Side** into the **Resonator Assembly**. **Refer to the Illustration on Page 1.** Slide the hanger on the **Tail Pipe Assembly Driver Side** into the rubber insulator. **Refer to Figures 7 & 8.**



Figure 8

4. Slide a **3" Band Clamp** over the passenger side **Resonator Assembly** outlet and slide the appropriate end of the **Tail Pipe Assembly Passenger Side** into the **Resonator Assembly**. **Refer to the Illustration on Page 1.** Slide the hanger on the **Tail Pipe Assembly Passenger Side** into the rubber insulator. Note it may be easier to remove the rubber insulator from the vehicle and install it onto the **Tail Pipe Assembly Passenger Side** first. **Refer to Figures 7 & 8.**

5. Slide the **Tube Supports** on to the **Tail Pipe Assemblies** and use the fasteners provided to attach to them to the **Resonator Assembly**. **Refer to the Illustration on Page 1.**



Figure 9

6. Attach the four **M8 Exhaust Hangers** to the frame where the factory hangers were removed (two on each side). **Refer to Figure 9.**



Figure 10

7. Slide a **3" Band Clamp** onto each Tailpipe. Attach the **Muffler Assemblies** to the **Tail Pipes**. Use the **M8 Exhaust Hangers** and the hardware provided to attach the **Muffler Assemblies** to the vehicle. **Refer to Figure 10.**



Figure 11

8. Slide the **Exhaust Tips** onto the **Muffler Assemblies**. Align the **Exhaust Tips** as required. Starting at the front of the exhaust, tighten all clamps and connections. **Refer to Figure 11.**

9. Check along the whole length of the exhaust system to ensure that there is adequate clearance around the spare tire, fuel and brake lines or any wiring. If any interference is detected relocate or adjust.



Congratulations! You are ready to begin experiencing the improved power, sound and driving experience of your MBRP Inc. performance exhaust system. We know you will enjoy your purchase.