

# S6240

03-07 FORD F350/F450/F550 6.0L  
POWERSTROKE, CAB & CHASSIS, TURBO  
BACK, OFF ROAD,

# MBRP

INC.

**PERFORMANCE EXHAUST**

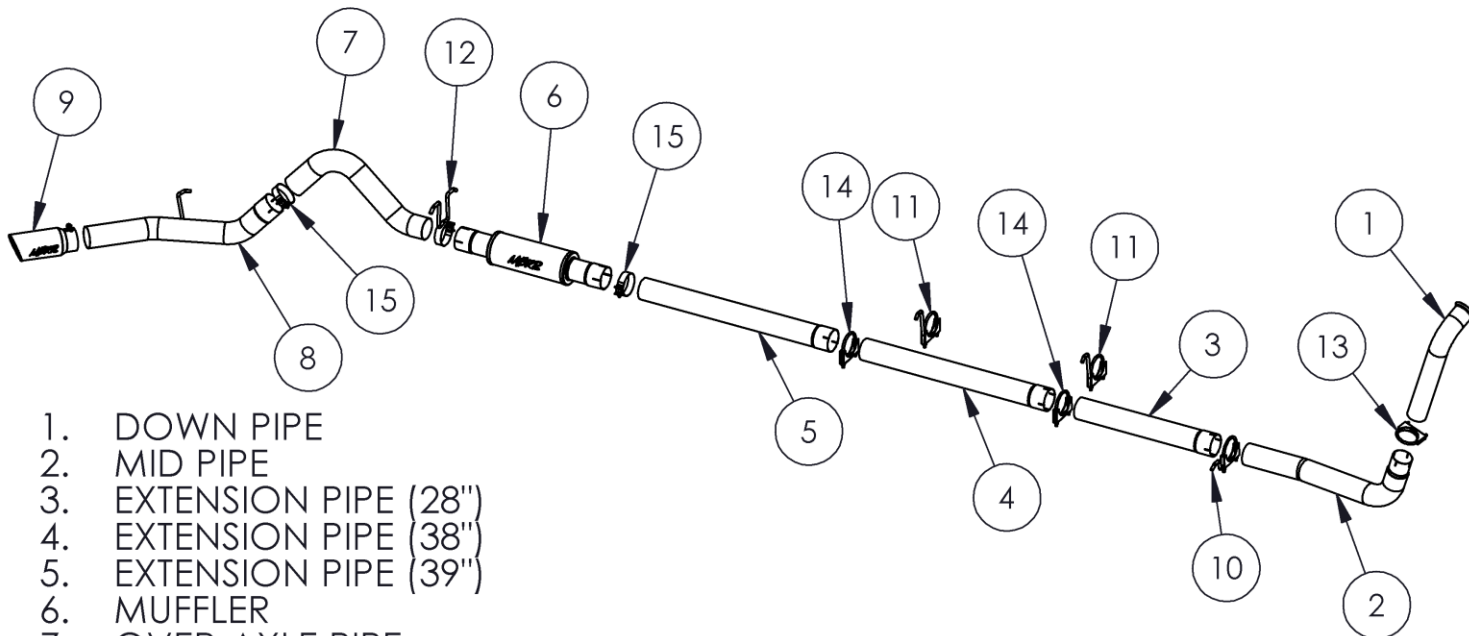

1. DOWN PIPE
2. MID PIPE
3. EXTENSION PIPE (28")
4. EXTENSION PIPE (38")
5. EXTENSION PIPE (39")
6. MUFFLER
7. OVER-AXLE PIPE
8. TAIL PIPE
9. EXHAUST TIP
10. 4" HANGER CLAMP
11. 4" HANGER CLAMP (2 PCS)
12. 4" BAND HANGER CLAMP
13. 3.5" CLAMP
14. 4" CLAMP (2 PCS)
15. 4" BAND CLAMP (2 PCS)

\*NOTE: MUFFLER MAY NOT BE EXACTLY AS SHOWN

## PLEASE READ BEFORE STARTING INSTALATION

While MBRP Inc. has made every effort to ensure that all components of this system are of superior quality and properly packaged it is the installer's responsibility to ensure the following before removal of the factory exhaust:

- that ALL components shown above are present.
- that ALL mating components fit together.
- that there are no damaged components.
- that the system you have purchased is appropriate for your vehicle year, model and configuration.
- that the system will not interfere with any modifications previously installed or planned.
- that you have read and understand these instructions.

If you have any questions or are uncertain about any aspect of the installation of this system to your vehicle please contact your dealer before commencing installation.



### Removal of Stock System:

1. Apply a penetrating lubricant liberally to all exhaust fasteners, hangers and rubber insulators.
2. Loosen the nut on the band clamp located behind the catalytic converter.
3. Remove the muffler and tail pipe from the OEM rubber hangers. Cut the stock exhaust behind the muffler and remove the tail pipe. Separate the slip joint located behind the catalytic converter and remove the remaining section of the stock exhaust.
4. Remove the catalytic converter by removing the two nuts holding the inlet flange together.
5. Remove the down pipe from the turbo by removing the band clamp. Retain the band clamp for the installation of the new down pipe. Cut the down pipe in front of the transmission cross member to remove.  
(Note: The stock down pipe can be removed in one piece by removing the transmission cross member. MBRP Inc. recommends that this procedure only be done by qualified, trained professionals using tools and equipment designed to safely carry out this process.)

### Installation of MBRP Inc. Performance Exhaust:

1. Install the **Down Pipe** in the same position as the stock down pipe and attach the flared end to the turbo using the stock band clamp. Do not fully tighten until all components are in place.
2. Attach the **Mid Pipe** to the **Down Pipe** using the **3 1/2" Clamp** to secure the slip joint.
3. Install the **Extension Pipe** onto the **Mid Pipe**. Refer to chart below to determine which **Extension Pipes** are required and if required shortening.

Wheelbase	28" Extension Pipe	38" Extension Pipe	39" Extension Pipe
141"	No	No	Required
165"	Required	Required	No
189"	Required	Required	Cut to 27"
201"	Required	Required	Required

**Installation Tip:** Temporarily install the **Muffler** and the **Over-Axle Pipe** using the factory rubber insulators and the **4" Band Hanger Clamp**. Measure from the **Muffler** to the **Mid Pipe** and cut the **Extension Pipe** to the required length.

4. Install the **Muffler** over the **Extension Pipe** securing it with one of the provided **4" Band Clamps**. Install the **4" Band Hanger Clamp** into the two OEM rubber hangers located above the outlet of the **Muffler**
5. Install the **Over-Axle Pipe** from the rear of the truck, over the axle and attach to the **Muffler Outlet** securing it with the **4" Band Hanger Clamp**.
6. Install the **Tail Pipe** from the rear of the truck and attach to the **Over-Axle Pipe** securing it with the remaining **4" Band Clamp**. Install the tail pipe hanger into the OEM hanger, adjust for best axle clearance and **Tail Pipe** exit location to complete.
7. Install the remaining clamps around the pipes where needed. Adjust the **Tail Pipe** and check along the whole length of the exhaust system to ensure that there is adequate clearance around the fuel and brake lines or any wiring. If any interference is detected relocate or adjust.
8. Make sure the exhaust is in place before tightening the clamps. Start at the front of the exhaust system and begin tightening all connections.
9. Install and adjust the **Tip** to suit. Tighten lock bolt located on the **Tip**.

**Congratulations!** You are ready to begin enjoying the improved performance and driving experience of your MBRP Inc. performance exhaust system. We hope you enjoy your purchase.