

# S6214

03-07 FORD F250/350 6.0L  
POWERSTROKE, TURBO BACK, OFF-ROAD,  
4" COOL DUALS®

**MBRP**  
INC.  
PERFORMANCE EXHAUST

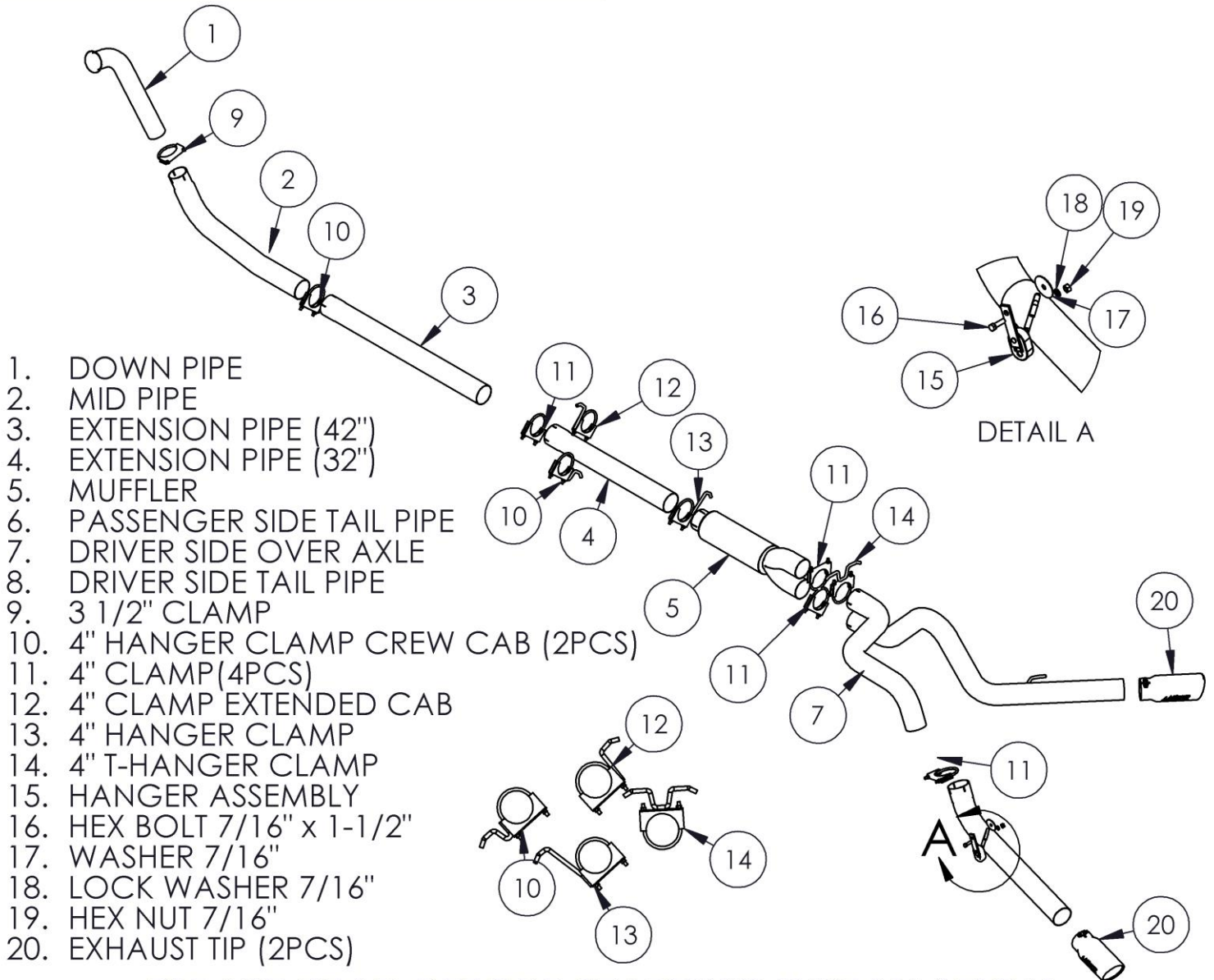

1. DOWN PIPE
2. MID PIPE
3. EXTENSION PIPE (42")
4. EXTENSION PIPE (32")
5. MUFFLER
6. PASSENGER SIDE TAIL PIPE
7. DRIVER SIDE OVER AXLE
8. DRIVER SIDE TAIL PIPE
9. 3 1/2" CLAMP
10. 4" HANGER CLAMP CREW CAB (2PCS)
11. 4" CLAMP(4PCS)
12. 4" CLAMP EXTENDED CAB
13. 4" HANGER CLAMP
14. 4" T-HANGER CLAMP
15. HANGER ASSEMBLY
16. HEX BOLT 7/16" x 1-1/2"
17. WASHER 7/16"
18. LOCK WASHER 7/16"
19. HEX NUT 7/16"
20. EXHAUST TIP (2PCS)

## PLEASE READ BEFORE STARTING INSTALLATION

**While MBRP Inc. has made every effort to ensure that all components of this system are of superior quality and properly packaged, it is the installer's responsibility to ensure the following before removal of the factory exhaust:**

- that ALL components shown above are present.
- that ALL mating components fit together.
- that there are no damaged components.
- that the system you have purchased is appropriate for your vehicle year, model and configuration.
- that the system will not interfere with any modifications previously installed or planned.
- that you have read and understand these instructions.

If you have any questions or are uncertain about any aspect of the installation of this system to your vehicle please contact your dealer before commencing installation.

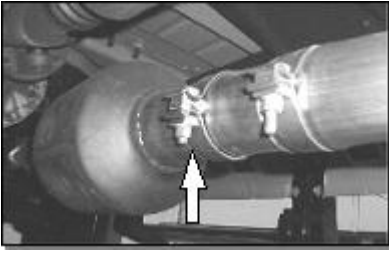

**Figure 1**



**Figure 2**

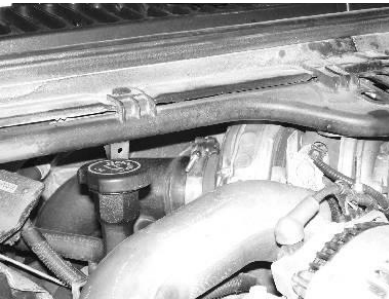

**Figure 3**



**Figure 4**

### **Removal of Stock System:**

1. Apply a penetrating lubricant liberally to all exhaust fasteners, hangers and rubber insulators.
2. Loosen the nut on the band clamp located behind the catalytic converter. **Refer to Figure 1.**
3. Remove the muffler and tail pipe from the OEM rubber hangers. To remove the system in one piece, on 03-04 models, the bottom shock bolt of the passenger side shock must be removed. **This is not required on 05 to 07 models.** Separate the stock exhaust at the slip joint located behind the catalytic converter and remove the muffler and tail pipe from under the truck. Re-install the bottom shock bolt.
4. Remove the catalytic converter by removing the two nuts holding the inlet flange together. **Refer to Figure 2.**
5. Remove the down pipe from the turbo by removing the band clamp using an 11mm socket. Retain the band clamp for the installation of the new down pipe. **Refer to Figure 3.** Cut the down pipe in front of the transmission cross member to remove. (**Note:** The stock down pipe can be removed in one piece by removing the transmission cross member. MBRP Inc. recommends that this procedure only be done by qualified, trained professionals using tools and equipment designed to safely carry out this process.)

### **Installation of MBRP Inc. Performance Exhaust:**

1. Install the **Down Pipe** in the same position as the stock down pipe and attach the flared end to the turbo using the stock band clamp. Do not fully tighten until all components are in place. **See Figure 4.**



**Figure 5**



**Figure 6**



**Figure 7**

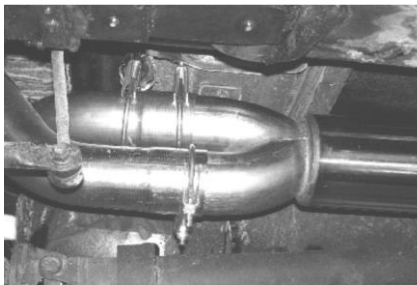

**Figure 8**



**Figure 9**

2. Attach the **Mid Pipe** to the **Down Pipe** using the **3 1/2" Clamp** to secure using the slip joint.  
**See Figure 5.**
3. Attach the **Extension Pipe (42")** to the **Mid Pipe**. For Extended Cab Short Bed vehicles this is the only **Extension Pipe** required. For Crew Cab Long Bed vehicles you will require the full length of both the **Extension Pipe (32")** and the **Extension Pipe (42")**. For Extended Cab Long Bed and Crew Cab Short Bed vehicles the **Extension Pipe (32")** will have to be cut. For the Extended Cab Long Bed vehicles attach the two extension pipes and cut the **Extension Pipe (32")** to a combined, attached length of 57 1/4". For the Crew Cab Short Bed vehicles attach the two extension pipes and cut the **Extension Pipe (32")** to a combined, attached length of 55 1/4".  
**See Figure 6.**
4. Install the **Muffler** over the **Extension Pipe**. Install the **4" Hanger Clamp** at the connection between the **Muffler** and the **Extension Pipe**.  
**See Figure 7.**
5. Position the **Muffler** outlets vertically.  
**See Figure 8.**
6. Install the **Over Axle Pipe** connecting the slip joint to the top outlet of the dual outlet **Muffler**. Do not tighten to allow for adjustment. **See Figure 9.**
7. Install the **4" T- Hanger Clamp** into the two OEM rubber hangers located above the outlets of the **Muffler**. The **4" T-Hanger Clamp** provided is used at this location to support the exhaust. It is positioned around the **Driver Side Over Axle Pipe** and is not used as a sealing clamp.



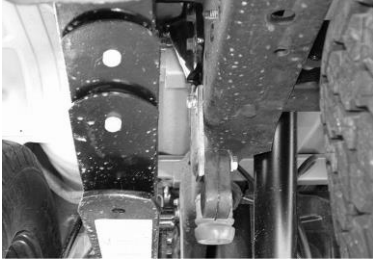

**Figure 10**

8. Connect the **Driver Side Tail Pipe** to the **Driver Side Over Axle Pipe**. Lift the **Driver Side Tail Pipe** into approximate position. **See Figure 10**. Using the factory hole located in the frame, found directly above the tail pipe hanger, attach the **Hanger Assembly** provided using the 7/16" hardware provided. **See Figure 11**. Hang the **Driver Side Tail Pipe** using the installed **Hanger Assembly**.



**Figure 11**

9. Install the **Passenger Side Tail Pipe** from the rear of the truck, over the axle and attach to the lower outlet of the **Muffler**. Install the tail pipe hanger into the OEM hanger to complete the passenger's side. **See Figure 12**.

10. Install the provided **Clamps** around the pipes where needed. Adjust the **Tail Pipes** and check along the whole length of the exhaust system to ensure that there is adequate clearance around the fuel and brake lines or any wiring. If any interference is detected relocate or adjust.

11. Make sure the complete exhaust is in place before tightening the clamps. Start at the front of the exhaust system and begin tightening all connections.

12. Install and adjust the **Exhaust Tips** to suit. Tighten the lock bolt located on each **Exhaust Tip**.



**Congratulations!** You are ready to begin experiencing the improved power, sound and driving excitement of your MBRP Inc. performance exhaust system. We know you will enjoy your purchase.