

S6000

01-05 CHEV/GMC 2500/3500 6.6L
DURAMAX, FRONT PIPE/CAT BACK,
EC/CC, 4" SINGLE SINGLE SIDE

MBRP
INC.
PERFORMANCE EXHAUST

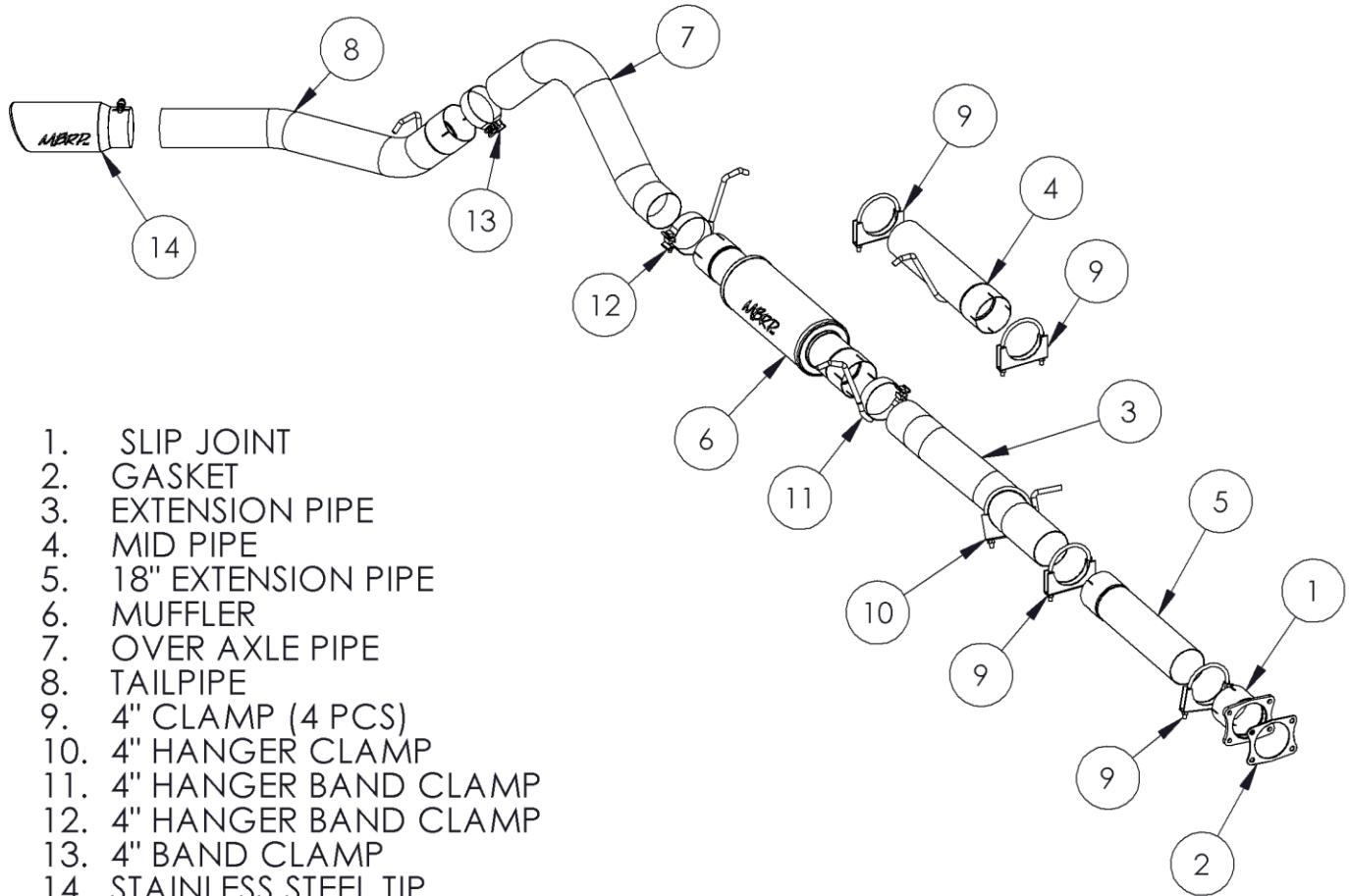

1. SLIP JOINT
2. GASKET
3. EXTENSION PIPE
4. MID PIPE
5. 18" EXTENSION PIPE
6. MUFFLER
7. OVER AXLE PIPE
8. TAILPIPE
9. 4" CLAMP (4 PCS)
10. 4" HANGER CLAMP
11. 4" HANGER BAND CLAMP
12. 4" HANGER BAND CLAMP
13. 4" BAND CLAMP
14. STAINLESS STEEL TIP.

*MUFFLER MAY NOT BE EXACTLY AS SHOWN

PLEASE READ BEFORE STARTING INSTALLATION

While MBRP Inc. has made every effort to ensure that all components of this system are of superior quality and properly packaged, it is the installer's responsibility to ensure the following before removal of the factory exhaust:

- that ALL components shown above are present.
- that ALL mating components fit together.
- that there are no damaged components.
- that the system you have purchased is appropriate for your vehicle year, model and configuration.
- that the system will not interfere with any modifications previously installed or planned.
- that you have read and understand these instructions.

If you have any questions or are uncertain about any aspect of the installation of this system to your vehicle please contact your dealer before commencing installation.

Installation Instructions

Removal of Stock System:

1. Apply a penetrating lubricant liberally to all exhaust fasteners, hangers and rubber insulators.



2. Using a 15mm socket or wrench, disconnect the factory exhaust system at the four-bolt flange located behind the catalytic converter. If the vehicle is not equipped with a catalytic converter disconnect the four-bolt flange located approximately under the passenger side seat. Refer to Figure 1. Do not discard these nuts as they are required for the installation.

Figure 1

3. Remove the exhaust system from the rubber insulators and remove from under the vehicle. If a hoist is not available for use, it may be necessary to cut the tail pipe behind the muffler for removal of the system.



Figure 2

Installation of MBRP Inc. Performance Exhaust:

1. Place the Gasket provided over the studs located on the factory four bolt flange. Attach the Slip Joint to the four-bolt flange using the existing hardware. Refer to Figure 2.
2. Install the Extension Pipe into the Slip Joint. The Extension Pipe does not require cutting to fit Crew Cab trucks. For extended cab trucks, approximately 9½" needs to be cut off the straight section of pipe.

(Installation tip: Temporarily hang the Mid Pipe and Muffler and the

Tail Pipe in place and measure to the four-bolt flange to verify the length required).



Figure 3

3. Install the Mid Pipe into the Extension Pipe placing the bend around, under the cross member. Rotate the pipe to position the bend towards the driveshaft. Refer to Figure 3.

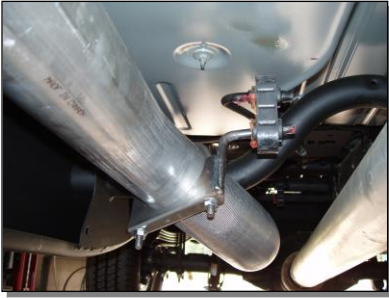

Figure 4

3. Position Mid Pipe as shown and loosely install the Hanger Clamp with the shortest hanger. Refer to Figure 4. This will support the Mid Pipe during the Muffler installation.

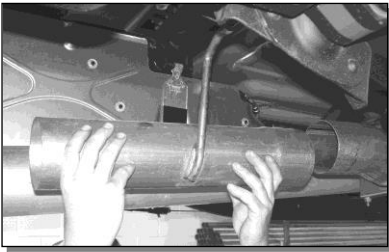

Figure 5

4. Crew cab & extended cab long bed trucks require the use of the 18" Extension Pipe provided. This is to be positioned between the Muffler and the Extension Pipe. Refer to Figure 5. The 18" Extension Pipe is not required with short box trucks.



Figure 6

5. Install the shortest Hanger Band Clamp and Muffler onto the Extension Pipe. Refer to Figure 6.



Figure 7

7. Install the Hanger Band Clamp with the longest hanger at the connection between the Muffler and the Tail Pipe and into the OEM rubber hanger at this position. Refer to Figure 7.

6. Slide the Tail Pipe and 4" Band Clamp onto the Over Axle Pipe. Install the assembly from the rear of the truck, over the axle and attach to the Muffler Outlet. Install the tail pipe hanger into the OEM hanger, adjust for best axle clearance and Tail Pipe exit location to complete. Refer to Figure 8.



Figure 8

7. Install provided clamps around pipes where needed. Adjust Tailpipe and check along the whole length of the exhaust system to ensure that there is adequate clearance around the spare tire, fuel and brake lines or any wiring. If any interference is detected relocate or adjust.
8. Make sure the exhaust is in place before tightening clamps. Start at the front of the exhaust system and begin tightening all connections.
9. Install and adjust Tip to suit. Tighten bolt located on Tip.



"PRO SERIES" exhaust shown.

Congratulations! You are ready to begin enjoying the improved performance and driving experience of your MBRP Inc. performance exhaust system. We know you will enjoy your purchase.