

S5078

07-10 CHEV/GMC 2500 HD, 6.0L,
CREW & EXTENDED CAB, 6.5' BED,
CAT BACK, 3.5" SINGLE SIDE

MBRP
INC.
PERFORMANCE EXHAUST

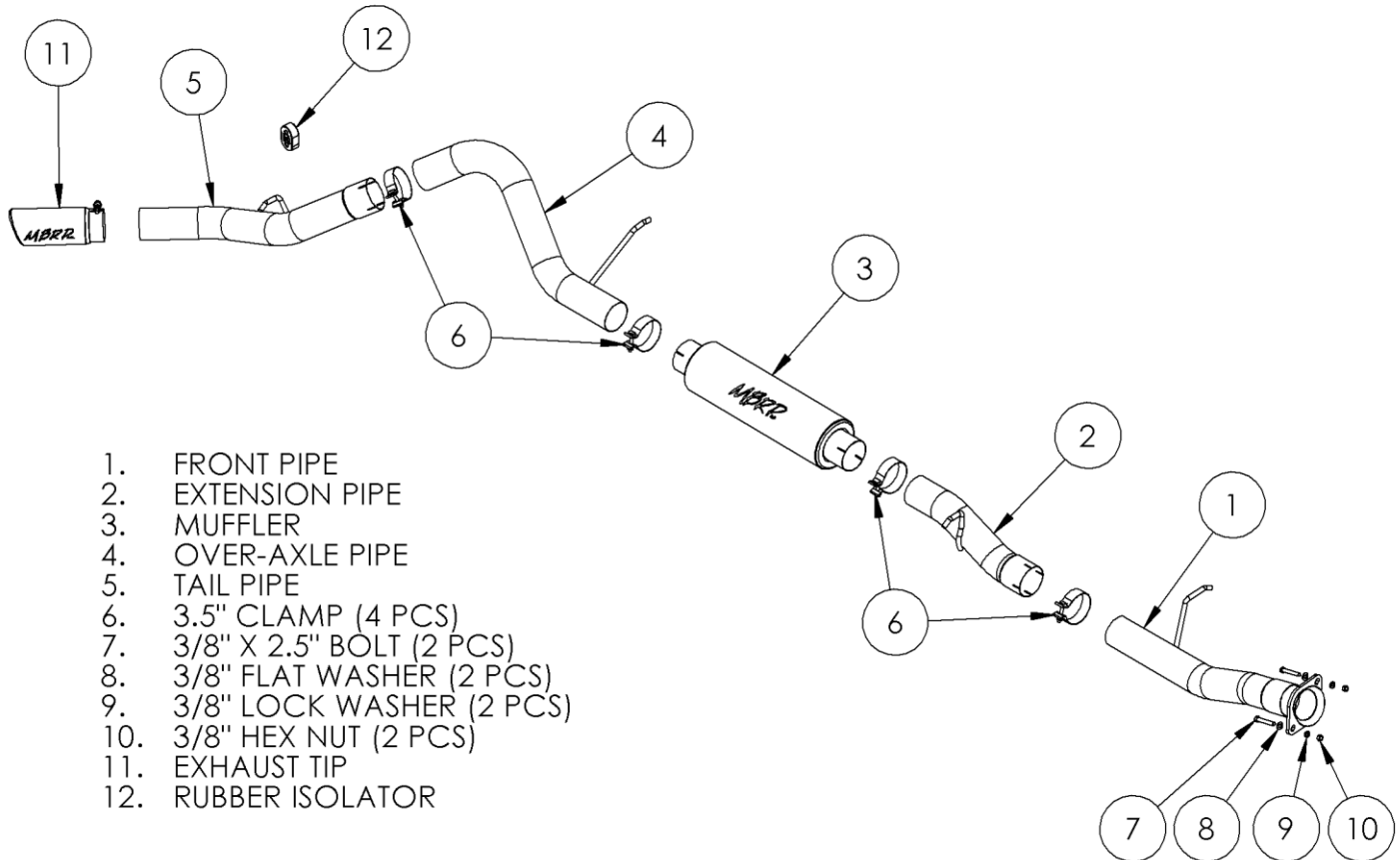

1. FRONT PIPE
2. EXTENSION PIPE
3. MUFFLER
4. OVER-AXLE PIPE
5. TAIL PIPE
6. 3.5" CLAMP (4 PCS)
7. 3/8" X 2.5" BOLT (2 PCS)
8. 3/8" FLAT WASHER (2 PCS)
9. 3/8" LOCK WASHER (2 PCS)
10. 3/8" HEX NUT (2 PCS)
11. EXHAUST TIP
12. RUBBER ISOLATOR

NOTE: Aluminized systems use saddle clamps

PLEASE READ BEFORE STARTING INSTALLATION

While MBRP Inc. has made every effort to ensure that all components of this system are of superior quality and properly packaged, it is the installer's responsibility to ensure the following before removal of the factory exhaust:

- that ALL components shown above are present.
- that ALL mating components fit together.
- that there are no damaged components.
- that the system you have purchased is appropriate for your vehicle year, model and configuration.
- that the system will not interfere with any modifications previously installed or planned.
- that you have read and understand these instructions.

If you have any questions or are uncertain about any aspect of the installation of this system to your vehicle please contact your dealer before commencing installation.

Removal of Stock System:



Figure 1



Figure 2



Figure 4



Figure 5



Figure 6

1. Apply a penetrating lubricant liberally to all hardware, hangers and rubber isolators.
2. Remove the nuts from the studs holding the front flange together and disconnect the exhaust system.
3. Remove the hangers from the rubber isolators and remove the exhaust from the vehicle. It may be easiest to cut the factory exhaust behind the muffler and remove it in two pieces.
Refer to Figure 1 and 2.
4. Remove the factory rubber tail pipe isolator.

Installation of MBRP Inc. Performance Exhaust:

Note: These systems are designed for short box trucks with a single outlet Y-pipe.
Do not fully tighten any clamps until all parts are installed and aligned.

1. The **Front Pipe** is designed to work with the crew cab short box (153" wheelbase) truck. For extended cab short box trucks (143.5" wheelbase) the **Front Pipe** will need to be shortened 9.5". This also removes the front hanger that is only used on crew cab models.
Refer to Figure 3.

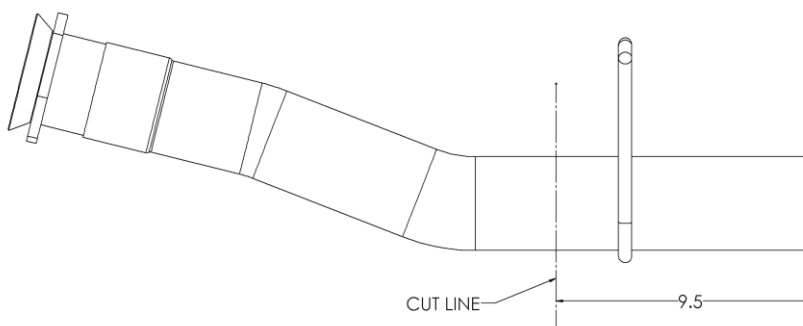

Figure 3.

2. Attach the **Front Pipe** to the factory converter flange using the supplied **Hardware**. Do not fully tighten until the rest of the exhaust is aligned. Install the front hanger into the factory isolator on crew cab models.
Refer to Figure 4.
3. Install the **Extension Pipe** onto the front pipe using a **3.5" Clamp**.
Refer to Figure 5 (Crew Cab Shown).



Figure 7

4. Install the **Extension Pipe** hanger into the factory isolator.
Refer to Figure 6.

5. Install the **Muffler** onto the **Extension Pipe** using a **3.5" Clamp**.
Refer to Figure 7.

6. Install the **Over-Axle Pipe** into the **Muffler** outlet using a **3.5" Clamp**.
Install the **Over-Axle Pipe** hanger into the factory isolator.
Refer to Figure 8.



Figure 8

7. Install the **Tail Pipe** onto the **Over-Axle Pipe** using a **3.5" Clamp**.
Install the included **Rubber Isolator** onto the **Tail Pipe** hanger then onto the
factory isolator mount.
Refer to Figure 9.

8. Install the **Exhaust Tip** and adjust to your liking.
Refer to Figure 10.

9. Once everything is aligned, completely tighten all **Clamps** and **Hardware**.

10. Check along the whole length of the exhaust system to ensure that there is
adequate clearance around the spare tire, fuel and brake lines or any wiring. If
any interference is detected relocate or adjust.



Figure 9



Figure 10



Congratulations! You are ready to begin experiencing the improved power, sound and driving experience of your **MBRP Inc.** performance exhaust system. We know you will enjoy your purchase.