



INSTALLATION INSTRUCTIONS

APPLICATION: 1997-UP JEEP WRANGLER/SE/SPORT/SAHARA

AUTOMOTIVE PRODUCTS, INC.

<p>STEP BAR ASSEMBLIES</p> <p>25-0970 25-0975</p>	
---	--

PARTS KIT CONTENTS

QTY	DESCRIPTION	TOOLS REQUIRED
1	STEP BAR ASSEMBLY, PASSENGER SIDE	3/4" SOCKET 3/4" COMBINATION WRENCH TORQUE WRENCH RATCHET
1	STEP BAR ASSEMBLY, DRIVER	
1	FRONT MOUNT BRACKET, PASSENGER	
1	FRONT MOUNT BRACKET, DRIVER	
1	REAR MOUNT BRACKET, PASSENGER	
1	REAR MOUNT BRACKET, DRIVER	
4	THREADED MOUNT PLATE	
4	1/2-13 X 2.00" HEX HEAD BOLT	
8	1/2-13 X 1.00" HEX HEAD BOLT	
12	1/2" SAE FLAT WASHER	
12	1/2" HELICAL SPLIT LOCK WASHER	

- STEP 1. Remove the contents from the box and check for any damage. Verify all parts against the parts list.
- STEP 2. Read and understand instructions completely before beginning installation.
- NOTE: Wrangler Sport models must have factory step pad removed to install this product.
- STEP 3. Insert (1) 1/2-13 x 2.00" hex head bolt, (1) 1/2" lock washer and (1) 1/2" flat washer through the step bar mount slot on each rear bracket. Install both rear mounting brackets using (2) 1/2-13 x 1.00" hex head bolts, (2) 1/2" flat washer, (2) 1/2" lock washer and (1) threaded mount plate. SEE FIGURE 1. Threaded mount plates must be placed through the underside of suspension mount with holes in frame lined up as shown. SEE FIGURE 2.
- STEP 4. Insert (1) 1/2-13 x 2.00" hex head bolt, (1) 1/2" lock washer and (1) 1/2" flat washer through the step bar mount slot on each front bracket. Install both front mounting brackets using (2) 1/2-13 x 1.00" hex head bolts, (2) 1/2" flat washer, (2) 1/2" lock washer and (1) threaded mount plate. Install threaded mount plates the same as described for rear bracket. Leave loose.
- STEP 5. Place step bar tubes up to the front and rear brackets and fasten with 1/2" hardware previously installed.
- STEP 6. Check to be sure step bar is properly aligned with Jeep body, tighten and torque mounting bracket and step bar bolts to 65 FT. LBS.

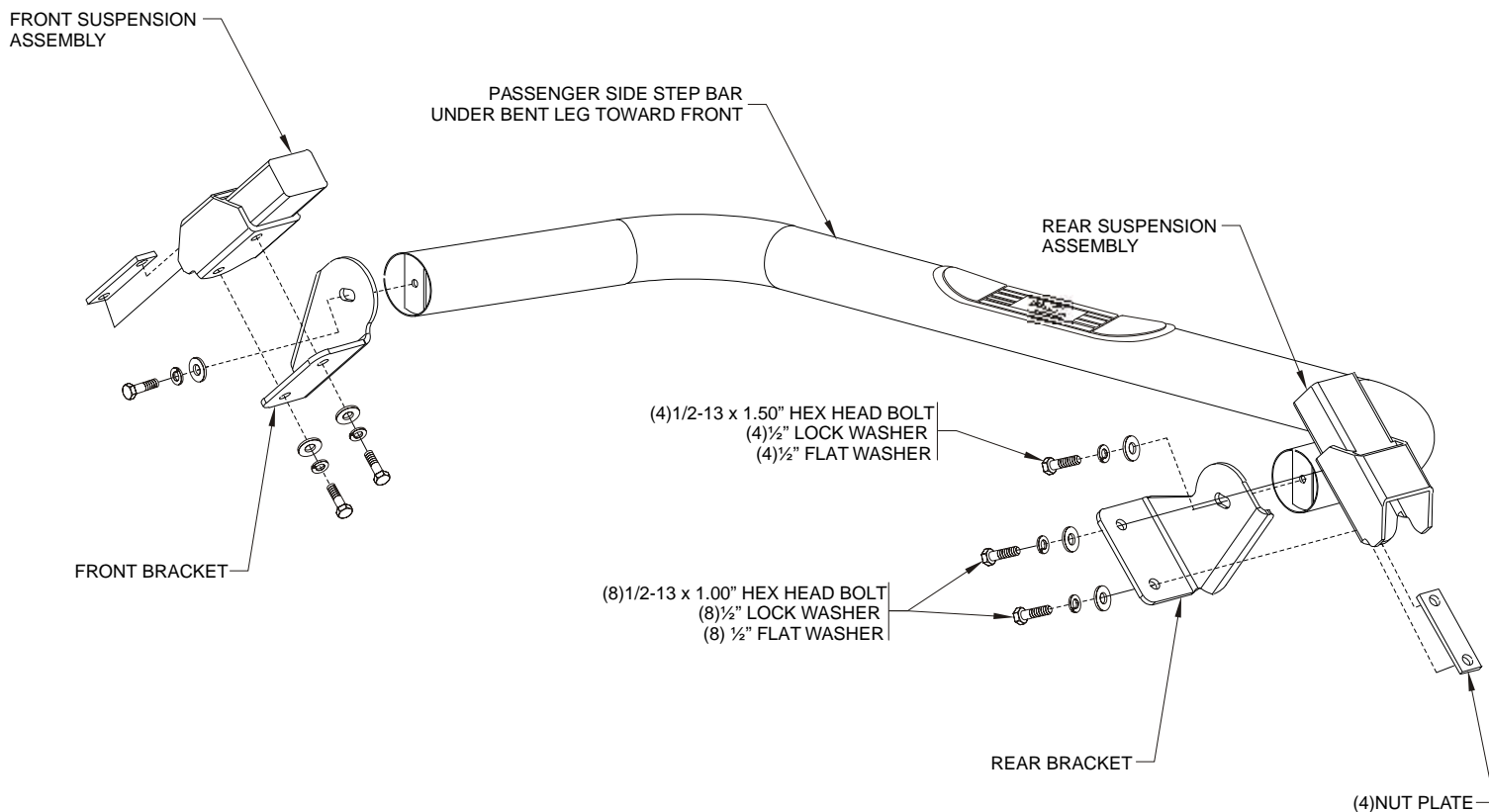

ASSEMBLY AND INSTALLATION VIEW OF PASSENGER SIDE - DRIVER SIDE OPPOSITE

Finish protection - Westin products have a high quality finish that must be cared for like any other exposed finish on the vehicle. Protect the finish with a non-abrasive automotive wax (pure carnauba, for example) on a regular basis. The use of cleaner wax or any compound which contains an abrasive is detrimental, as the compounds scratch the finish and open it to corrosion.



Westin Automotive Products, Inc.
5200 N. Irwindale Ave. Suite 220
Irwindale, Ca. 91706

Thank You for choosing Westin products
For additional installation assistance please call
Customer service (800) 793-7846 or (507) 375-3559