

INSTALLATION MANUAL

18145

Level of Difficulty

Easy

Installation difficulty levels are based on time and effort involved and may vary depending on the installer level of expertise, condition of the vehicle and proper tools and equipment.

Weight Carrying Capacity

Weight capacity 500 lbs.

Parts List

Item	Qty	Description
1	18	Lock nut, M6
2	18	Flat washer, M6
3	6	Support bracket, V-shape
4	2	Platform frame, half
5	4	Lock nut, M10
6	4	Flat washer, M10
7	8	Hex bolt, M8 x 35mm
8	1	Shank, 1-1/4"
9	4	Hex bolt, M10 x 60mm
10	18	Hex bolt, M6 x 35mm
11	2	Platform, top tubing
12	8	Lock nut, M8
13	8	Flat washer, M8
14	2	Connecting tube
15	1	Clip
16	1	Hex bolt, 1/2" -13
17	1	Flat washer, 1/2"
18	1	Star washer, 1/2"
19	1	2" adapter

Tools Required

Wrench, 19mm Adjustable wrench

Torque Specifications

M6 bolt	
M8 bolt	
M10 bolt	16 ft-lbs.

Use above torque setting unless otherwise noted

⚠ WARNING

Never exceed the vehicle manufacturer's recommended towing capacity. Do not exceed the capacity of your lowest rated towing component.

Do not exceed maximum weight capacity of 500 lbs. when using 2" receiver tube. Distribute the weight evenly on platform when hauling a load.

Do not carry loads taller, wider or deeper than the cargo carrier. Do not carry flammable items on carrier or allow exhaust fumes to blow directly on your cargo. This is a fire hazard.

Always use caution when in reverse (R) to help avoid personal injury.

Loads must be evenly distributed.

Never use as a step or platform - injury may result.

Do not use to carry flammable items or allow exhaust fumes to blow directly on items in the carrier - fire hazard.

Do not use to transport people.

Do not block brake lights or turn signals.

Product Photo



NOTICE

Visit www.curtmfg.com for a full-color copy of this instruction manual, as well as helpful videos, guides and much more!

Before you begin installation, read all instructions thoroughly.

Proper tools will improve the quality of installation and reduce the time required.

Periodic inspection of your product should be performed to ensure all hardware and / or components remain secure.

Product Registration and Warranty

CURT stands behind our products with industry-leading warranties. To get copies of the product warranties, register your purchase or provide feedback, visit: warranty.curtgroup.com/surveys

ASSEMBLY

Parts List

Item	Qty	Description
1	18	Lock nut, M6
2	18	Flat washer, M6
3	6	Support bracket, V-shape
4	2	Platform frame, half
5	4	Lock nut, M10
6	4	Flat washer, M10
7	8	Hex bolt, M8 x 35mm

Parts List

Item	Qty	Description
8	1	Shank, 1-1/4"
9	4	Hex bolt, M10 x 60mm
10	18	Hex bolt, M6 x 35mm
11	2	Platform, top tubing
12	8	Lock nut, M8
13	8	Flat washer, M8
14	2	Connecting tube

Parts List

Item	Qty	Description
15	1	Clip
16	1	Hex bolt, 1/2" -13
17	1	Flat washer, 1/2"
18	1	Star washer, 1/2"
19	1	2" adapter

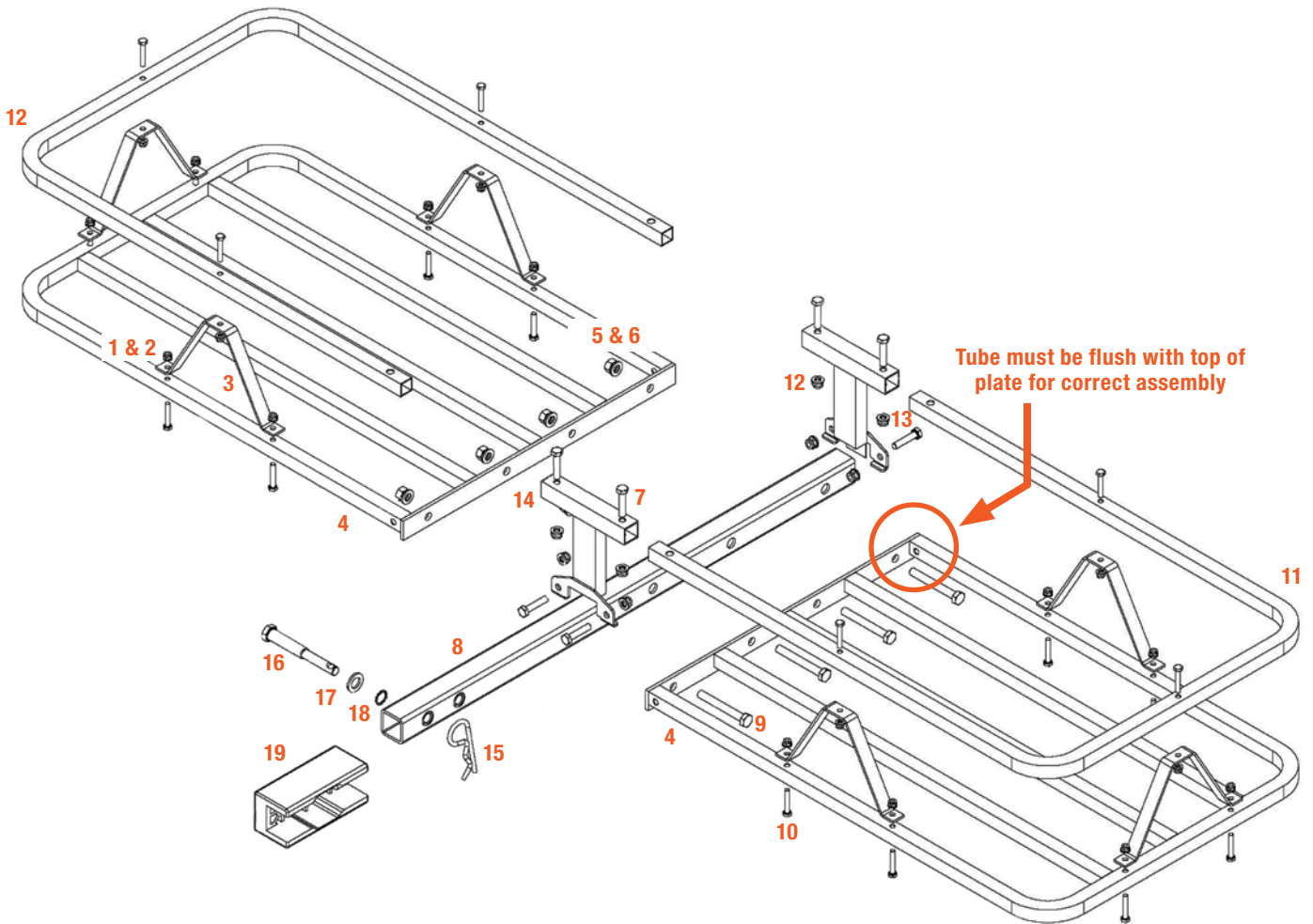

Step 1

Lay down the bottom platforms (#4). The tube must be flush with top of plate for correct assembly. Mount three support brackets (#3) on each platform half (#4) with M6 x 35mm hex head bolts (#10), M6 flat washers (#2) and M6 locknuts (#1) to 80% tightness.

Step 2

Align the holes on assembled platforms with the 1 1/4" shank (#8). Secure with M10 x 60mm hex head bolts (#9), M10 flat washers (#6) and M10 locknuts (#5) to 80% tightness.

Step 3

Mount the connection tube brackets (#14) to the bottom platforms with M8 x 35mm hex head bolts (#7), M8 flat washers (#13) and M8 locknuts (#12) to 80% tightness.

Step 4

Insert the top platform tubing (#11) into the connection tube brackets and secure to the support brackets (#3) with M6 x 35mm hex head bolts (#10), M6 flat washers (#2) and M6 locknuts (#1) to 80% tightness.

Step 5

Secure the top platform tubing to the connection tube brackets using M8*35 hex head bolts (#7), M8 flat washers (#13) and M8 locknuts (#12).

Note: The connection tube bracket with reflective tape should be located on the side facing away from the vehicle. The one without tape should be located on the shank side.

Fully tighten all bolts and locknuts.

Step 6

Insert the cargo carrier shank into the vehicle's receiver tube. Secure with 1/2" hex head bolt (#16), flat washer (#17), lock washer (#18) and clip (#15).

Step 7

To adapt the 1 1/4" shank to a 2" shank, assemble the adapter (#19) onto the 1 1/4" shank (#8). Align the holes and secure with 1/2" hex head bolt (#16), flat washer (#17), lock washer (#18) and clip (#15).

TOWING BASICS & SAFETY INFORMATION

For information on safely towing your trailer, visit curtmfg.com/understanding-towing.
