



INSTALLATION MANUAL

RAPID FLOW

Cold Air Intake



Applications

GM Duramax 6.6L LML
Stage 2 RFI '13-'15

RFI Part Number

53108

Not legal for sale or use in California on pollution-controlled vehicles.



POWER



ECONOMY

Introduction

This manual provides step-by-step installation instructions for the Bully Dog Rapid Flow Induction (RFI) Cold Air Intake for the GM Duramax Diesel 6.6L LML '15+ engines. Installation requires a few basic tools and takes about 20 minutes.

Table of Contents

<i>Parts and Tools</i>	1-4
<i>Installation</i>	4-14
<i>Maintenance</i>	14-16

Parts Included

<i>RFI Enclosure Lid</i>	(53102-1)
<i>RFI Enclosure Base</i>	(53102-2)
<i>Air Intake Tube with MAF Mount</i>	(53103-3)
<i>Stage 2 Air Intake Tube</i>	(53108-3)
<i>Silicone Coupler – Straight</i>	(53104-11)
<i>Silicone Coupler – Hump</i>	(53104-12)
<i>5" Worm Drive Band Clamps (2)</i>	(51104-7)
<i>5.5" Worm Drive Band Clamps (2)</i>	(52102-94)
<i>Air Filter with Band Clamp</i>	(224800)
<i>Black Oxide Phillips Screws 1/2" (2)</i>	(51103-94)
<i>Black Oxide Phillips Screws 3/8" (2)</i>	(54100-94)
<i>T20 Security Torx® Bit</i>	(229120)
<i>Nylon Washers (6)</i>	(51201-94)
<i>MAF Replacement O-ring</i>	(53103-94)
<i>M6 Flanged Bolts (3)</i>	(53254-98)

Tools Needed

- Flat-head screwdriver
- Phillips screwdriver
- Bit driver
- 10 mm socket and wrench

Parts Description

RFI Enclosure Lid

The easy-to-remove lid allows for hassle-free filter maintenance. Heavy duty latches ensure that the lid creates a good seal with the enclosure base and that the latches close securely.



RFI Enclosure Base

There are four enclosure features to note to ensure a smooth installation: (1) the foam secured to the inlet of the box which allows it to seal tightly to the side of the truck, (2) the round hole on the bottom of the box which allows for drainage and even more cool airflow from the wheel well, (3) the mounting pegs that are located on the bottom of the enclosure and used to secure the enclosure base to the OEM mounting plate in the engine bay, and (4) the circular hole on the back of the enclosure where the intake tube will be attached.



Air Intake Tube with MAF Mount

The air intake tube comes with a precision-made mass air flow sensor mount with inset screw mounts. The tube is designed with a snap-fit feature that will secure it to the RFI base.



Stage 2 Air Intake Tube

Designed to fit in your engine bay, the stage 2 air intake tube improves air flow into the turbo through the smoothest curves possible to prevent any loss of power and provide sleek style under the hood.



Silicone Coupler

These high quality 3-ply couplers are durable, flexible and strong.



Band Clamps

Adjustable clamps connect and hold all tubing in place.



Air Filter & Band Clamp

The Rapid Flow Induction Cold Air Intake system includes an ISO 5011 certified eight-layer oil filter. The air filter is housed within the intake enclosure and secured onto the end of the air intake tube using the included filter clamp and a flat-head screwdriver.



Black Oxide Pan Head Screws

Bully Dog provides screws to secure the MAF sensor to the air intake tube.



T20 Security Torx® Bit

The mass air flow sensor is attached to the stock intake tube using tamper resistant pin-in-Torx® screws. Bully Dog includes a Torx® bit for convenience. If the bit is lost it can be purchased at any auto parts store.



Nylon Washer

These nylon washers protect the mass airflow sensor and prevent it from being bent when it is attached to the air intake tube.



MAF Replacement O-Ring

Meant to replace the orange O-Ring beneath the stock MAF sensor, this ring ensures a tight seal between the MAF sensor and the Bully Dog intake tube.



Installation

Installation is very simple, and can be separated into three parts: Removing the Stock Intake, Preparing the Bully Dog RFI Intake and Installing the Bully Dog RFI Intake. The complete installation of the RFI Cold Air Intake system should take about 20 minutes. The assembly diagram below shows how the parts of the intake fit together in sequence.

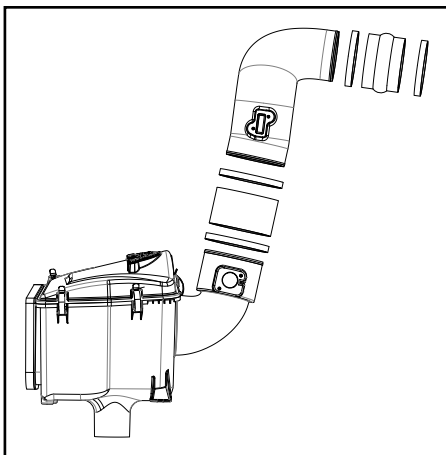

Removing the Stock Intake



1. IMPORTANT

Before beginning installation, disconnect your battery at the negative terminal. Failure to disconnect the battery could result in personal injury and/or damage to your vehicle.

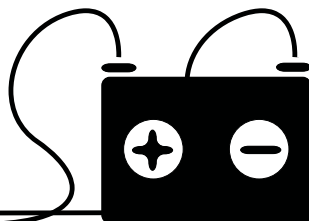

2. Release the locking tab and unplug mass air flow sensor.



3. Release the locking tab and unplug temperature sensor which is located on the backside of the box.



4. Use a flat-head screwdriver to loosen the band clamps located at each end of the stock intake tube. You do not need to completely disconnect the clamps, just loosen them enough to remove the tube.



5. Remove the stock intake tube.



6. Remove the OEM intake box. The OEM box is held in place by rubber grommets, so it will easily pop out if you gently pull upward.



7. Use a 10 mm socket to remove all four machine screws from the mounting plate and remove the mounting plate.



Preparing the RFI Intake

1. Snap the Bully Dog air intake tube with MAF mount into the Bully Dog RFI enclosure base.



2. Use the T20 Torx bit to remove the MAF sensor from the OEM intake tube.



3. Swap the OEM MAF O-ring for the Bully Dog O-ring.



4. Attach the MAF sensor to the Bully Dog intake tube. Use the nylon washers and the black oxide Phillips screws provided by Bully Dog. Use two washers on each side.



IMPORTANT: Do not overtighten the screws, as this could damage the MAF sensor.

5. Use the T20 Torx bit to remove the temperature sensor from the OEM box.



6. Attach temperature sensor to the Bully Dog Stage 2 intake tube. Use the nylon washers and the black oxide Phillips screws provided by Bully Dog. Use one washer on each side.



7. Connect the silicone couplers to the stage 2 air intake tube. Do not tighten the band clamps. Leave them loose so you can adjust the couplers into the correct position.



Installing the RFI Intake

1. Mount the RFI Enclosure Base in the space made by removing the stock intake. Use the three provided M6 flange bolts. Failure to use the bolts provided by Bully Dog could result in damage to the RFI.



2. Connect the stage 2 air intake tube to the Bully Dog air intake tube (with MAF mount) and the turbo inlet tube in the engine bay. Leave the band clamps loose until you are sure that all of the connections are properly aligned, and then tighten the clamps with a flat-head screwdriver.



3. Install the air filter by connecting it to the air intake tube inside the enclosure and tightening the band clamp with a flat-head screwdriver.



4. Install the RFI enclosure lid. Make sure that the lid is properly aligned. Snap the four latches over the mounts on the lid, firmly securing it to the enclosure base.



5. Reconnect the MAF and temperature sensor plug and the battery. Start the vehicle, listen for leaks and check all connections. Go for a ride and enjoy!



Filter Maintenance

The intake system should be cleaned with the Bully Dog RFI Cleaning Kit at least once every three months; in dusty climates, the filter should be cleaned more often. Maintaining the intake is a two part process: cleaning and then oiling the filter.

Cleaning the Filter

1. Remove the filter from the RFI enclosure. Clean the enclosure if necessary.
2. Remove surface dirt (this step can be avoided if a Bully Dog RFI Prefilter has been installed).
 - Lightly tap the filter.
 - Use a soft-bristle brush to remove any loose particles.
3. Spray the cleaner generously over the filter and let it soak for 10 minutes.
4. Thoroughly rinse the filter.
 - Use regular tap water.
 - Avoid high-pressure hoses.
 - Prevent dirt from entering the filter by rinsing from inside out or from the clean side to the dirty side.
5. Let the filter air dry.
 - Do not use any method to speed up the drying process.
 - Using a blow dryer or compressed air can disfigure the filter and allow particles to pass through.



Oiling the Filter

1. Apply a small amount of oil to the soft-bristle brush and gently spread the oil over the filter. Be sure to apply only a small amount of force so the filter is not damaged.

2. Continue applying the oil to the filter until the entire filter is covered in an even amount of oil. Apply enough oil to make the filter a solid and uniform blue, but do not go beyond that.
3. Allow the oiled filter to sit 20 minutes. Re-oil any dry spots that appear. Do not oil the filter excessively. Excessive oiling can cause damage to intake sensors.

Prefilter

The Bully Dog RFI Prefilter is a semi-water-repellent barrier that will keep bugs and debris out while lengthening the time between filter cleanings and reducing the amount of time you spend cleaning the filter.



Notes

Notes

Check out more of our **ADRENALIN PUMPING** products!

Triple Dog GT



Pre Filter



Cleaning Kits



Clothing



GT Diesel is not legal for sale or use in California on pollution-controlled vehicles.



Free Technical Support at: 1-940-783-9915

See More at: bullydog.com