



Equipped with AEM® Dryflow™ Filter  
No Oil Required!

## INSTALLATION INSTRUCTIONS

### PART NUMBER: 21-8202

---

2002	DODGE	Ram 2500 Pickup	V8-5.9L	SEE * NOTE
1994-2001	DODGE	Ram 1500 / 2500 Pickup	V8-5.9L	C.A.R.B. E.O. # D-670
1994-2001	DODGE	Ram 1500 Pickup	V8-5.2L	C.A.R.B. E.O. # D-670

---

\* **NOTE:** Legal in California only for racing vehicles which may never be used upon a highway

## PARTS LIST

Description	Qty.	Part Number
Air Filter Assy. 4.00 X 9" Dry Ele.	1	21-2059DK
Inlet Pipe	1	2-82021
Heat Shield	1	20-8202
Hose, Silicone 4.00x2" Black	1	5-402
Hose; 1/2"ID X 18"L	1	5-5018
Edge Trim, 34"	1	8-4034
Plenum	1	9-8202
Mount, Rubber 1" X 6mm	1	1228599
Spacer, 1.00 OD .348 ID X .625	1	2-664
Rubber Edge Trim 25"	1	8-3025
Bolt, Hex M8-1.25 X 40mm	1	1-2019
Bolt, Hex M6 X 1.0 X 16mm	1	1-2030
Washer, M6 X 12mm OD Zinc	1	1-3018
Washer, 8mm Soft Mount	1	559960
Washer, 6mm Soft Mount	3	08160
Nut, M6 Hex Serrated	3	444.460.04
1/2" Bnd. Hose Clamp, 3.56"-4.50"	3	9464
Hose Clamp, 1"	2	99024.032

Read and understand these instructions **BEFORE** attempting to install this product. Failure to follow installation instructions and not using the provided hardware may damage the intake tube, throttle body and engine.

### 1. Preparing Vehicle

- a. Make sure vehicle is parked on level surface.
- b. Set parking brake.
- c. If engine has run in the past two hours, let it cool down.
- d. Disconnect negative battery terminal.
- e. Do not discard stock components after removal of the factory system.

### 2. Removal of stock system



a. Release the air intake tube from the air filter housing by pulling straight back.



b. Remove the other end of the air intake tube from the inner fender by pulling away while squeezing from the top and bottom.



c. Remove the crankcase breather hose from the air filter housing. If the hose is on the passenger side of the air box, the hose may be left connected to the valve cover and will be reused with the AEM® intake system. If the hose is on the driver's side of the air box, remove the entire hose from the engine bay.



d. Loosen the hose clamp holding the air filter housing to the throttle body. Remove the air filter housing.

**NOTE: It may be necessary to remove the clamp completely to free the air filter housing. Use care to avoid damaging the clamp, it will be reused in the installation of the AEM® intake system.**

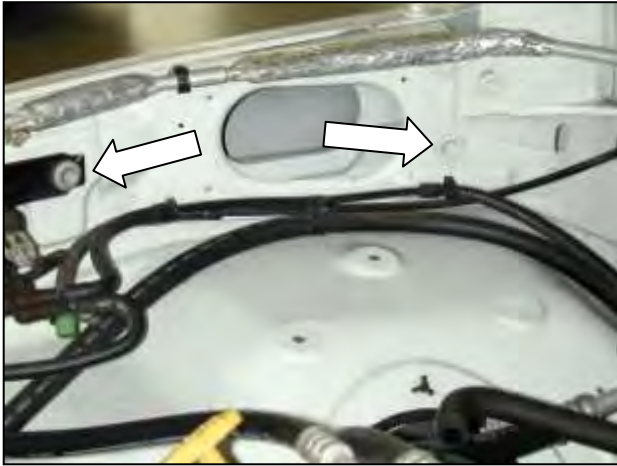

e. Remove the two bolts shown in the picture above. On 1996 and earlier trucks, the bolt on the left will not need to be removed. There will be an unused tapped hole in the fender.

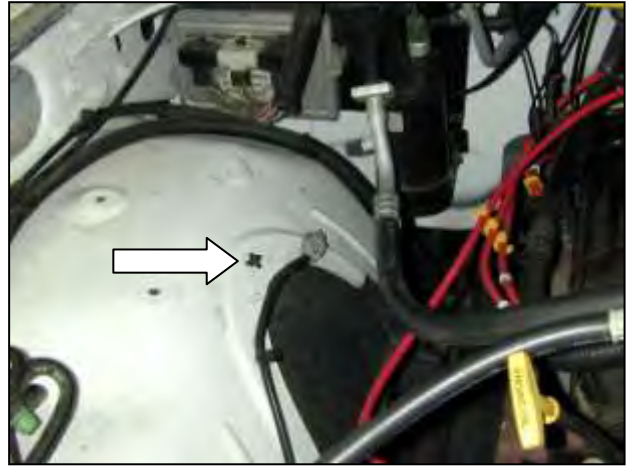

f. Remove the plastic rivet that secures the plastic fender liner to the inner fender. Push the center of the rivet through from the tire side of the fender.

### 3. Installation of AEM® intake system.

a. When installing the intake system, do not completely tighten the hose clamps or mounting hardware until instructed to do so.

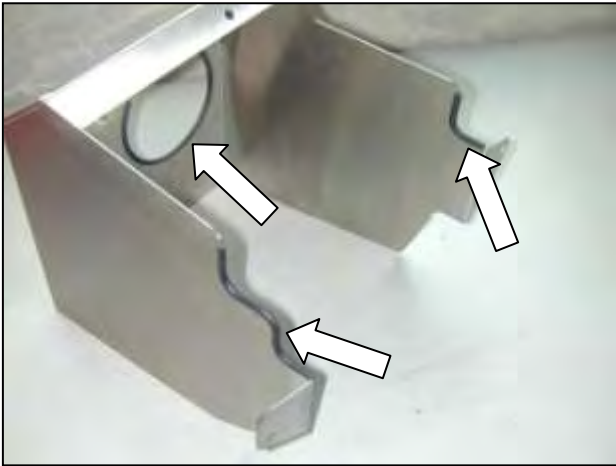

b. Install the rubber edge trim to the three edges of the heat shield shown in the picture above. Trim the length to fit.



c. Install the foam rubber gasket material to the top edge of the heat shield as shown in the picture above. Trim the length to fit.



d. Install the heat shield into the engine bay. Secure the front mounting tab using the bolt removed in step 2e.

**NOTE: 1996 and earlier trucks are not equipped with the evaporative emissions control assembly shown in this picture. For these trucks, use the supplied M8 bolt, washer, and spacer to secure the heat shield as shown in the diagram below.**

**Diagram: For trucks NOT equipped with the evaporative emissions control assembly, secure the front mounting tab with the provided hardware as shown.**

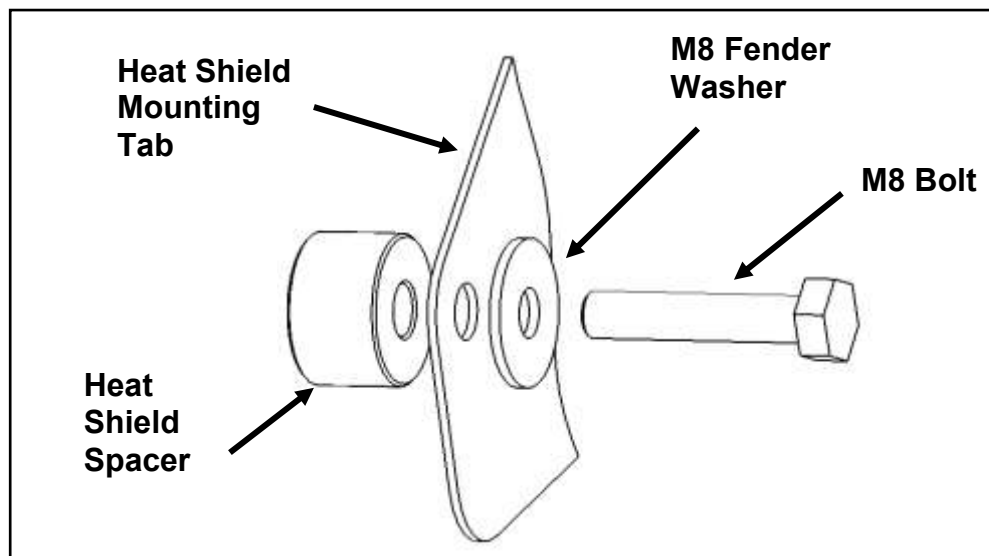

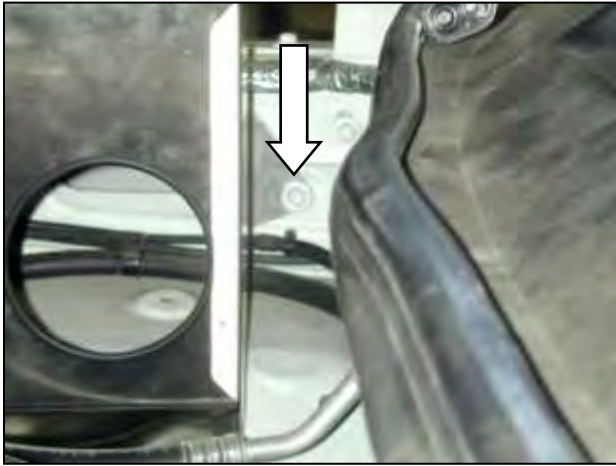

e. Secure the rear heat shield mounting tab using the other bolt removed in step 2e.



f. Secure the third heat shield mounting point using the supplied M6 bolt, washer, fender washer, and locknut. Install the bolt and small washer through from the tire side of the fender. Secure with the larger fender washer and locknut from the engine bay side.

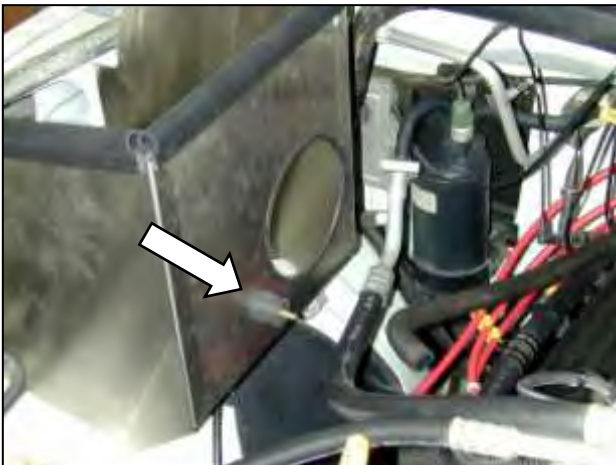

g. Install the supplied rubber mount in to the side of the heat shield. Secure the rubber mount with a supplied M6 fender washer and locknut.



h. Install the silicone hose coupler to the AEM® intake plenum using the #64 hose clamps. Do not tighten the hose clamps.



i. Secure the AEM® intake plenum to the throttle body using the original clamp and gasket. Do not tighten the clamp completely to allow for rotation and adjustment of the intake pipe during installation.



j. Install the AEM® inlet pipe. The mounting bracket should line up with the rubber mount on the heat shield.



k. Install the AEM® air filter onto the end of the inlet pipe. Push the air filter onto the inlet pipe up to the stop molded in to the air filter neck.



l. Secure the inlet pipe bracket to the rubber mount using the remaining M6 fender washer and locknut. Refer to the diagram below for proper rubber mount installation.

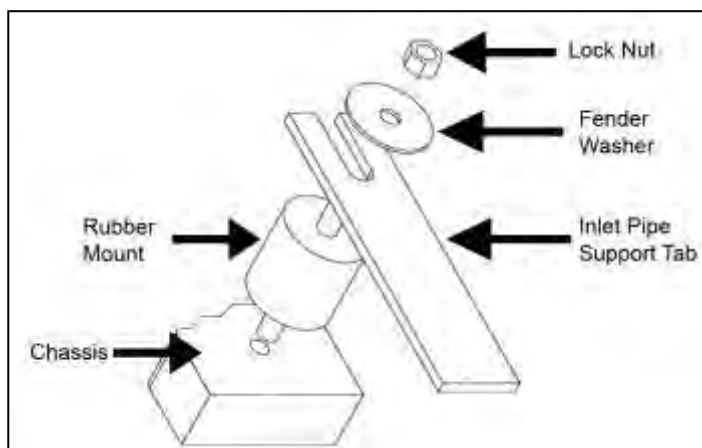



m. If the breather hose was originally on the passenger side of the air box, attach the stock crankcase breather hose to the nipple on the backside of the AEM<sup>®</sup> inlet pipe and secure with the supplied 1" hose clamp. If breather hose was originally on the driver's side, install supplied length of 1/2" hose between valve cover and breather nipple on AEM<sup>®</sup> inlet pipe and secure with the two supplied hose clamps.



Factory air box system installed



AEM<sup>®</sup> intake system installed

#### 4. Reassemble Vehicle

- Position the filter for best fitment. Position the inlet pipes for the best fitment. Be sure that the pipes or any other components do not contact any part of the vehicle. Tighten the rubber mount, all bolts, and hose clamps.
- Check for proper hood clearance. Re-adjust pipes if necessary and re-tighten them.
- Inspect the engine bay for any loose tools and check that all fasteners that were moved or removed are properly tightened.
- Reconnect negative battery terminals and start engine. Let the vehicle idle for 3 minutes. Perform a final inspection before driving the vehicle.



## 5. CARB Sticker Placement

- a. The C.A.R.B. exemption sticker, (attached), must be visible under the hood so that an emissions inspector can see it when the vehicle is required to be tested for emissions. California requires testing every two years, other states may vary.

## 6. Service and Maintenance

- a. It is recommended that you service your AEM<sup>®</sup> Dryflow™ filter every 20,000 miles for optimum performance. Use AEM Dryflow cleaning kit part # 21-110.
- b. Use aluminum polish to clean your polished AEM<sup>®</sup> intake tube.
- c. Use window cleaner to clean your powder coated AEM<sup>®</sup> intake tube. **(NOTE: DO NOT USE aluminum polish on powder coated AEM intake tubes).**

For technical inquiries e-mail us at sales@aemintakes.com or call us at 800.992.3000
---

## AEM Air Intake System Warranty Policy

AEM<sup>®</sup> warrants that its intake systems will last for the life of your vehicle. AEM will not honor this warranty due to mechanical damage (i.e. improper installation or fitment), damage from misuse, accidents or flying debris. AEM will not warrant its powder coating if the finish has been cleaned with a hydrocarbon-based solvent. The powder coating should only be cleaned with a mild soap and water solution. Proof of purchase of both the vehicle and AEM intake system is required for redemption of a warranty claim.

This warranty is limited to the repair or replacement of the AEM part. In no event shall this warranty exceed the original purchase price of the AEM part nor shall AEM be responsible for special, incidental or consequential damages or cost incurred due to the failure of this product. Warranty claims to AEM must be transportation prepaid and accompanied with dated proof of purchase. This warranty applies only to the original purchaser of product and is nontransferable. Improper use or installation, use for racing, accident, abuse, unauthorized repairs or alterations voids this warranty. AEM disclaims any liability for consequential damages due to breach of any written or implied warranty on all products manufactured by AEM. Warranty returns will only be accepted by AEM when accompanied by a valid Return Merchandise Authorization (RMA) number. Credit for defective products will be issued pending inspection. Product must be received by AEM within 30 days of the date RMA is issued.

If you have a warranty issue, please call (800) 992-3000 and our customer service department will assist you. A proof of purchase is required for all AEM warranty claims.