



# TYPHOON INTAKE SYSTEMS

## INSTALLATION INSTRUCTIONS

### 69-8754

### TOYOTA

### 2002-2007 Corolla

### 1.6L VVTi 16v 110bhp

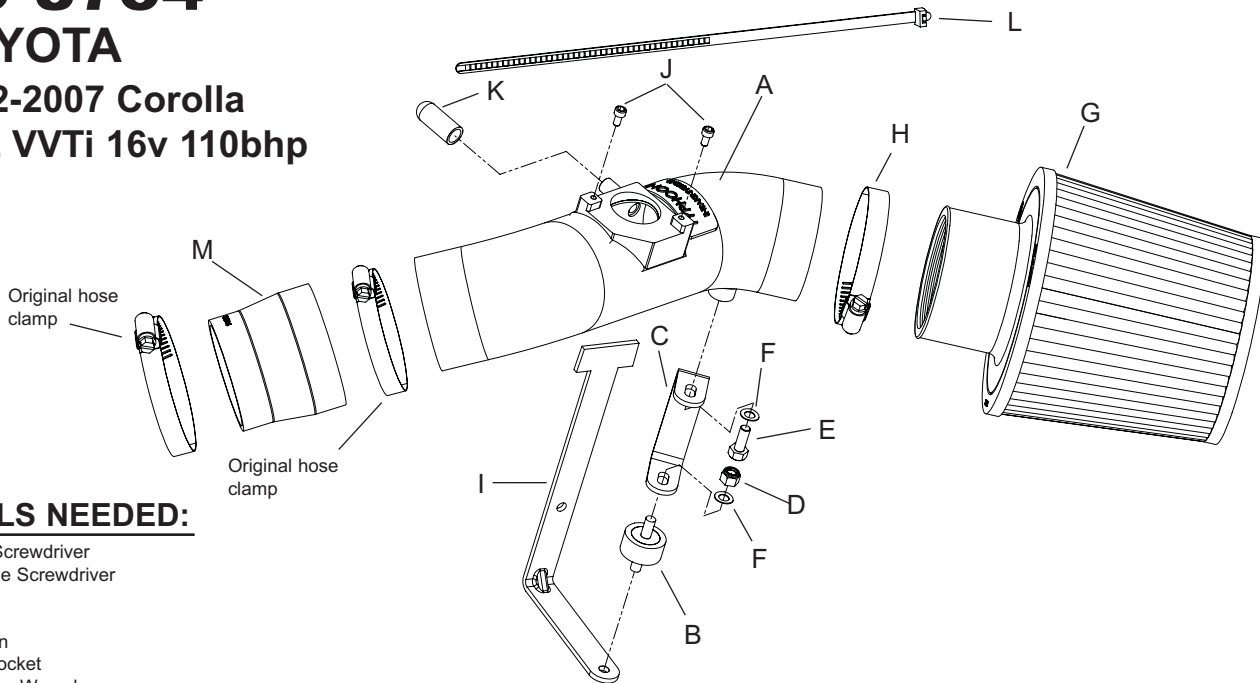

### PARTS LIST:

Description	Qty	Part #
A Typhoon Intake Tube	1	27111
B 6mm Rubber Mounted Stud	1	07027
C Bracket "C"	1	070052
D 6mm Nylock Nut	1	07512
E Hex Bolt, 6mm x 16mm L.	1	07812
F 6mm Wave Washer	2	08277
G Air Filter	1	KRU4960
H Hose Clamp, #44	1	08577
I Bracket "L"	1	020009
J Cap Screw, 4mm x 8mm L.	2	07733
K Rubber Cap Plug	1	08214
L Plastic Cable Tie	1	21590
M Silicone hose	1	084016

### TOOLS NEEDED:

- Phillips Screwdriver
- Flat Blade Screwdriver
- Pliers
- Ratchet
- Extension
- 10mm Socket
- 3mm Allen Wrench

### TO START:

1. Turn the ignition OFF and disconnect the vehicle's negative battery cable.

**NOTE: FAILURE TO FOLLOW INSTALLATION INSTRUCTIONS AND NOT USING THE PROVIDED HARDWARE MAY DAMAGE THE INTAKE TUBE, THROTTLE BODY AND ENGINE.**



2. Disconnect the mass air sensor (MAS) electrical connection as shown.



3. Remove the throttle cable from the air box as shown.



4. Remove the intake tube from the throttle body and the air box. The hose clamps are being used later on.



5. Remove the PWM vacuum switching valve from the air box lid.



6. Remove the air box lid from the vehicle as shown.

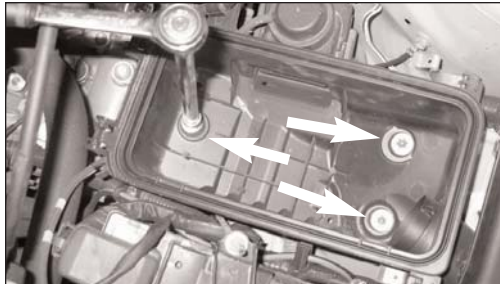

7. Loosen and remove the three bolts that secure the air box base to the vehicle as shown.

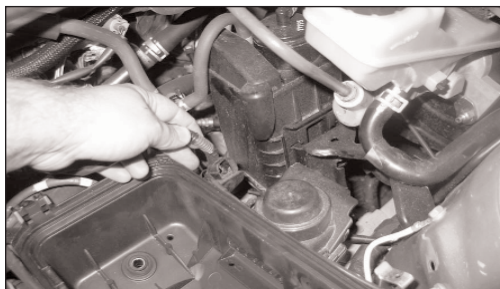

8. Unclip the wire harness from the air box base as shown.



9. Remove the air box base from the vehicle as shown.

**NOTE: K&N recommends that customers do not discard factory air intake.**

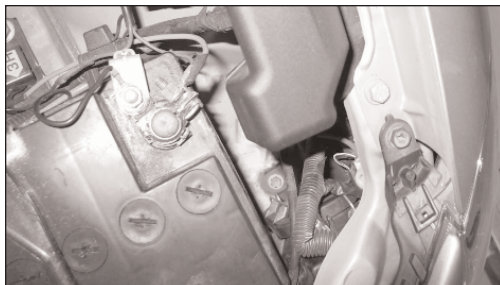

10. Loosen and remove the bolt that secures the air inlet duct to the inner fender as shown.



11. Remove the air inlet duct from the vehicle as shown.



12. Fit the "L" bracket to the original air box mount using the rubber mounted stud as shown.



13. Fit the "C" bracket to the rubber mounted stud using a waved washer and nylock nut supplied, but do not tighten completely.

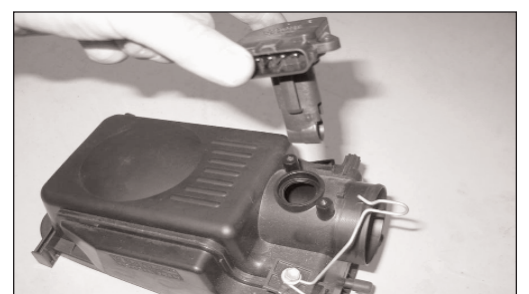

14. Remove the screws from the MAS, then, remove the MAS from the air box as shown.



15. Clean the inside of the tube out with water and a towel as shown.

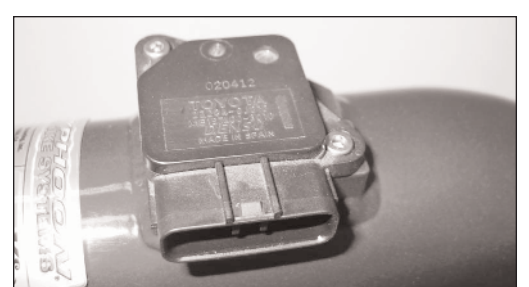

16. Install the MAS into the intake tube using the provided hardware.



17. Fit the rubber cap plug over the vent of the Typhoon intake tube as shown.



18. Fit the stepped silicone sleeve on the tube using the original hose clamp removed earlier.



19. Fit the Typhoon tube onto the throttle body, using the original hose clamp removed earlier but don't fully tighten the hose clamp yet!



20. Align the tube with the "C" bracket and secure with the M6 bolt and wave washer supplied. Don't fully tighten yet!



21. Slide the PWM vacuum switching valve onto the "L" bracket as shown.

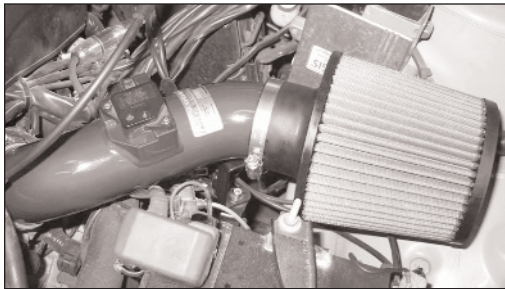

22. Install the Air Filter onto the Typhoon tube and secure with the provided hose clamp as shown.

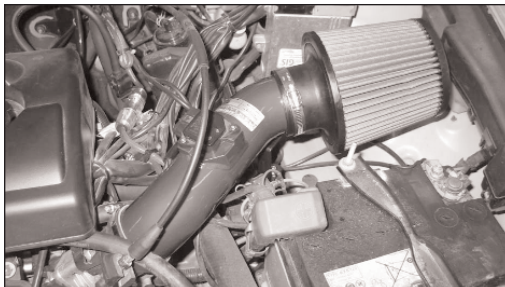

23. Adjust the filter assembly for clearance, then, firmly tighten all hose clamps and hardware connections!



24. Re-connect the MAS electrical connection as shown.

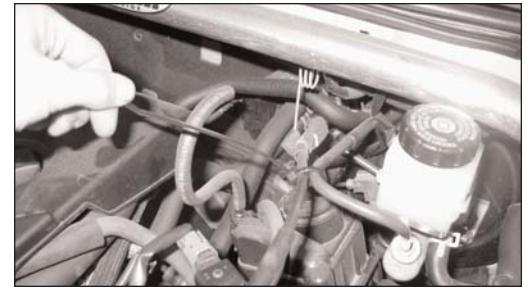

25. Secure the throttle cable to the brake line using the cable tie supplied.

**NOTE: Do not fully tighten the cable tie, allow a little slack for the throttle cable!**



26. Re-connect the negative battery cable and double check that everything is tight and properly positioned before starting the vehicle.



27. It will be necessary for all Typhoons to be checked periodically for realignment, clearance and tightening of all connections. Failure to follow the above instructions or proper maintenance may void warranty.

#### ROAD TESTING:

1. Start the engine with the transmission in neutral or park, and the parking brake engaged. Listen for air leaks or odd noises. For air leaks secure hoses and connections. For odd noises, find cause and repair before proceeding. This kit will function identically to the factory system except for being louder and much more responsive.
2. Test drive the vehicle. Listen for odd noises or rattles and fix as necessary.
3. If road test is fine, you can now enjoy the added power and performance from your kit.
4. K&N suggests checking the air filter element periodically for excessive dirt build-up. When the element becomes covered in dirt (or once a year), service it according to the instructions on the Recharger service kit, part number 99-5003EU.