



TYPHOON INTAKE SYSTEMS



INSTALLATION INSTRUCTIONS

69-7062
NISSAN
2007-11 Altima
V6-3.5L

NOTE: C.A.R.B. E.O. # D-269-37 APPLIES ONLY TO 2007-10 MODEL YEAR VEHICLES

TOOLS NEEDED:

3mm Allen Wrench
5mm Allen Wrench
10mm Socket
10mm Wrench
Extension
Flat Blade Screwdriver
Pliers
Phillips Screwdriver
Ratchet

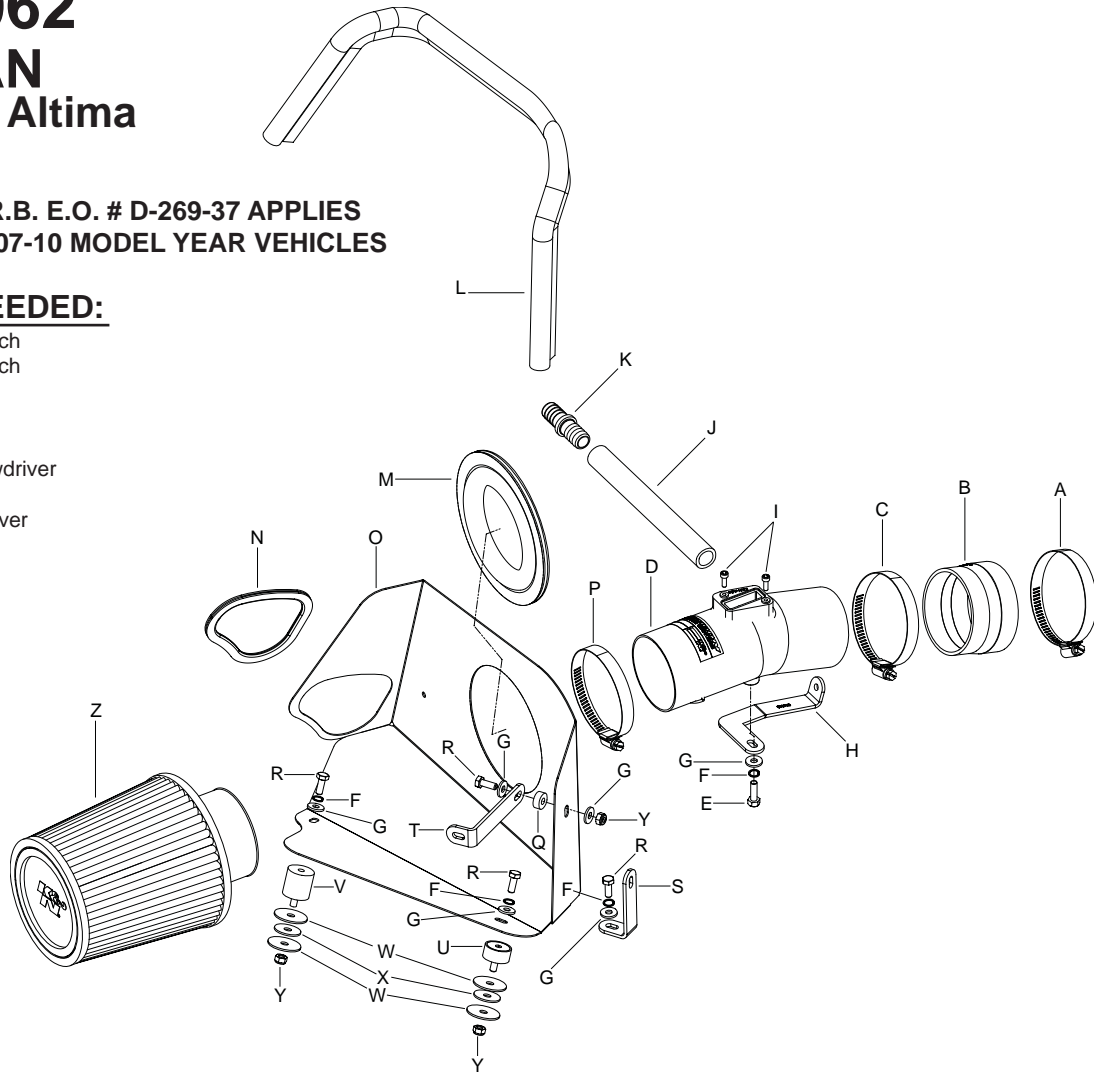

PARTS LIST:

Description	Qty.	Part #
A Hose Clamp #48	1	08601
B Hose; 3"ID - 3-1/8"ID x 2"L,	1	084031
C Hose Clamp #44	1	08560
D Intake Tube	1	27559
E Bolt; M6x1.00"x20MM Hex, SS	1	07795
F Washer; 1/4" Lock, ZN	4	08198
G Washer; 1/4"ID x 5/8"OD	6	08275
H Bracket; "L", STL	1	070113
I Bolt; M4-0.07 8MM, A/H Cap	2	07733
J Hose; 5/8"ID x 7-1/2"L	1	084008
K Vent; Strt., 5/8"	1	08048
L Edge Trim (26")	1	102488
M Edge Trim (17")	1	102469
N Edge Trim (14")	1	8-3014
O Heat Shield	1	074051
P Hose Clamp #52	1	08610
Q Spacer;.625"ODx.250"IDx.250"L	1	06555
R Bolt; 6MM-1.00x16MM, SS	4	07812
S Bracket; SM "L" Mild STL	1	07195
T Bracket; "L" Short, STL	1	010040
U Stud;M/F, 1/2"Lx1"W, M6x1.00	1	070228
V Stud;M6x1, 1" T, M/F	1	02033
W Washer; 1.25Dx 28 Hol. ZN	4	08151
X Washer; 1"x.300x.100 Rubber	2	21685
Y Nut; 6MM Nylock, Hexhead, SS	3	07512
Z Air Filter	1	RU-4990

NOTE: FAILURE TO FOLLOW INSTALLATION INSTRUCTIONS AND NOT USING THE PROVIDED HARDWARE MAY DAMAGE THE INTAKE TUBE, THROTTLE BODY AND ENGINE.

TO START:

1. Turn off the ignition and disconnect the negative battery cable.

NOTE: Disconnecting the negative battery cable erases pre-programmed electronic memories. Write down all memory settings before disconnecting the negative battery cable. Some radios will require an anti-theft code to be entered after the battery is reconnected. The anti-theft code is typically supplied with your owner's manual. In the event your vehicles' anti-theft code cannot be recovered, contact an authorized dealership to obtain your vehicles anti-theft code.



2. Remove the bolt that secures the fresh air intake scoop shown. This bolt will be reused.



3. Remove the fresh air intake scoop from the vehicle as shown.



4. Remove the two bolts that secure the fresh air intake duct to the core support. These two bolts will be reused in a later step.



5. Remove the fresh air intake duct from the vehicle as shown.



6. Release the crankcase vent hose spring clamp and then disconnect the crankcase vent hose from the intake tube resonator chamber.



7. Disconnect the mass air sensor electrical connection.



8. Remove the airbox retaining bolt shown. **NOTE: This bolt is located at the rear of the airbox near the strut tower.**



9. Loosen the hose clamp, which secures the intake tube to the throttle body. Remove the complete stock intake assembly from the vehicle. **NOTE: K&N Engineering, Inc., recommends that customers do not discard factory air intake.**



10. Remove the two air filter housing mounting grommets shown.



11. Remove the lower front throttle body mounting bolt shown. This bolt will be reused in the next step.



12. Using the bolt removed from the previous step, install the provided tube mounting bracket (070113) onto the throttle body as shown.



13. Remove the slave cylinder bleeder bolt shown. **NOTE: Vehicles equipped with an automatic transmission will not have a bolt in this location.**



14. Install the provided edge trim onto the heat shield as shown. **NOTE: Some trimming of the edge trim will be necessary.**



15. Install the provided edge trim into the hole of the heat shield as shown. **NOTE: Some trimming of the edge trim will be necessary.**



16. Install the provided quarter edge trim into the hole of the heat shield as shown. **NOTE: Some trimming of the edge trim will be necessary.**



17. On manual transmission equipped vehicles, install heat shield mounting bracket #07195 onto the heat shield as shown. On automatic transmission equipped vehicles, install heat shield mounting bracket #010040.



18. Install the shorter rubber mounted stud onto the rear airbox mounting bracket as shown. **NOTE: Be sure to place a large fender washer on each side of the mounting bracket.**



19. Install the longer rubber mounted stud onto the front airbox mounting bracket as shown. **NOTE: Be sure to place a large fender washer on each side of the mounting bracket.**



20. Install the heat shield assembly onto the rubber mounted studs installed in the previous steps and secure with the provided hardware. Secure the heat shield mounting bracket to the slave cylinder bleeder using the factory bolt. On automatic equipped vehicles, secure the heat shield mounting bracket to the bracket on the strut tower with the provided hardware.



21. Reinstall the intake duct onto the core support and into the heat shield assembly. Secure with the factory bolts.



22. Reinstall the fresh air intake scoop and secure with the factory bolt.



23. Remove the two screws securing the mass air sensor, then remove the mass air sensor from the stock airbox as shown.



24. Install the mass air sensor into the K&N® intake tube and secure with the provided hardware.



25. Install the silicone hose (084031) onto the throttle body and secure with the provided hose clamp.



26. Install the K&N® intake tube into the silicone hose installed onto the throttle body and then align it with the tube mounting bracket. Secure the intake tube with the hardware and hose clamp provided.



27. Install the hose mender into the crankcase vent hose provided.



28. Install the crankcase vent hose into the factory crankcase vent hose and then connect the open end onto the K&N® intake tube as shown.



29. Install the K&N® air filter onto the intake tube and secure with the provided hose clamp.



30. Reconnect the mass air sensor electrical connection.



31. Reconnect the vehicle's negative battery cable. Double check to make sure everything is tight and properly positioned before starting the vehicle.

32. The C.A.R.B. exemption sticker, (attached), must be visible under the hood so that an emissions inspector can see it when the vehicle is required to be tested for emissions. California requires testing every two years, other states may vary.

33. It will be necessary for all K&N® high flow intake systems to be checked periodically for realignment, clearance and tightening of all connections. Failure to follow the above instructions or proper maintenance may void warranty.

ROAD TESTING:

1. Start the engine with the transmission in neutral or park, and the parking brake engaged. Listen for air leaks or odd noises. For air leaks secure hoses and connections. For odd noises, find cause and repair before proceeding. This kit will function identically to the factory system except for being louder and much more responsive.

2. Test drive the vehicle. Listen for odd noises or rattles and fix as necessary.

3. If road test is fine, you can now enjoy the added power and performance from your kit.

4. K&N Engineering, Inc., suggests checking the air filter element periodically for excessive dirt build-up. When the element becomes covered in dirt (or once a year), service it according to the instructions on the Recharger® service kit, part number 99-5050 or 99-5000.

STREET LEGAL IN MOST STATES

**NOT LEGAL FOR USE IN CA & OTHER STATES
ADOPTING CA EMISSIONS STANDARDS**

See our catalog or knfilters.com for CARB status on each part for a specific vehicle

* FREE K&N® decal To register your warranty, please see us online at knfilters.com/register. FREE K&N® decal *