

# Dash Multi-Mount Bar, JL & JT

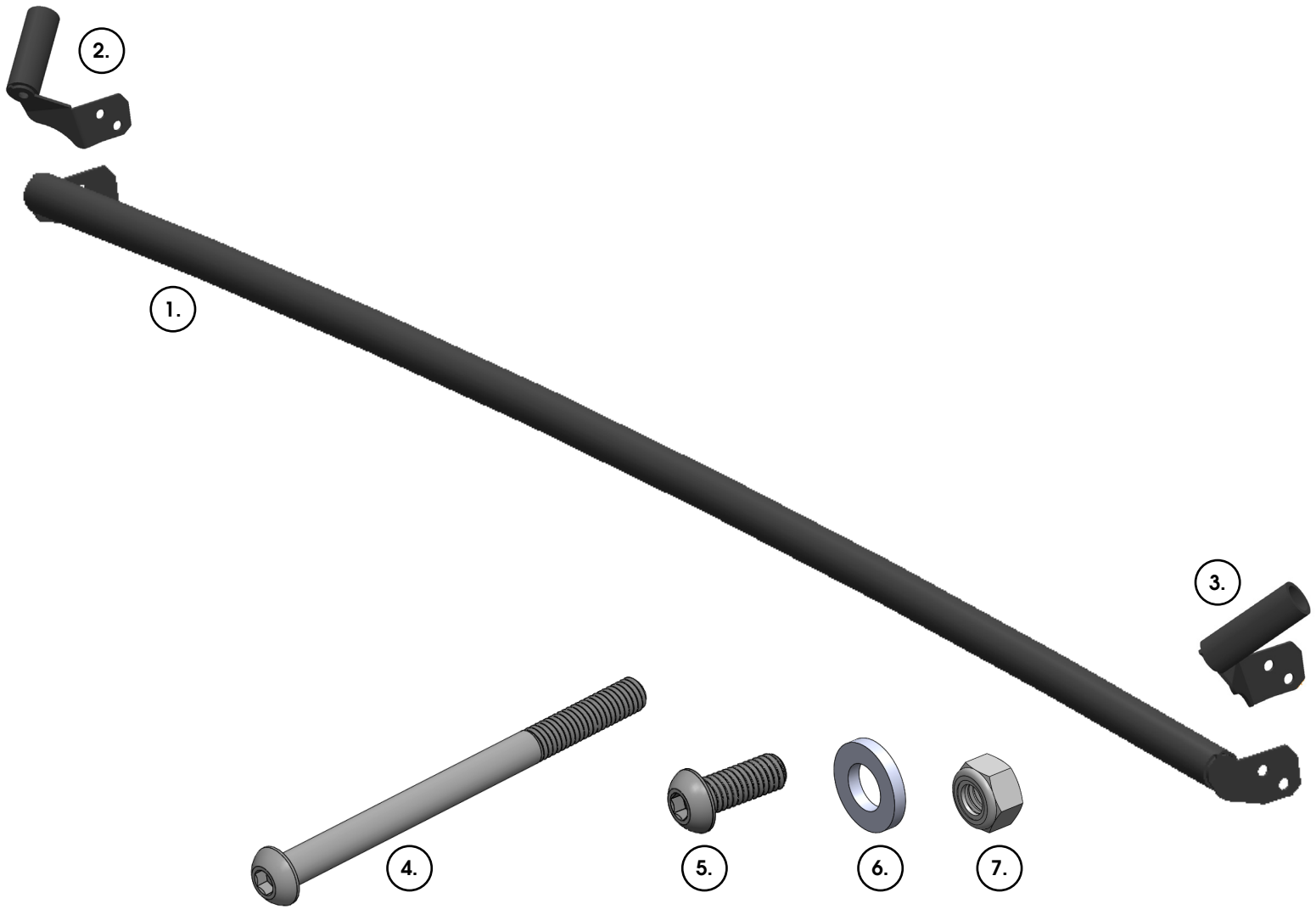

## Components

|   |   |   |    |
|---|---|---|----|
| 1. Center Bar.....                                | 1 | 5. Button Head Bolt M6 x 16mm , Black Finish..... | 4  |
| 2. Driver Side Bar Mount.....                     | 1 | 6. Flat Washer M6 , Black Finish.....             | 10 |
| 3. Passenger Side Bar Mount.....                  | 1 | 7. Nylock Hex Nut M6 x 1.0, Black Finish.....     | 4  |
| 4. Button Head Bolt M6 x 80mm , Black Finish..... | 2 |   |    |

**OMIX-ADA® TECHNICAL SUPPORT**  
 PHONE: M-F 8am - 5pm EST 1-800-449-6649  
 FOR WARRANTY OR TECH CONCERNS EMAIL: [webmaster@omixsupport.com](mailto:webmaster@omixsupport.com)

**ATTN: STATE OF CALIFORNIA CONSUMERS**  
 **WARNING: Cancer and Reproductive Harm - [www.P65Warnings.ca.gov](http://www.P65Warnings.ca.gov).**

## Dash Multi-Mount Bar, JL & JT

1. Pop the plastic cover off the lower portion of the Grab handles located at the windshield pillar. There is a tether applied to this piece. Squeeze the tether prongs to remove completely.

With covers removed use a 10mm socket and ratchet to remove the bolt in this location.



2. Insert the long button head bolt with flat washer through the side mount and thread into the windshield pillar threaded hole that was left from the bolt removed in step 1. Do not fully tighten at this time.



3. Align center bar to dash by matching the arches on the bar to the contour of the vehicle. Position side flanges of the center bar to the side bar mounts.

Feed short M6 button head with washer through both side mount and center bar. Then apply another flat washer and nylock nut.

Now fully tighten all hardware to complete install. Do Not over tighten, hardware just needs to be snug to avoid vibration.

