

# XHD Winch Mounting Spacers, JK

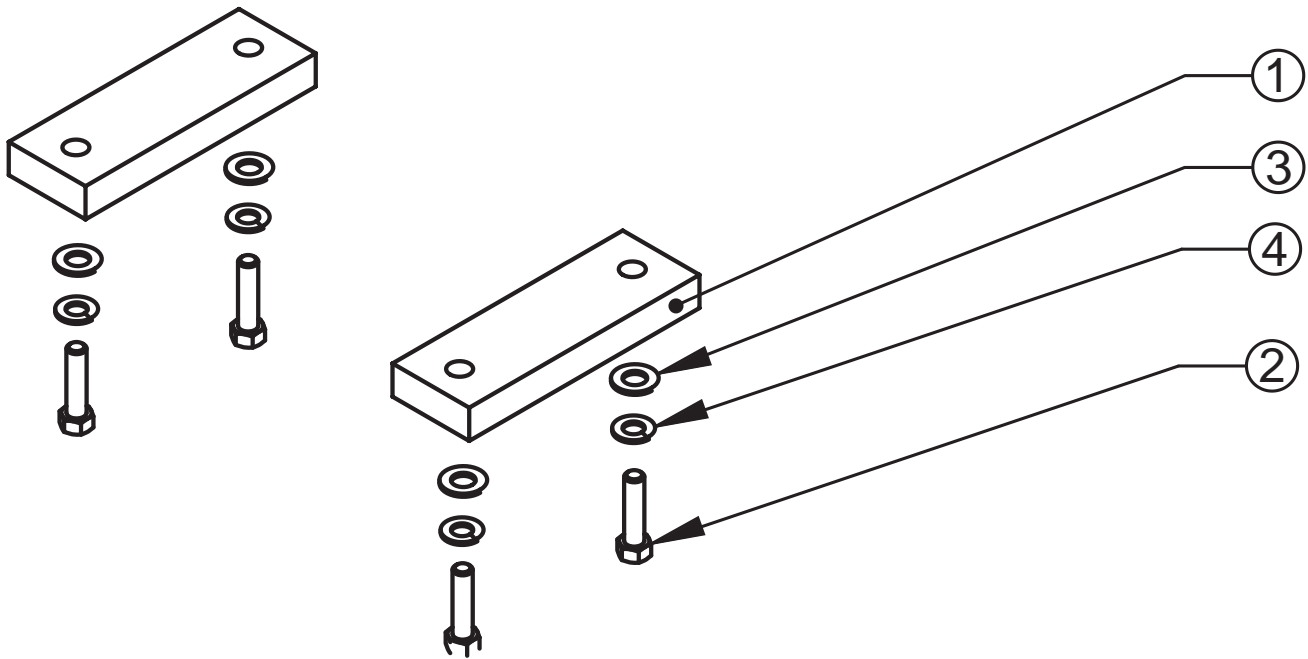

## Components

- 1. Spacer Blocks.....(2)
- 2. 3/8-16 x 2.25" Bolts.....(4)
- 3. 3/8 Flat Washer.....(4)
- 4. 3/8 Lock Washer.....(4)

**OMIX-ADA® TECHNICAL SUPPORT**

**PHONE:** M-F 8am - 5pm EST 1-800-449-6649 | **EMAIL:** techsupport@omix-ada.com

**FOR WARRANTY INFORMATION VISIT:** [www.Omix-Ada.com](http://www.Omix-Ada.com)



OMIX-ADA, Inc.

460 HORIZON DR. SUITE 400 | SUWANEE, GA 30024 | PHONE: 770-614-6101 | FAX: 770-614-6069 | info@omix-ada.com

# XHD Winch Mounting Spacers, JK

1. Winch can be installed with the Bumper on or off of the vehicle. Remove any Hoops from the Bumper. Install Fairlead to Bumper. Note - bolts for Fairlead (supplied with it) should pass from inside the Winch cavity, with the nut being installed on the outside. Tighten Fairlead bolts.

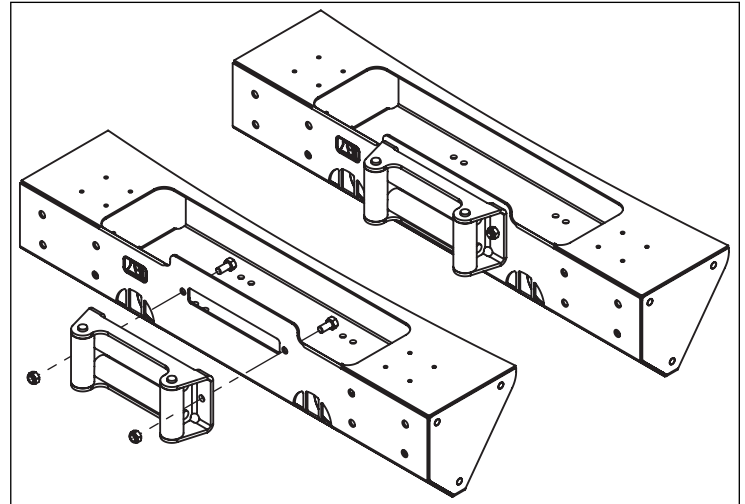

2. Prepare Winch and vehicle for installation as specified in winch installation instructions. Align holes in bumper as shown below (Figure 1) with Spacers and winch mounting holes (Figure 2). It may be helpful to thread winch cable through Fairlead before bolting it in place. Install winch as instructed by winch manufacturer, but substitute standard bolts supplied with the winch for longer bolts supplied with the spacers.

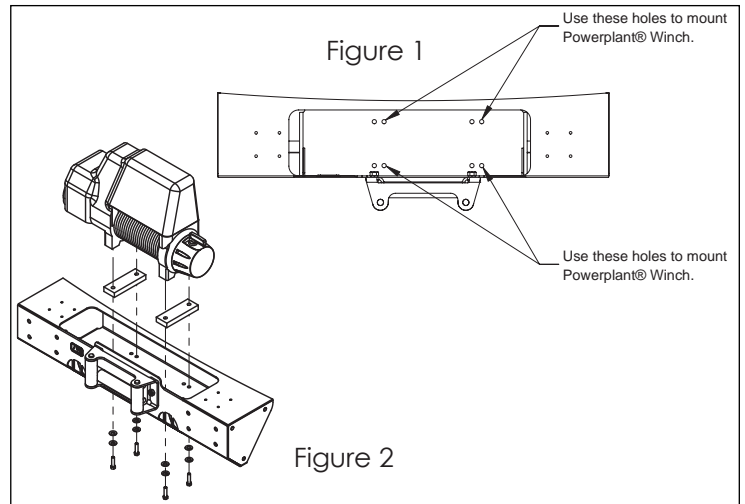

3. Once all 4 Winch bolts have been started, tighten them. Installation of the Winch and the Winch Spacers is now complete! Proceed with the remainder of the installation as demonstrated in the main Bumper Installation Instructions.

