

PARTS INCLUDED

IN YOUR KIT:

- A** Driver side cover rail
- B** Passenger side cover rail
- C** Roll cover
- D** Hardware Bag (see Installation Parts Include).
- E** Front Corner Seals

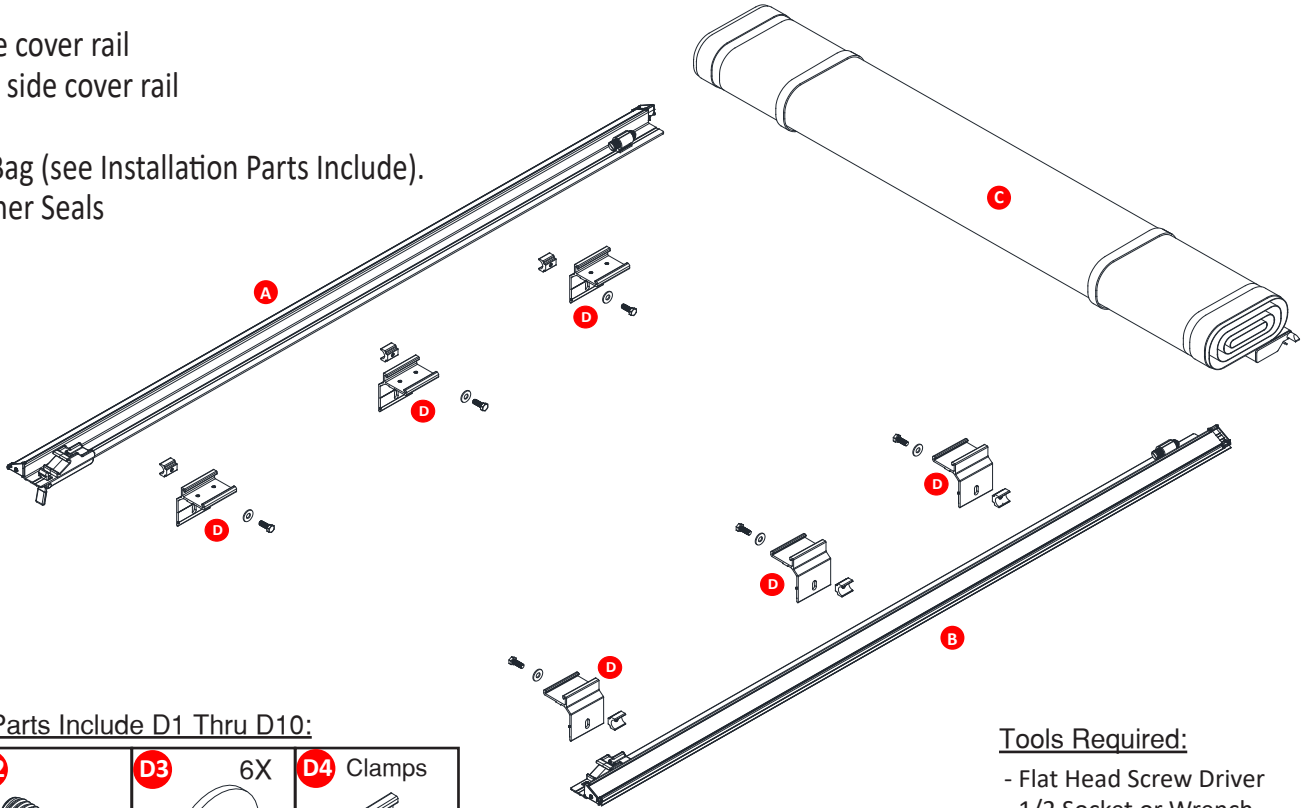

D Installation Parts Include D1 Thru D10:

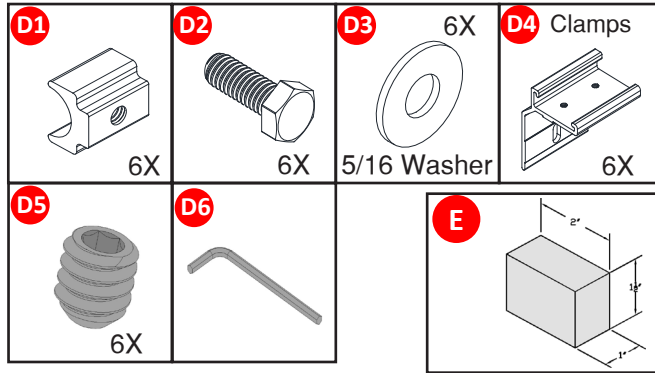

Tools Required:

- Flat Head Screw Driver
- 1/2 Socket or Wrench
- 3/8 Ratchet Drive
- 1/8 Allen Hex Head Tool (supplied in hardware bag)

1 The serial number for the cover is located here.

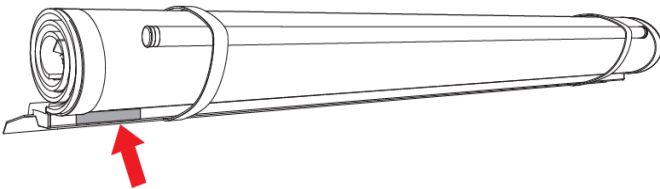

For future reference, write it here:

_____.

2 It is important that all areas where the bed cover mounts are clean and free of debris prior to installing.



- 3** It is important that all areas where the bed cover mounts are clean and free of debris prior to installing.

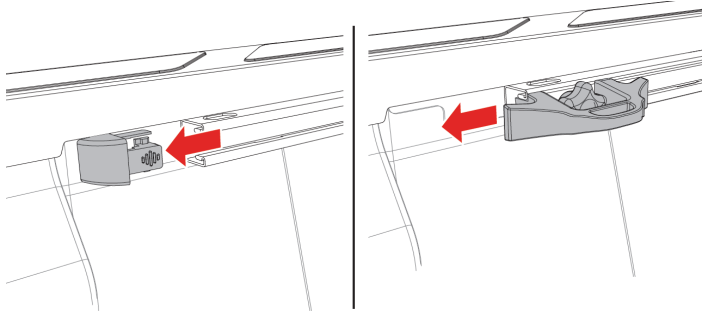

- 4** Install 3 female bracket inserts (D1) into the accessory rail from the tailgate end. Then put the end cap back into the tailgate end of the accessory rail. Repeat installation for drive side.

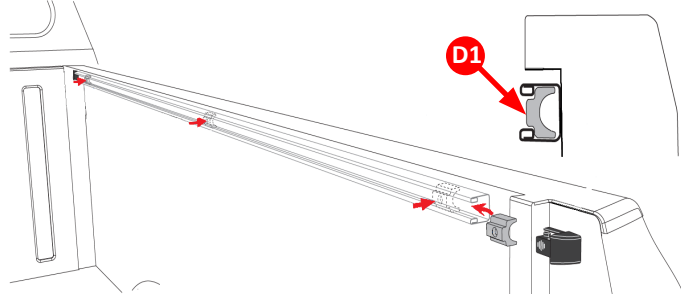

- 5** Insert set screws (D5) into both holes of each bracket as shown below. Leave set screws loose at this time.

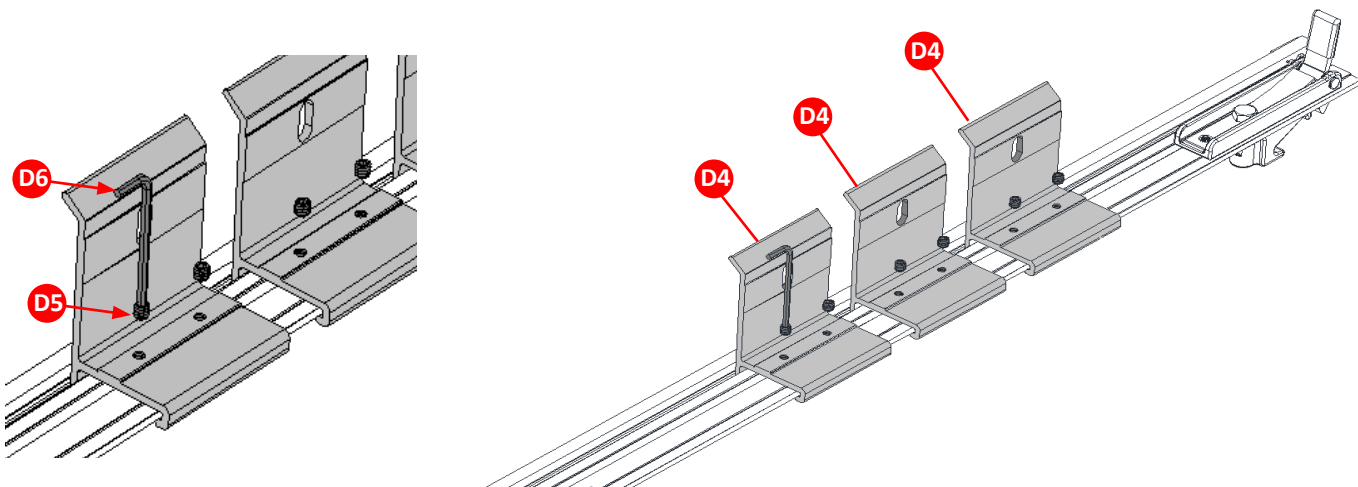

- 6** Attach Front Foam Block Seals (E) found in hardware bag. Peel the white paper backing off and attach the seals into the front corners as shown.

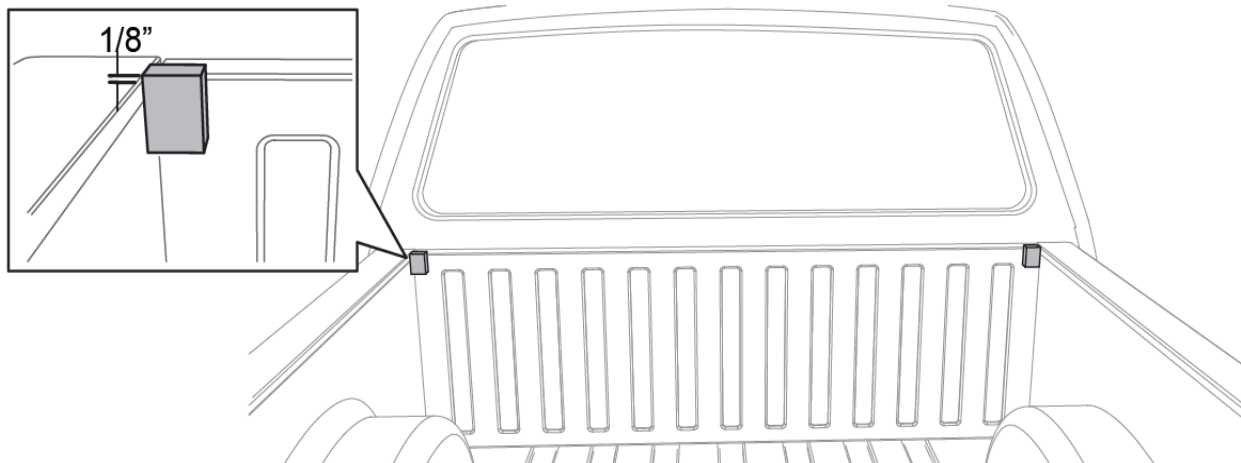

- 7** Place rail in place with the fin seal on top of the bed cap. Position brackets on the rail so there is a bracket at the front, middle, and rear of cargo rail. Align the bracket inserts (D1) located in the cargo rail with the rail brackets. Fasten the rail brackets (D4) to the bracket inserts with screws (D2) and washers (D3). Position the rail 3/8" away from the front face of the bulkhead. Repeat the steps to install the passenger rail.

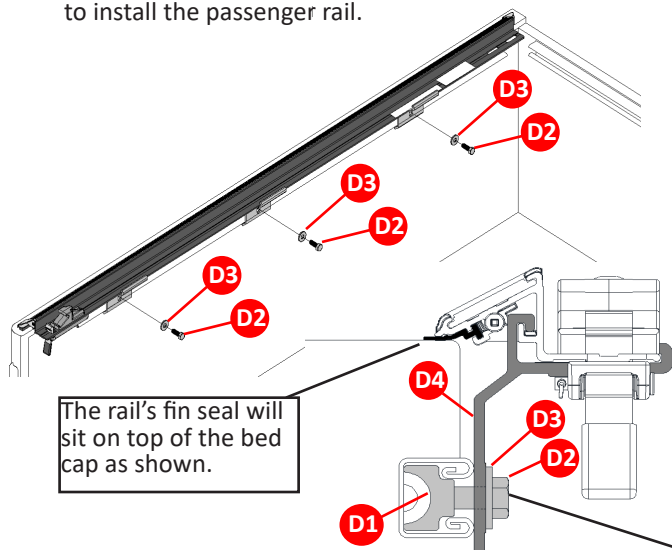

Once the rail is positioned from front to back apply downward pressure on the rail and tighten fasteners (D2) and (D3).

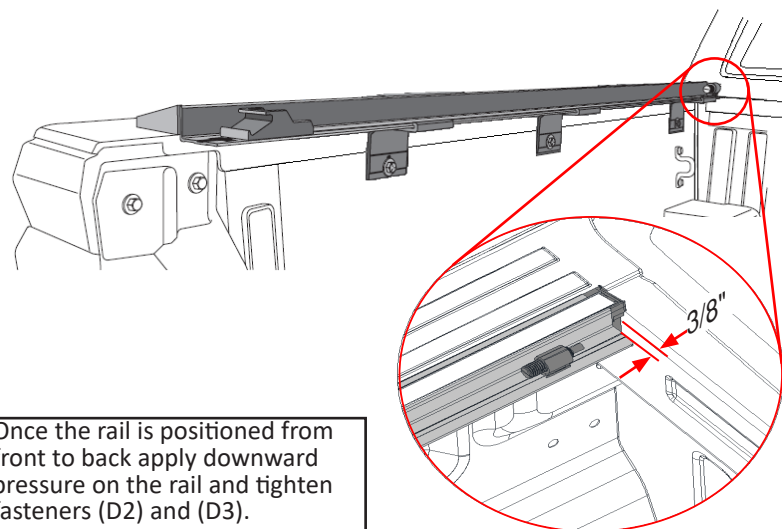

- 8** The sets screws (D5) can now be tightened into to the bottom side of the rail as shown below. Use allen wrench (D6) that has been supplied in the hardware bag.



- 9** Place the cover (C) on the side rails towards the front of the truck bed (near the cab). The front header seal is designed to help shed water and should be sitting on top of the bulkhead.

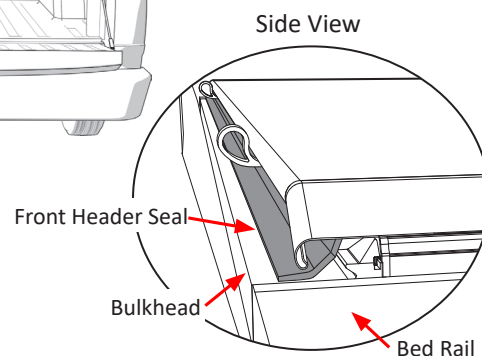
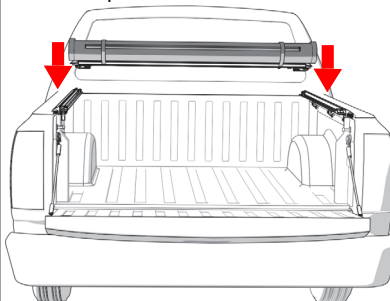

- 10** To connect the cover assembly (C) to the side rails (A & B), slide the right and left header guides into the locked position. A clicking sound will indicate a secure attachment.

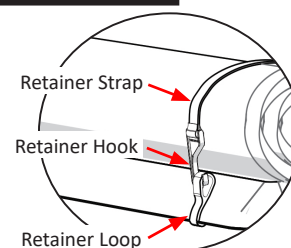
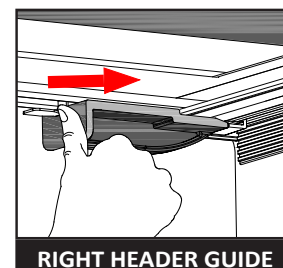
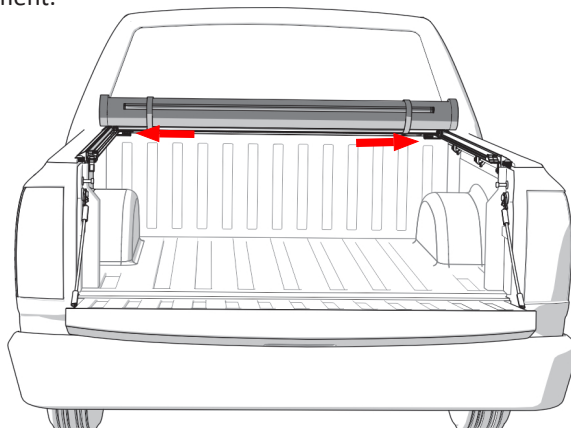
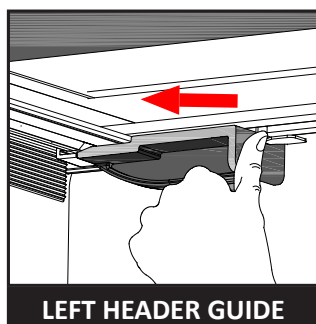

NOTE: If both retainer hooks are properly connected to the retainer loops, you may drive with the cover in the open position.

CLOSING THE COVER

- 11** To drive with the cover in the closed position, disengage the retainer hooks from the retainer loops and unroll the cover towards the tailgate.

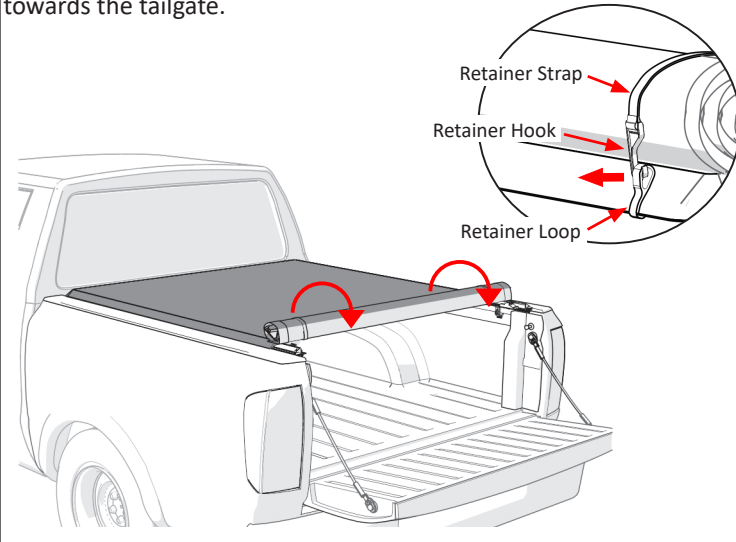

- 12** Place the rear header into the header stops which are located on both side rails. Rotate the rear header downwards until you feel the cover latch in place.

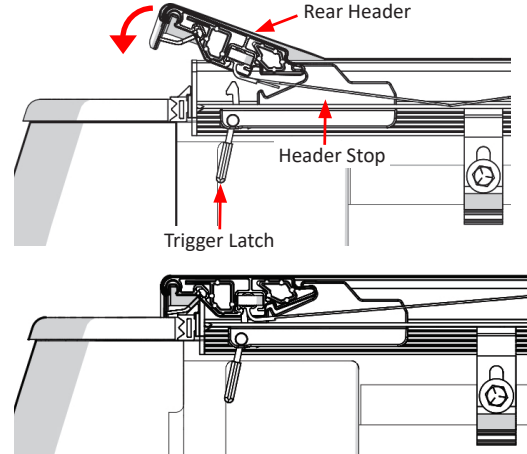

NOTE: We recommend closing the tailgate first and then closing the cover.

- 13** A clicking sound will indicate a correctly installed cover. Next secure the hook and loop fastener along the entire length of both side rails before driving the vehicle, see steps 14 and 15.

NOTE: If the tailgate has a key lock, the cover is secured until the tailgate is unlocked and opened.

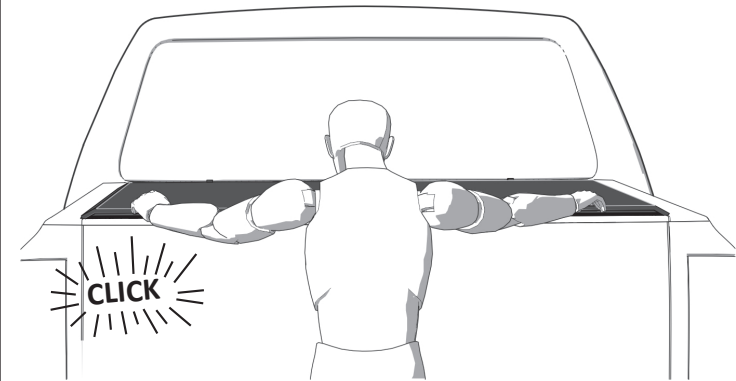

- 14** To secure the hook and loop grab the fabric and pull evenly over the hook track to engage the hook and loop.

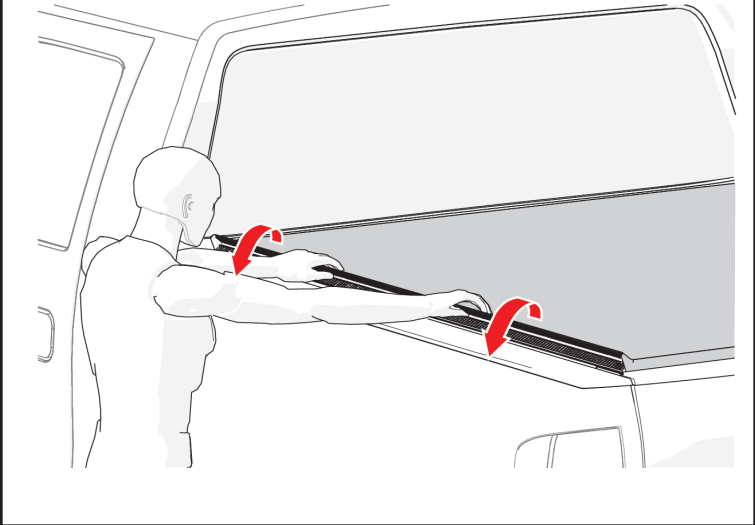

- 15** Once the side of the hook and loop are engaged, use the palm of your hand to firmly push the loop strip into the hook track the entire length of the cover. This will prevent wind from lifting the cover and causing possible damage. Do this on both driver and passenger sides.

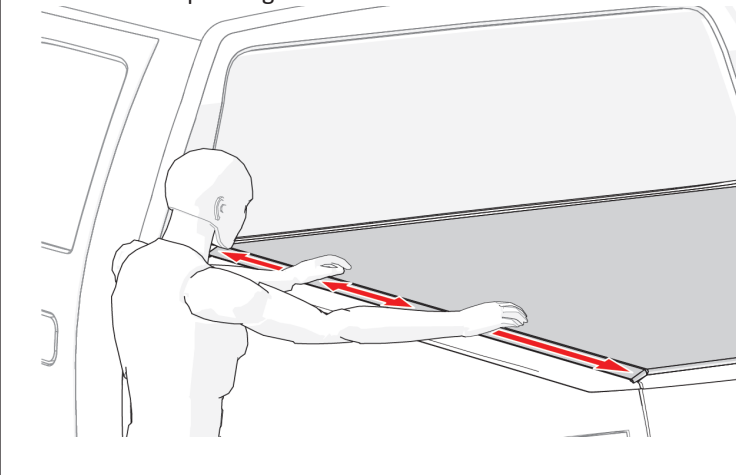

COVER IN THE OPEN POSITION

- 16** To drive with the cover in the open position, pull the latch towards you to release the cover (located on driver side rail). Roll the cover toward the cab of the truck, making sure that both sides roll evenly. Secure the cover by placing both retainer hooks into the retainer loops. **You are ready to drive with the cover in the open position.**

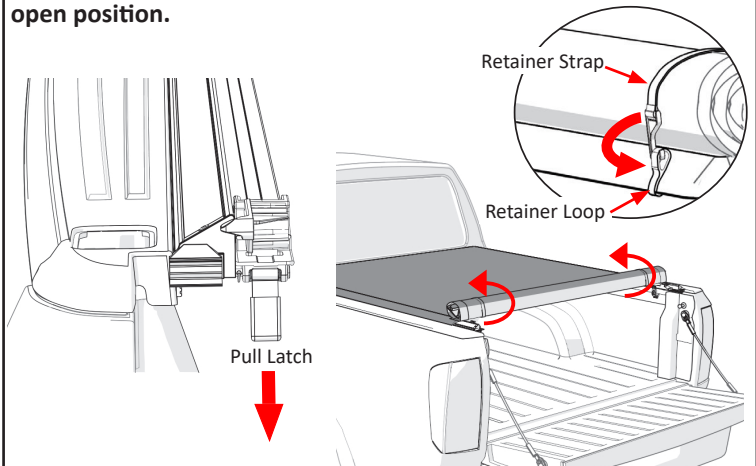

17 Lo Pro is equipped with Automatic Tension Control. This helps compensate for material expansion and contraction caused by extreme temperature changes. Proper tension allows the cover to look and perform at its best. While preset at the factory, you can check cover tension after installation as well as seasonally.

If the cover feels too tight or too loose when opening or closing it, adjust the tension during the warmest part of the day. With the cover closed, release the hook and loop fastener from both side rails near the cab. Check compression of both spring plungers against the front header per Detail C. Roll the cover open and make adjustments. Repeat until satisfactory tension has been achieved.

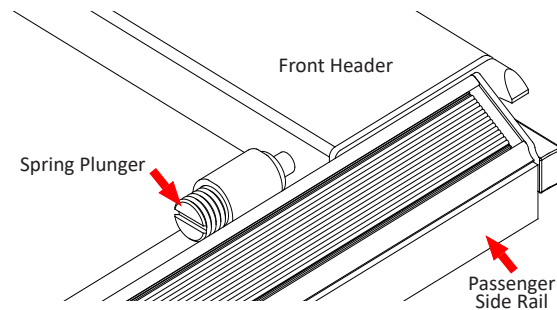
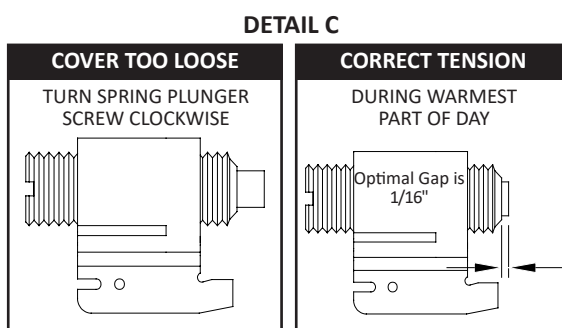

NOTE: Adjust tension in small increments. Slight adjustments will gain significant results.

WARRANTY DURATION

TruXedo®, Inc. ("TruXedo") offers a LIFETIME warranty on Lo Pro, Deuce and Pro X15. Warranty is limited to original purchaser of truck bed cover and is nontransferable. The warranty registration must be on file and/or proof of original purchase (detailed and dated receipt) required for warranty service.

WARRANTY CONDITIONS

This warranty is against defective materials or workmanship. The warranty is void if the product has been damaged by accident, unreasonable use, neglect, improper service/installation/removal, modifications, normal wear and tear or other causes not arising out of defective materials or workmanship. Consequential and incidental damages are not covered under this warranty. TruXedo's obligation under this warranty is limited to repairing or at its option, replacing any part that is returned, transportation prepaid, to Yankton, South Dakota, if the product is, in our judgement, defective. All materials must be accompanied by an RMA (Return Material Authorization) number requested by and authorized in advance of returning the materials. TruXedo shall not be liable or responsible to supply or pay labor to replace any part found defective, nor shall it be liable for any damages of any kind or nature to person, product, or property.

- Please register the warranty online at truxedo.com
- Direct all warranty claims to TruXedo at 877-878-9336
- For available installation videos, visit the TruXedo YouTube channel

**REGISTER
YOUR
WARRANTY
ONLINE**



The Following Conditions will Void Warranty:

- Wind Whip Damage – The cover must be secured at all points when the vehicle is in motion. An unsecured cover will flap, resulting in damage to the vinyl fabric.
- Improper Cleaning – Never use silicone, petroleum, or citrus based products on the bed cover. The vinyl cover can be hand washed with mild soap and water or cleaned in a car wash. Thoroughly rinse the cover to remove any soap residue. The cover can be treated with any vinyl protectant specifically made for tonneau covers.
- Overloading of cargo – Cargo should not contact the tarp at any point. Protrusions in the tarp will stress the vinyl fabric. Cargo may also shift while traveling causing it to press against the vinyl fabric and damage it.

OWNER/USER RESPONSIBILITIES

It is the responsibility of the owner/user to read this manual and comply with the operating procedures. The owner/user is also responsible for inspecting the TruXedo cover and for having parts repaired or replaced when worn or damaged. Failure to follow safety instructions and warning labels could result in failure of your cover system and/or personal injury.

IMPORTANT OPERATING TIPS

- DO NOT roll cover into rear cab window. DO NOT stow against cab.
- After closing the cover, the operator must secure the hook and loop by running their hand down the driver and passenger side rails, pushing down on the cover material.
- If the side rails are tipping, adjust the clamps in order to level the side rails and ensure a proper fit.
- The tonneau cover must be free of foreign material including snow and ice before rolling open or closed.



SAFETY INSTRUCTIONS

- DO NOT place objects on or against cover or framework.
- DO NOT tie cargo to truck bed cover framework.
- DO NOT attempt to drive with the cover in the partially open position.
- DO NOT operate vehicle with objects on top of the cover.
- NEVER allow children or pets to occupy pickup box while cover is closed.
- Cover is not airtight. Special care is required to keep cargo clean and dry.
- Tonneau covers won't prevent theft of contents inside truck box.
- The cover assembly (tarp) must be rolled fully open and secured with retainer straps when towing vehicle backwards.
- If the cover is going to be rolled open for an extended amount of time, periodically re-roll the cover and secure the retainer straps to ensure the cover doesn't rest against the cab of the truck.
- A fully rolled cover in the open position must always be secured with retainer straps.

TROUBLESHOOTING TIPS

- **WRINKLES ON THE VINYL FABRIC AFTER ROLLING COVER CLOSED**
 - o Pull the vinyl fabric taut from each side. For best results, the help of a second person pulling on the opposite side is preferable.
- **SAGGING VINYL FABRIC BETWEEN THE CROSS BOWS**
 - o Adjustment to automatic tension control may be required. See automatic tension control section.
- **WIND LIFTS UP THE EDGE OF THE VINYL FABRIC**
 - o Make sure to engage the hook and loop on the driver and passenger side rails after closing the cover. This may need to be done periodically when taking long trips.
- **VINYL FABRIC FLUTTERS EXCESSIVELY WHEN DRIVING**
 - o Check cover tension. See automatic tension control section.
 - o Make sure hook and loop fasteners are set. See Step 14 and 15.
- **SNOW AND ICE ACCUMULATION ON THE VINYL FABRIC**
 - o Use broom or brush to remove loose snow and ice. DO NOT use sharp or pointed tools to remove snow and ice.
 - o Direct sunlight will help melt snow and ice off the vinyl fabric.
- **TONNEAU COVER WILL NOT LATCH**
 - o Check side rails to make sure they are level. See Step 7.
 - o Make sure the header seal is not caught between side rails & header.
 - o Check the position of side rails on the pickup box. They may be positioned too low. See Step 7.
 - o Make sure the cover has proper tension.
- **VINYL FABRIC IS TOO TIGHT OR TOO LOOSE**
 - o See automatic tension control section.
- **VINYL FABRIC HAS SHIFTED TOO FAR TO ONE SIDE**
 - o Unlatch the cover at the tailgate, release the hook and loop along both sides, go to the shorter side of the tarp and tug. The vinyl fabric will slide in the aluminum headers. Pull on the shorter side until the tarp appears centered on the whole system. Latch the cover and secure the hook and loop down both sides. Repeat if more adjustment is needed.

COVER CARE AND MAINTENANCE

- Never use silicone, petroleum, or citrus based products on the bed cover. The vinyl cover can be hand washed with mild soap and water or cleaned in a car wash. Thoroughly rinse the cover to remove any soap residue. The cover can be treated with any vinyl protectant specifically made for tonneau covers.
- It is recommended that you periodically check that the cover is securely attached to your truck bed. Inspect the clamps and front header guide slides to ensure they were properly installed and have not come loose during operation.
- It is recommended that you periodically inspect and service the rear latch closure. Clean away any excess dirt or grime.
- Covers that are used frequently or are subject to vibrations and impacts from rough roadways may require adjustment.

FAQ

- **WHY IS THERE A HOLE PUNCHED AT THE REAR OF THE PASSENGER SIDE RAIL OF THE TRUXEDO LO PRO, DEUCE AND PRO X15 BUT NO LATCH?**

All side rails are punched identically to keep them uniform, to ensure manufacturing efficiency and to reduce tooling costs. By doing this, TruXedo can build and ship more covers while maintaining competitively priced products of the highest quality.
- **WHY IS MY COVER HOLDING WATER AFTER IT RAINS?**

Water pooling on the cover is normal because our cross bows are not arched. Since they are designed to sit flat some water may accumulate on the top of the cover. Once you drive your truck, the water will shed from the cover. Make sure to retighten the hook and loop fasteners along the length of the bed.

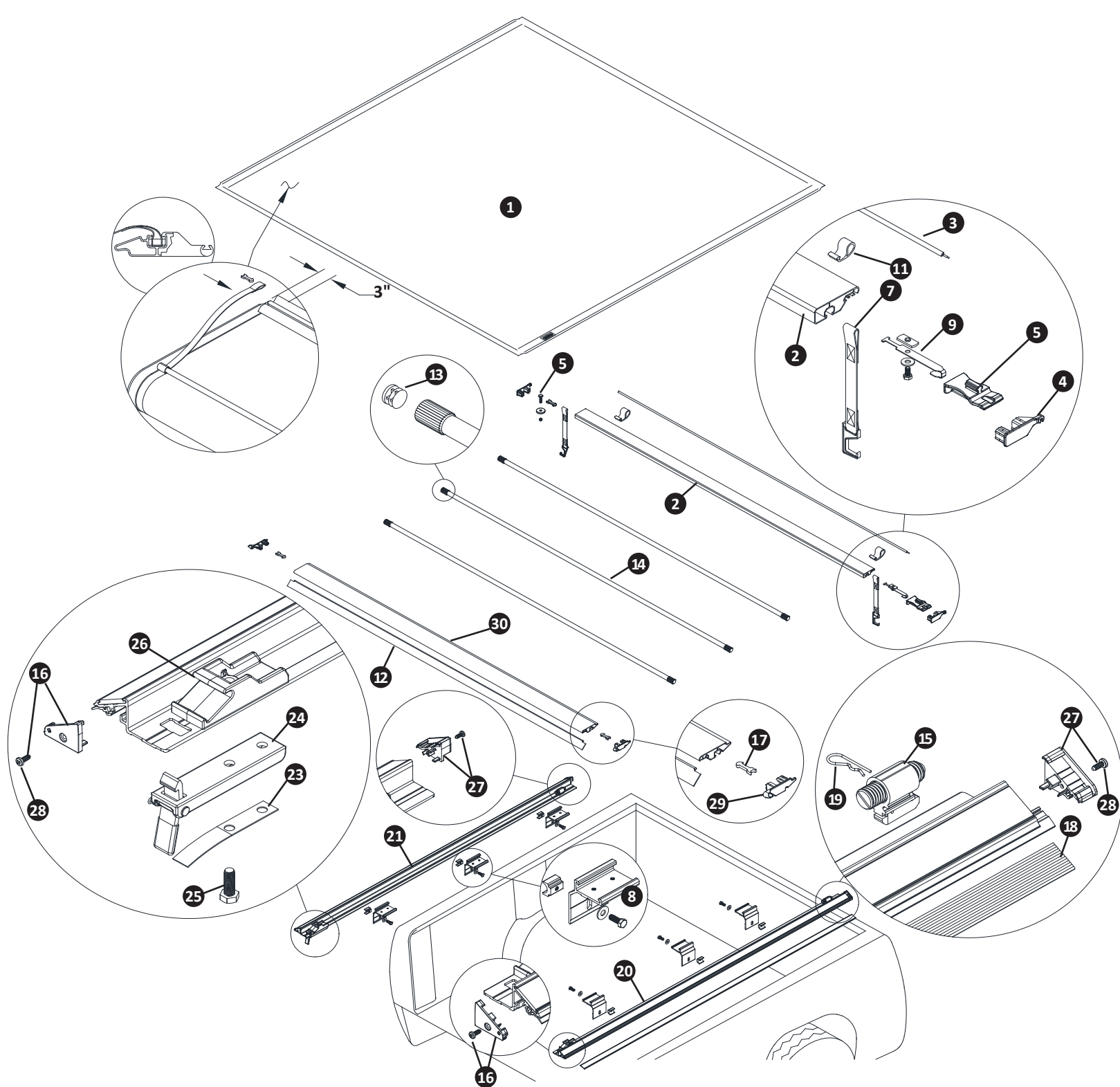

TRUXEDO® LO PRO REPLACEMENT PARTS

- | | | | | | |
|----|---|----|--------------------------------------|----|--|
| 1 | Replacement Cover | 11 | 1705192 Extruded Retainer Loop | 23 | 1114773 Flat Spring, 5/8" x 3 7/8" |
| 2 | Black Front Header | 12 | 1118404 Header Seal Rear | 24 | 1704213 Latch Assembled |
| 3 | 1118998 Header Seal Front | 13 | 1705052 End Plug, 1" OD | 25 | 1702926 Cap Screw, 5/16" x 7/8" |
| 4 | 1118915 Front Header End Plugs (Set of Two) | 14 | Black Bow | 26 | 1704187 Header Stop |
| 5 | 1704707 Header Guide | 15 | 1115356 Tension Control | 27 | 1118950 Front Side Rail End Plugs (Set of Two) |
| 6 | | 16 | 1118987 Rear Side Rail End Plugs (2) | 28 | 1706547 Square Head Screw (#1 Drive) |
| 7 | Retainer Strap | 17 | 1115354 Header Insert Retainer Clip | 29 | 1117467 Rear Header 08 End Plugs (Set of Two) |
| 8 | 1118997 Clamp Bracket Replacement (1) | 18 | 1115174 Hook Fastener Strips | 30 | Black Rear Header |
| 9 | 1117594 Header Guide Retainer Assy. | 19 | 1703332 Hitch Pin, 1/16" x 1 5/16" | | |
| 10 | 1705192 Extruded Retainer Loop | 20 | Side Rail, Passenger's Side | | |
| | | 21 | Side Rail, Driver's Side | | |

* Please specify length or make and model of vehicle.