

PARTS INCLUDED

IN YOUR KIT:

- A** Driver side cover rail
- B** Passenger side cover rail
- C** Roll cover
- D** Hardware Bag (see Installation Parts Include).
- E** Bulkhead seal (on select make/models)
- F** Front and Rear Corner Seals

D Installation Parts Include:

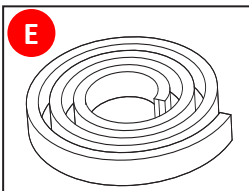
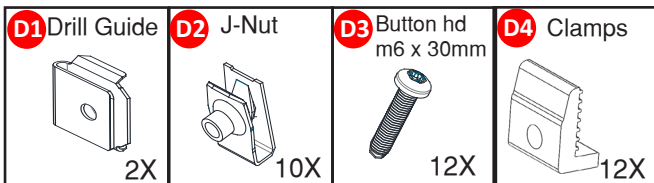

Hardware Bag Containing Front and Rear Corner seals

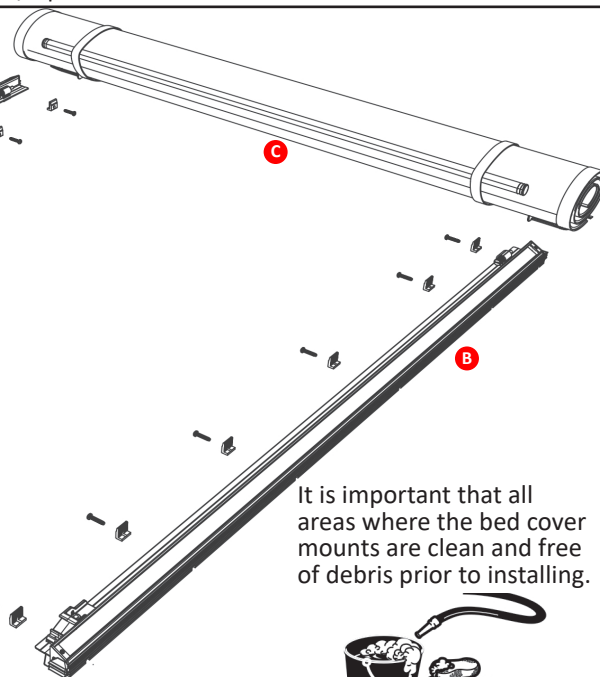
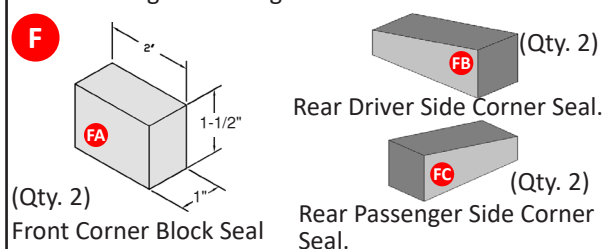

Tools Required:



1 The serial number for the cover is located here.

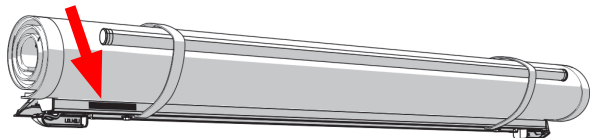

For future reference, write it here: _____

For steps 2 thru 3 use hardware D1 and D2. Drill and 7MM drill bit will also be used in these steps.

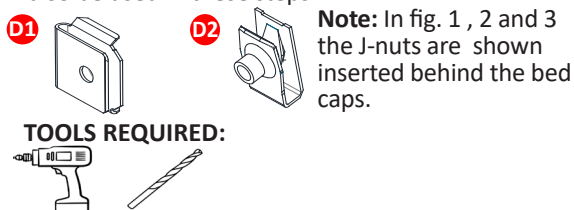

2 U-nut installation, item D2.

Insert the U-nuts by prying the plastic truck bed cap away from the truck bed while sliding the U-nut into the bed wall opening (fig. 1), making sure that the U-nut is aligned with the bed rail hole as shown in fig. 2. Repeat for the passenger side.

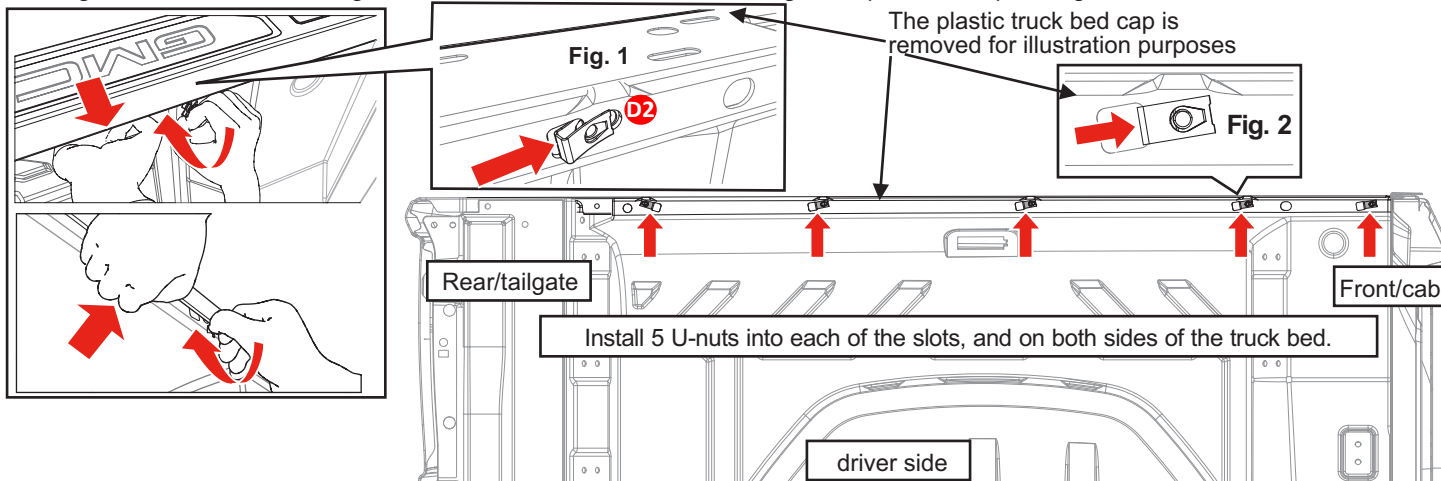

3 Drill mounting holes. Use drill guide, item D1.

Slide the hole drill guide onto the edge of the truck's plastic bed cap and in between the cap and the bed (fig. 3). Align the hole drill guide so that the back of the guide fits into the hole of the U-nut (fig. 4). Drill a 7mm, (9/32") hole through the truck plastic bed cap using the hole drill guide (fig. 5). The back of the hole drill guide will prevent the drill from hitting the truck bed. Repeat this for every U-nut location on both sides of the truck bed.

The plastic truck bed cap is shown as a dotted line so that the placement of the U-nut underneath can be shown.

Fig. 3

Fig. 4

Fig. 5

Drill mounting holes, continued

The truck bed cap sheet metal already has a threaded hole included (fig. 6). A hole must be drilled through the truck's plastic bed cap to access the threaded hole for mounting. Slide the hole drill guide onto the edge of the truck's plastic bed cap and in between the cap and the bed. Align the hole drill guide so that the back of the hole guide aligns with the threaded hole. Drill a 7mm, (9/32") hole through the truck plastic bed cap using the hole drill guide. Repeat this on both sides of the truck bed.

The plastic truck bed cap is shown as a dotted line so that the placement of the threaded hole underneath can be shown.

Fig. 6

Rear/tailgate end, driver side

Rear/tailgate end, driver side

4 Attach Front Foam Block Seals (FA) found in hardware bag (F). Peel white paper backing off and attach foam corner block seals into the front corners as shown.

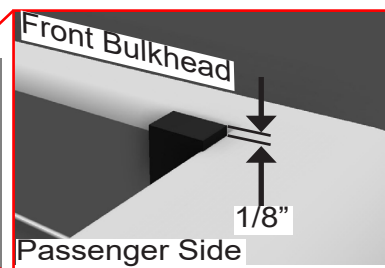
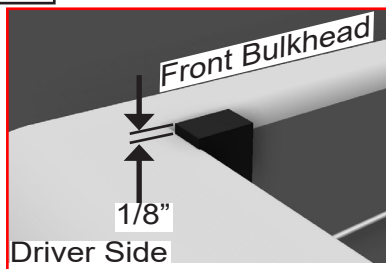

PREPARING THE SIDE RAILS FOR INSTALLATION

5 Attach the foam weather seal pieces, items (FB) and (FC), to the front ends of the driver side rail (A) and passenger rail (B).

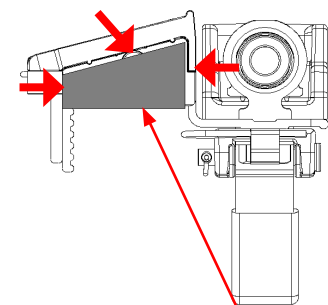
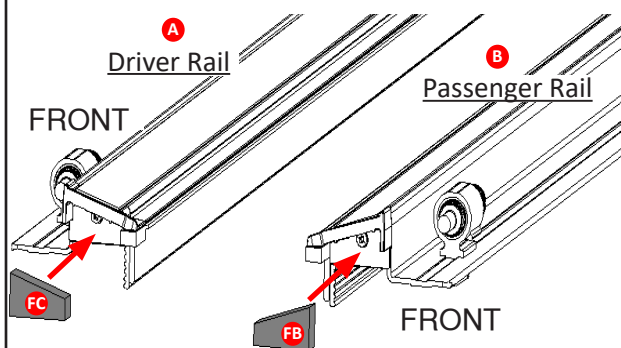

Align the profile of each seal to the profile of the end caps.

INSTALLING SIDE RAILS TO THE TRUCK BOX

6

Install driver and passenger rail. The assistance of a second person is recommended but not required for step 6 thru 9.

To position the side rails to the truck box proceed to step 7.

To install the side rails to the truck box, hardware D3 and D4 will be used. Proceed to step 8 for hardware placement and order of installation.

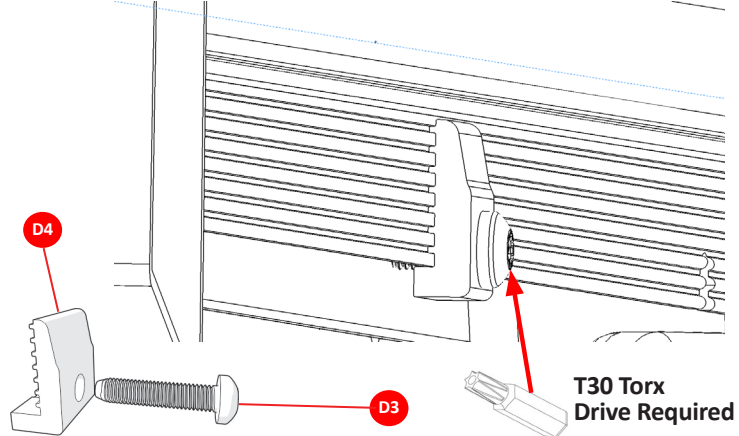
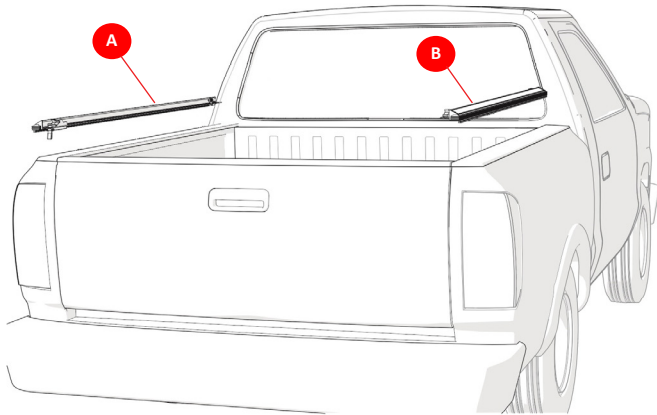

7

Position the driver side rail (A) to the inside of the truck's bed rail, making sure the flange of the driver rail fits on top of the bed cap. The front edge of the rail will be positioned 3/8" back from the bulkhead.

The side rail flange must be positioned on top of the truck's bed cap as shown.

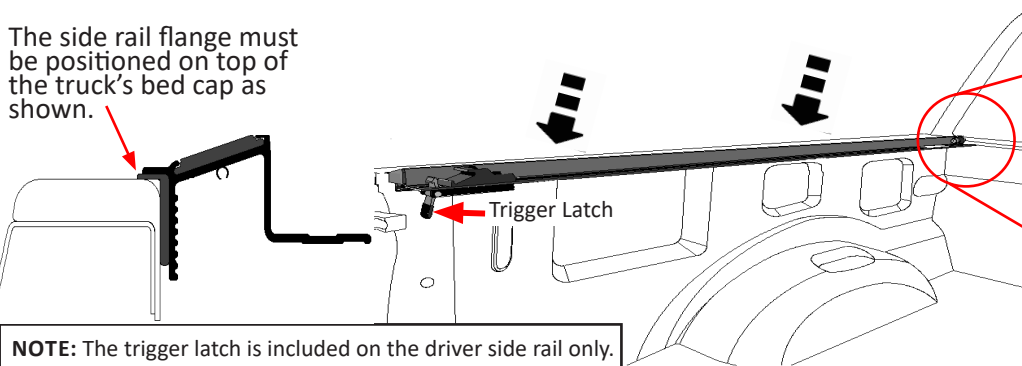

NOTE: The trigger latch is included on the driver side rail only.

8

Clamp Installation. Insert the screw through the clamp, through the cutout in the rail and into the installed U-nut, do not tighten fully. Start with the front/cab hole, (fig.7) and the rear/tailgate hole to hold the rail in place.

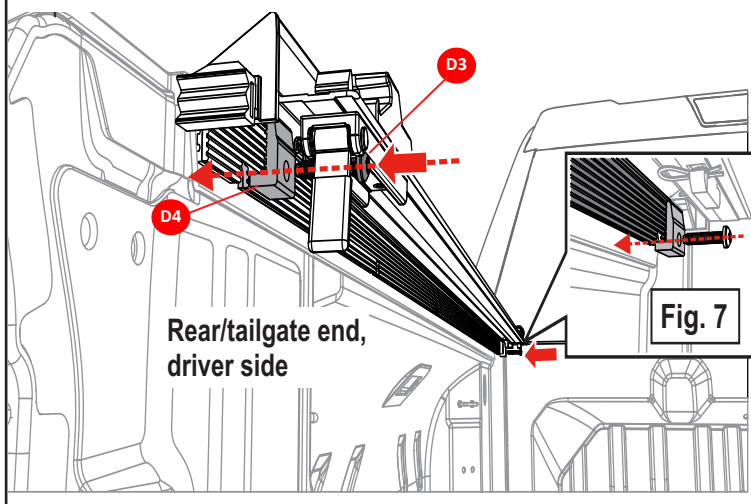

9

Install the remaining four middle clamps. Starting with rear/tailgate tighten the screws. Push the rail into the plastic bed cap when tightening each screw to help the rail seal against the bed cap. Tighten the remaining screws in order to the front/cab. Repeat the installation on the other side.

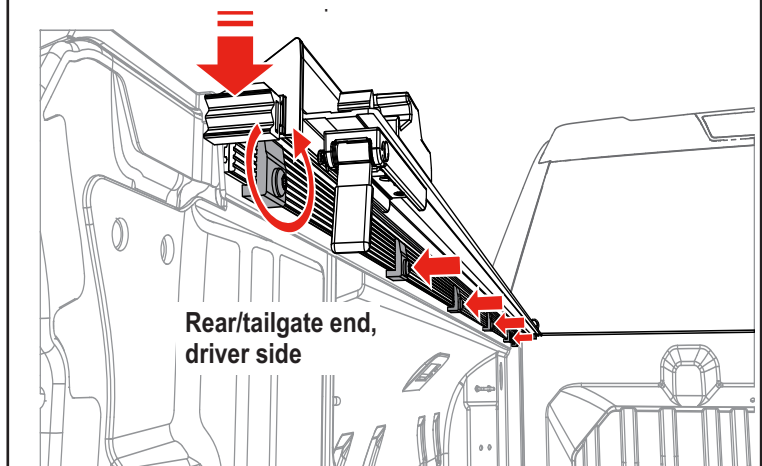

INSTALLING BULKHEAD SEAL:

10

If your pickup has factory or aftermarket bed caps you will need to install the bulkhead seal (E) supplied in the shipping box. Clean the top of the bulkhead before installing the bulkhead seal. Peel the backing paper off and adhere the seal from one bed rail edge to the other. Remove any excess with scissors.

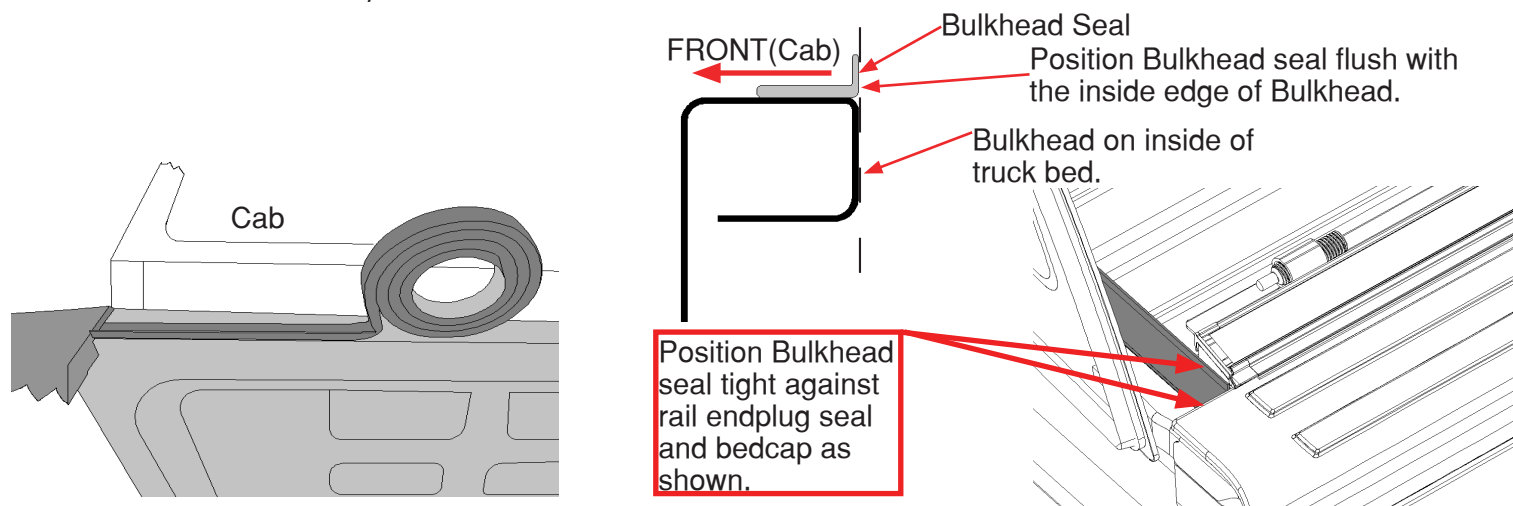

INSTALLING COVER ASSEMBLY TO THE SIDE RAILS:

11

Place the cover (C) on the side rails towards the front of the truck bed (near the cab). The front header seal is designed to help shed water and should be sitting on top of the bulkhead.

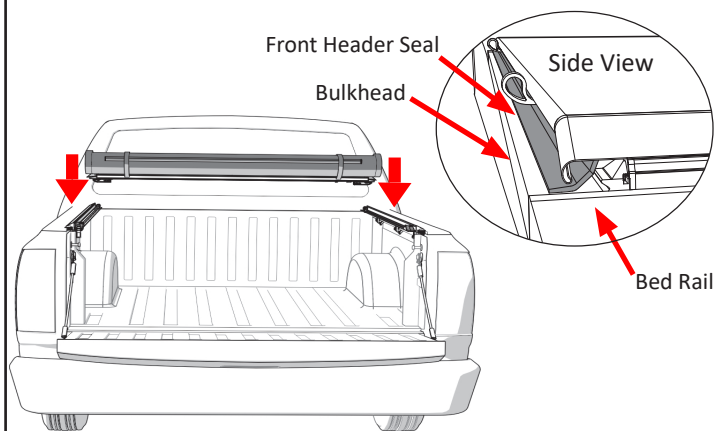

12

To connect the cover assembly (C) to the side rails (A & B), slide the right and left header guides into the locked position. A clicking sound will indicate a secure attachment.

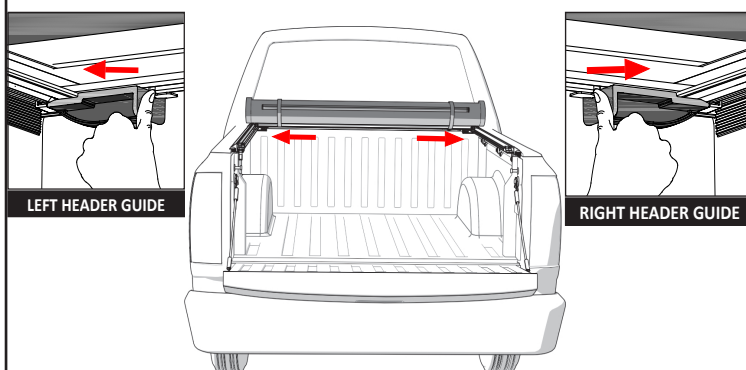

CLOSING THE COVER:

13

To drive with the cover in the closed position, disengage the retainer hooks from the retainer loops and unroll the cover towards the tailgate.

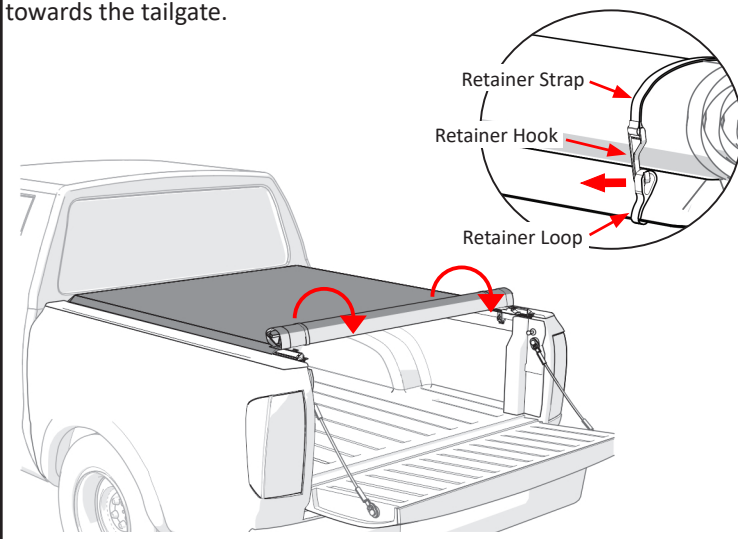

14

Place the rear header into the header stops which are located on both side rails. Rotate the rear header downwards until you feel the cover latch in place.

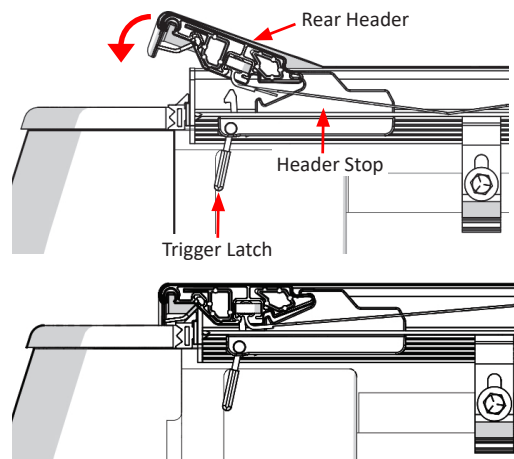

NOTE: We recommend closing the tailgate first and then closing the cover.

CLOSING THE COVER (CONT'D)

15 A clicking sound will indicate a correctly installed cover. Next secure the hook and loop fastener along the entire length of both side rails before driving the vehicle. Simply run your hands down both sides of the cover to achieve this, see fig. 1 and fig. 2 on this page. This will prevent wind from lifting the cover and causing possible damage. **You are ready to drive with the cover in the closed position.**

NOTE: If the tailgate has a key lock, the cover is secured until the tailgate is unlocked and opened.

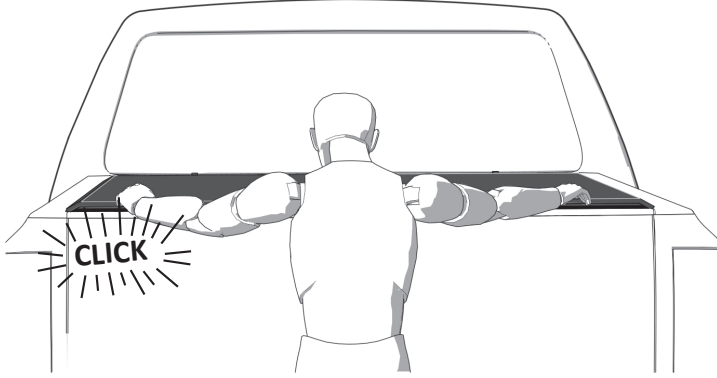

HOOK AND LOOP MUST ALWAYS BE ADJUSTED AFTER ROLLING COVER CLOSED!

Fig. 1, Engaging Hook and Loop, Step One: After rolling the cover closed, grab the fabric loop flap and evenly pull loop over the hook track engaging the loop to the hook track.

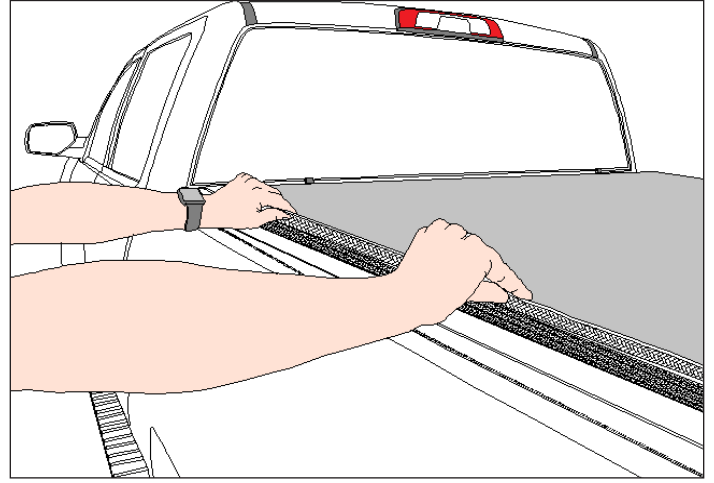

COVER IN THE OPEN POSITION

Fig. 2, Engaging Hook and Loop, Step Two: With the cover closed and both hook and loop engaged, use the palms of your hand to firmly push the loop strip into the hook track. Do this to both driver and passenger side up and down the entire length of the loop seams.

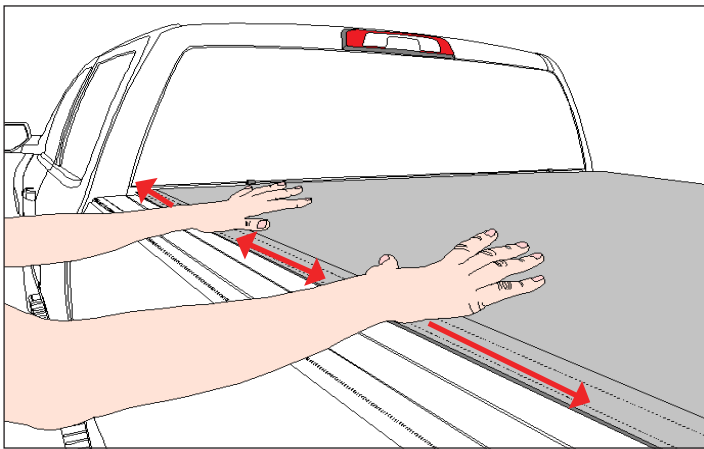

16 To drive with the cover in the open position, pull the latch towards you to release the cover (located on driver side rail). Roll the cover toward the cab of the truck, making sure that both sides roll evenly. Secure the cover by placing both retainer hooks into the retainer loops. **You are ready to drive with the cover in the open position.**

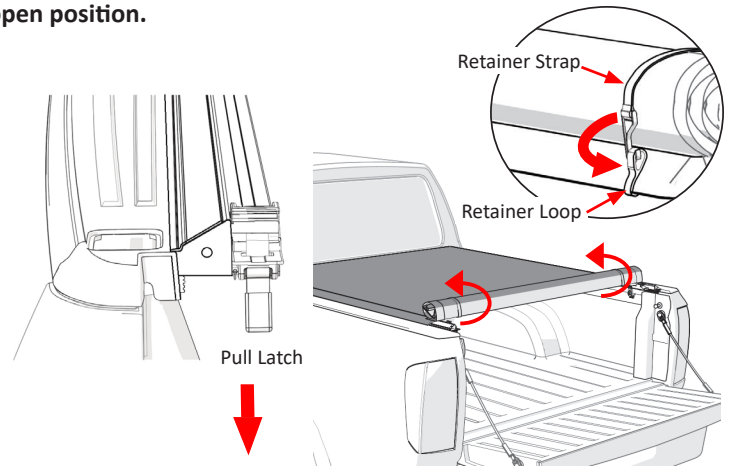

REMOVING THE COVER.

17 To remove the cover from the side rails, push up on the retainer tab and then slide the header guide away from the side rail. Do this on both the driver and passenger side. Carefully lift the cover off the side rails.

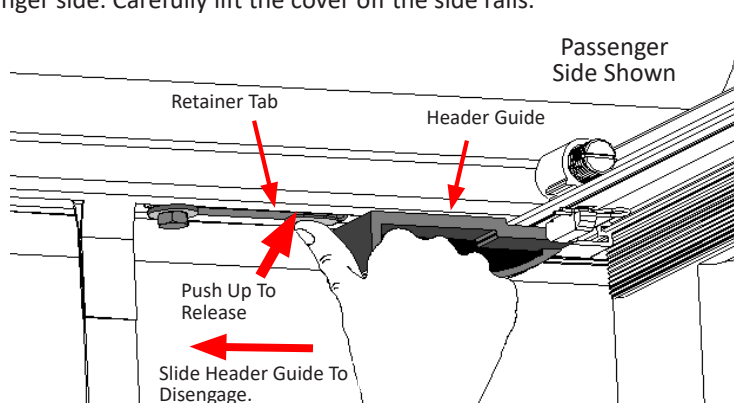

18 Automatic tension control compensates for material expansion & contraction caused by temperature changes. Set tension during **warmest part of day**. With cover closed, release hook and loop fastener from both side rails near cab. Check compression of both spring plungers against the front header per Detail C. Roll cover open and make adjustments. Close cover and re-check adjustment. Repeat until satisfactory tension has been achieved.

DETAIL C

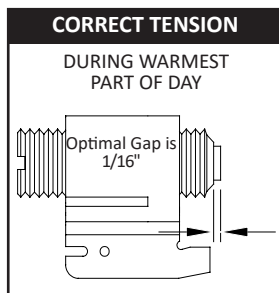
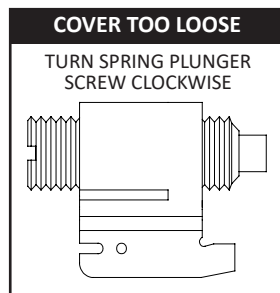

NOTE: Check cover tension after installation, seasonally, and after extreme temperature changes.

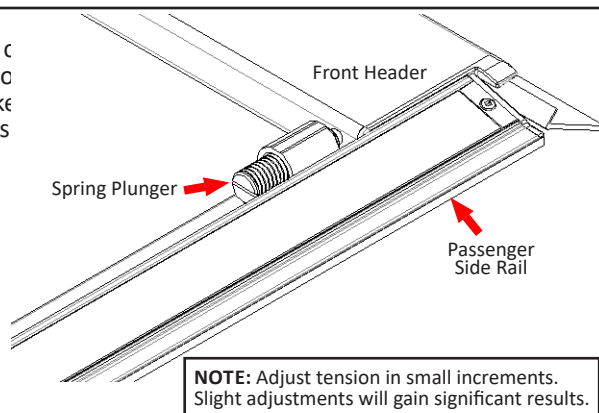

WARRANTY DURATION

TruXedo®, Inc. ("TruXedo") offers a LIFETIME warranty on Lo Pro, Deuce and Pro X15. Warranty is limited to original purchaser of truck bed cover and is nontransferable. The warranty registration must be on file and/or proof of original purchase (detailed and dated receipt) required for warranty service.

WARRANTY CONDITIONS

This warranty is against defective materials or workmanship. The warranty is void if the product has been damaged by accident, unreasonable use, neglect, improper service/installation/removal, modifications, normal wear and tear or other causes not arising out of defective materials or workmanship. Consequential and incidental damages are not covered under this warranty. TruXedo's obligation under this warranty is limited to repairing or at its option, replacing any part that is returned, transportation prepaid, to Yankton, South Dakota, if the product is, in our judgement, defective. All materials must be accompanied by an RMA (Returned Material Authorization) number requested by and authorized in advance of returning the materials. TruXedo shall not be liable or responsible to supply or pay labor to replace any part found defective, nor shall it be liable for any damages of any kind or nature to person, product, or property.

- Please register the warranty online at truxedo.com
- Direct all warranty claims to TruXedo at **877-878-9336**
- For available installation videos, visit the TruXedo **YouTube** channel

The Following Conditions will Void Warranty:

- **Wind Whip Damage** – The cover must be secured at all points when the vehicle is in motion. An unsecured cover will flap, resulting in damage to the vinyl fabric.
- **Improper Cleaning** – It is recommended to use the tested and approved TruXedo PROTEX or clean with soap and water only. Do not use vinyl conditioners (i.e. Armor All®) because they will shrink the vinyl.
- **Overloading of cargo** – Cargo should not contact the tarp at any point. Protrusions in the tarp will stress the vinyl fabric. Cargo may also shift while traveling causing it to press against the vinyl fabric and damage it.

OWNER/USER RESPONSIBILITIES

It is the responsibility of the owner/user to read this manual and comply with the operating procedures. The owner/user is also responsible for inspecting the TruXedo cover and for having parts repaired or replaced when worn or damaged. Failure to follow safety instructions and warning labels could result in failure of your cover system and/or personal injury.

IMPORTANT OPERATING TIPS

- DO NOT roll cover into rear cab window. DO NOT stow against cab.
- After closing the cover, operator must secure hook and loop by running your hand down the driver and passenger side rails, pushing down on the cover material.
- If rails are tipping, clamps can be adjusted to level the side rails to ensure proper fit.
- For optimal fuel economy, it is recommended to operate the vehicle with the cover rolled closed and latched.
- The tonneau cover must be free of foreign material including snow and ice before rolling open or closed.



SAFETY INSTRUCTIONS

- DO NOT place objects on or against cover or framework.
- DO NOT tie cargo to truck bed cover framework.
- DO NOT attempt to drive with the cover in the partially open position.
- DO NOT operate vehicle with objects on top of the cover.
- NEVER allow children or pets to occupy pickup box while cover is closed.
- Cover is not airtight. Special care is required to keep cargo clean and dry.
- Tonneau covers won't prevent theft of contents inside truck box.
- The cover assembly (tarp) must be rolled fully open and secured with retainer straps when towing vehicle backwards.
- If the cover is going to be rolled open for an extended amount of time, periodically re-roll the cover and secure the retainer straps to ensure the cover doesn't rest against the cab of the truck.
- A fully rolled cover in the open position must always be secured with retainer straps.

TROUBLESHOOTING TIPS

- **WRINKLES ON THE VINYL FABRIC AFTER ROLLING COVER CLOSED**
Pull the vinyl fabric taut from each side. For best results, the help of a second person pulling on the opposite side is preferable.
- **SAGGING VINYL FABRIC BETWEEN THE CROSS BOWS**
Adjustment to automatic tension control may be required. See Step 18.
- **WIND LIFTS UP THE EDGE OF THE VINYL FABRIC**
Make sure to engage hook and loop on driver and passenger side rails after closing the cover. This may need to be done periodically when taking long trips.
- **VINYL FABRIC FLUTTERS EXCESSIVELY WHEN DRIVING**
 - Check cover tension, refer to Step 18.
 - Make sure hook and loop fasteners are set. See Step 15.
- **SNOW AND ICE ACCUMULATION ON THE VINYL FABRIC**
 - Use broom or brush to remove loose snow and ice. DO NOT use sharp or pointed tools to remove snow and ice.
 - Direct sunlight will help melt snow and ice off the vinyl fabric.
- **TONNEAU COVER WILL NOT LATCH**
 - Check side rails to make sure they are level. See Step 7 and 8.
 - Make sure the header seal is not caught between side rails & header.
 - Check the position of side rails on the pickup box. They may be positioned too low. See Step 7 and 8.
 - Make sure the cover has proper tension. See Step 18.
- **VINYL FABRIC IS TOO TIGHT OR TOO LOOSE**
See Step 16 to adjust tension.
- **VINYL FABRIC HAS SHIFTED TOO FAR TO ONE SIDE**
Unlatch the cover at the tailgate, release the hook and loop along both sides, go to the shorter side of the tarp and tug. The vinyl fabric will slide in the aluminum headers. Pull on the shorter side until the tarp appears centered on the whole system. Latch cover and secure the hook and loop down both sides. Repeat if more adjustment is needed.

COVER CARE AND MAINTENANCE

- It is recommended to use the tested and approved TruXedo PROTEX or clean with soap and water only. Do not use vinyl conditioners (i.e. Armor All®) because they will shrink the vinyl.
- It is recommended that you periodically check that the cover is securely attached to your truck bed. Inspect the clamps and front header guide slides to ensure they were properly installed and have not come loose during operation.
- It is recommended that you periodically inspect and service the rear latch closure. Clean away any excess dirt or grime.
- Covers that are used frequently or are subject to vibrations and impacts from rough roadways may require adjustment.

FAQ

- **WHY IS THERE A HOLE PUNCHED AT THE REAR OF THE PASSENGER SIDE RAIL OF THE TRUXEDO LO PRO, DEUCE AND PRO X15 BUT NO LATCH?**
All side rails are punched identically to keep them uniform, to ensure manufacturing efficiency and to reduce tooling costs. By doing this, TruXedo can build and ship more covers while maintaining competitively priced products of the highest quality.
- **WHY IS MY COVER HOLDING WATER AFTER IT RAINS?**
Water pooling on the cover is normal because our cross bows are not arched. Since they are designed to sit flat some water may accumulate on the top of the cover. Once you drive your truck, the water will shed from the cover. Make sure to retighten the hook and loop fasteners along the length of the bed.



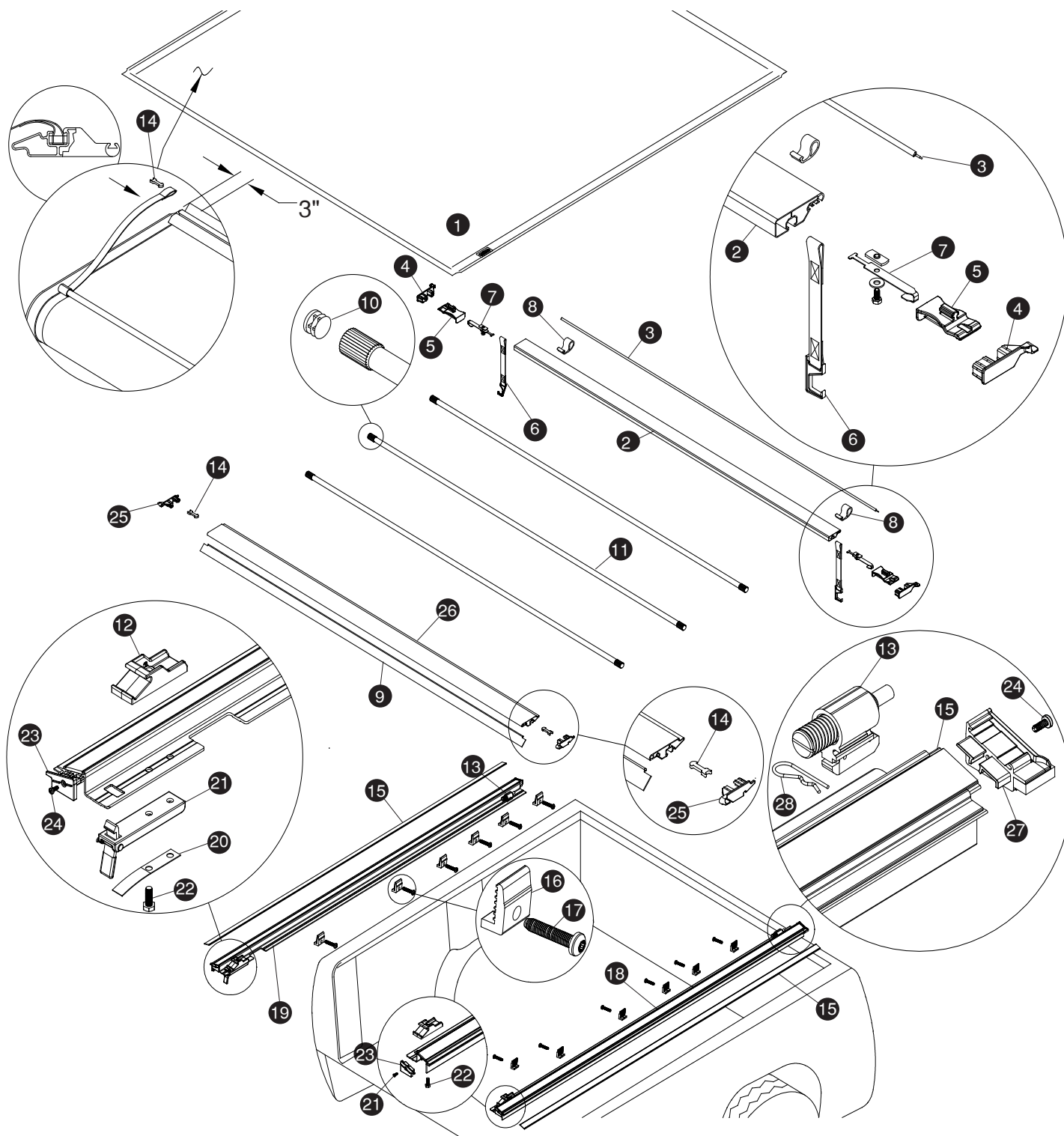

Replacement Parts

1	Replacement Cover	11	Aluminum Cross Tubes	18	1706605 Rail, Passenger's Side
2	Black Front Header	12	1704187 Header Stop	19	1706804 Rail, Driver's Side
3	Header Seal Front	13	1115356 Tension Control Housing & Spring Tension	20	1705727 Flat Spring, 5/8" x 3 7/8"
4	1117540 Front Header Plugs (Set of Two)	14	1705787 Header Insert Retainer Clip	21	1704213 Latch Assembled
5	1704707 Header Guide	15	Hook and Loop Fasteners	22	1702926 Cap Screw, 5/16" x 7/8"
6	Retainer Strap	16	1706491 Aluminum Clamp	23	1118193 Rear Rail End Plugs (Set of Two)
7	1117594 Retainer Assembly	17	1706371 Cap Screw Button Head	24	1705629 Square Head Screw (#1 Drive)
8	Extruded Retainer Loop			25	1118192 Rear Header End Plugs (Set of Two)
9	Header Seal Rear			26	Black Rear Header
10	1705052 End Plug, 1" OD			27	1118248 Front Rail End Plugs w/Seal (Set of Two)
				28	1703332 Pin, Hitch_1/16" Dia. x 1-5/16" Long

* Please specify length or make and model of vehicle.