

## NISSAN FRONTIER DEUCE 2

These instructions replace steps 1, 2, and 3 in the Deuce 2 owners manual.

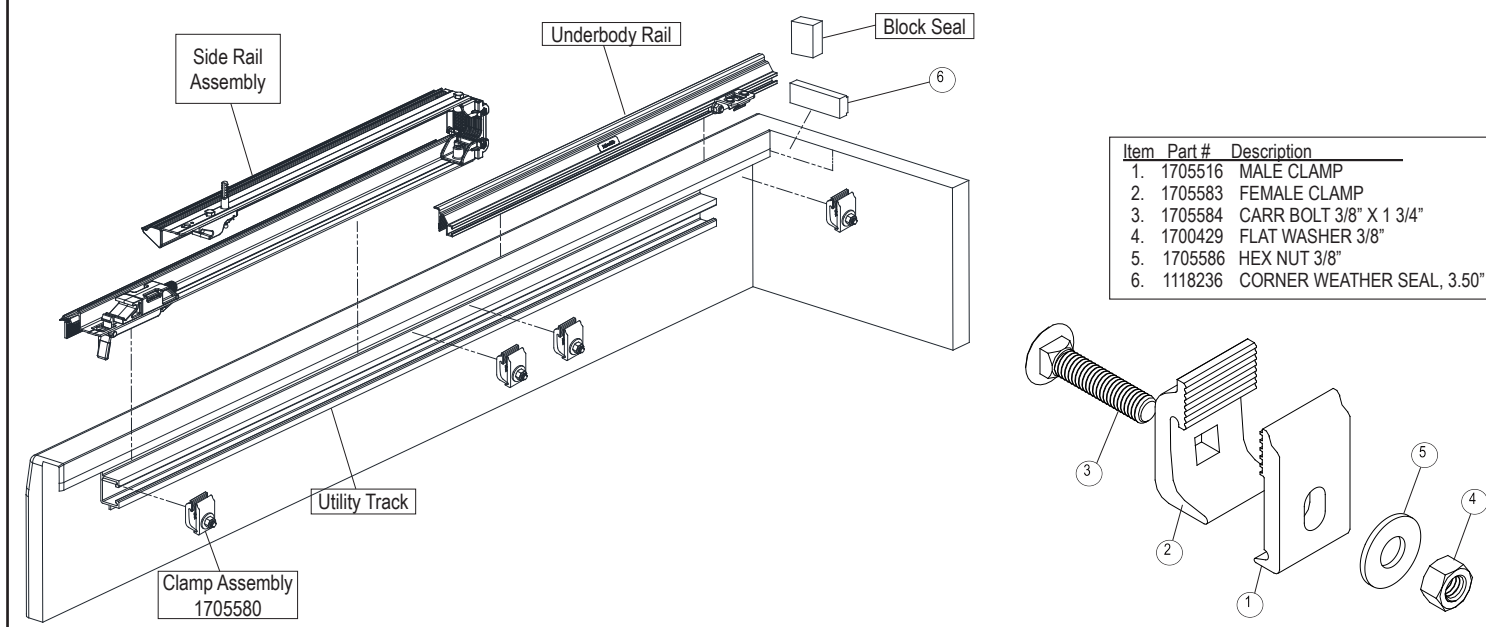

- 1 Install Underbody Rails:** Apply bulkhead weather seal to bulkhead. Make a mark 30-1/4" back from bulkhead seal. Place block seal in corner against bulkhead seal. Seat the underbody rail against the top and inside of the bed rail and slide forward into block seal until the rear of the rail is flush with the mark you made. Clamp tightly using clamp in front of the utility track and clamp above the utility track.

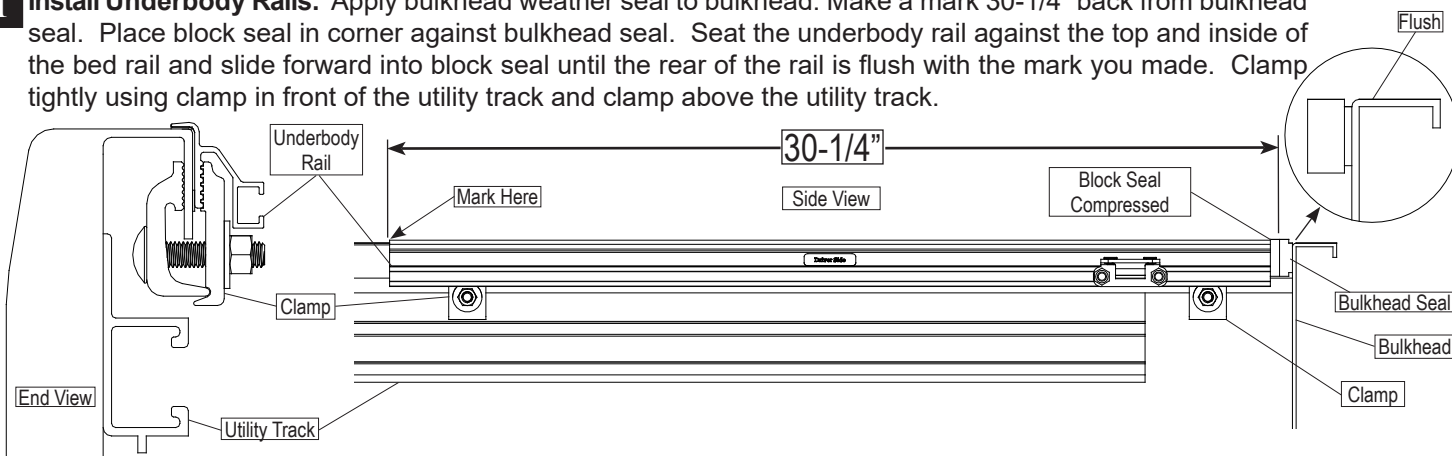

- 2 Install Underbody Rails:** With the front part folded over, place the front end of the rear side rail flush to the rear of the underbody rail. Seat the rear side rail against the top and inside of the bed rail making sure the side rail seal is compressed. Clamp to pickup using one clamp behind the utility rail, and one clamp above the utility rail. Repeat steps 1-2 on Passenger Side.

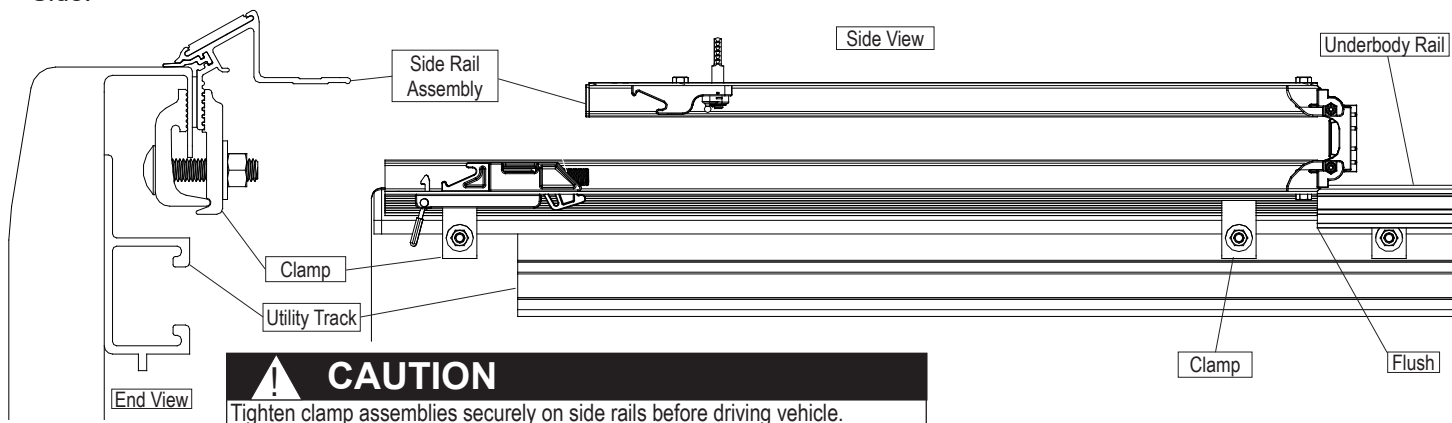

### CAUTION

Tighten clamp assemblies securely on side rails before driving vehicle.

To finish installation, continue with step 4 in the Deuce 2 manual.

by TruXedo, Inc.

P.O. Box 1078, 2209 Kellen Gross Dr., Yankton, SD 57078

Phone: 877- 878-9336 • Fax: (605) 664-9304 [www.truxedo.com](http://www.truxedo.com)

**DEUCE** 2 IS BETTER THAN 1