

AVALANCHE TRUXEDO LO PRO INSTRUCTIONS

Item	Part #	Description
1.		Side Rail, Driver's Side
2.		Side Rail, Passenger's Side
A.	1704705	Side Rail Brkt_Chevy Avalanche_Right_LP
B.	1704706	Side Rail Brkt_Chevy Avalanche_Left_LP
C.	1700419	Hex Nut_Full_Nylon Lock_5/16-18
D.	1700427	Flat Washer_1/4_USS
E.	1701045	Cap Screw_Hex HD_5/16-18 X 3/4 LG

TOOLS NEEDED:

15MM Socket
 1/2" Socket
 1/2" Wrench
 3/8" or 1/4" Ratchet
 Flat Head Screwdriver

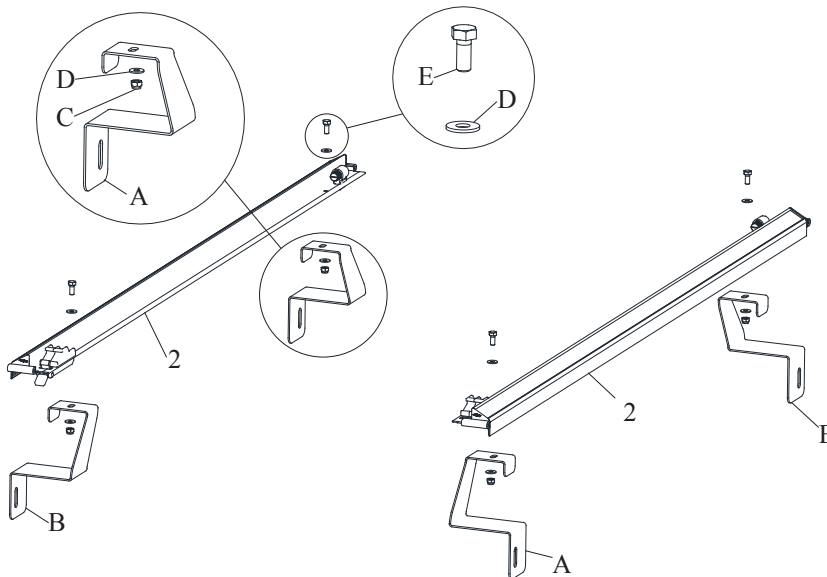

STEP 1: Using the ratchet and the 15MM Socket, remove the upper tie down hooks located near the cab and tailgate on both the driver's and passenger's sides of the truck bed.

NOTE: Upper tie down hooks will not be replaced.

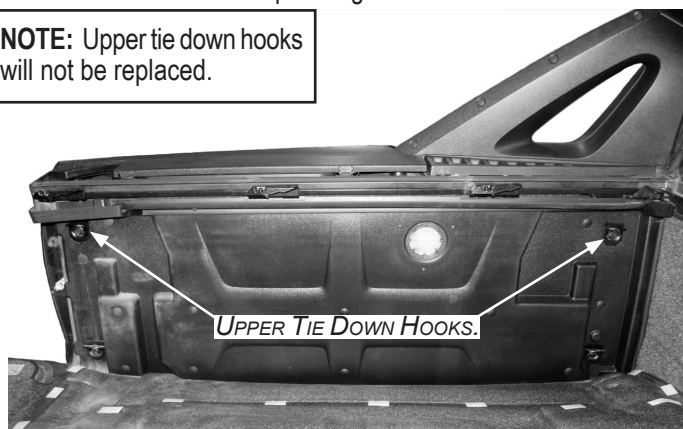

STEP 2: Using the factory bolt removed from the tie down hook, install left side rail bracket (B) in the REAR bolt hole (LEAVE LOOSE FOR NOW).

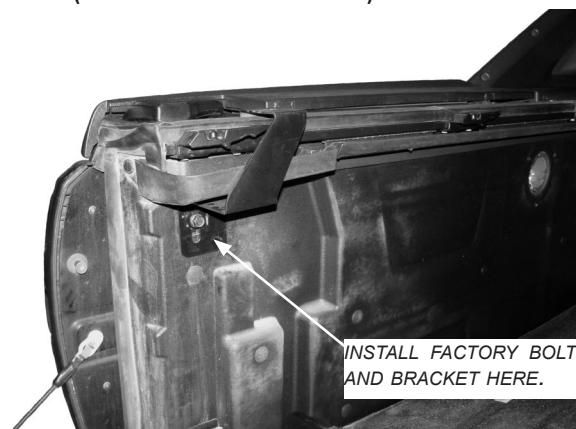

STEP 3: Using the factory bolt removed from the tie down hook, install right side rail bracket (A) in the FRONT bolt hole (LEAVE LOOSE FOR NOW).

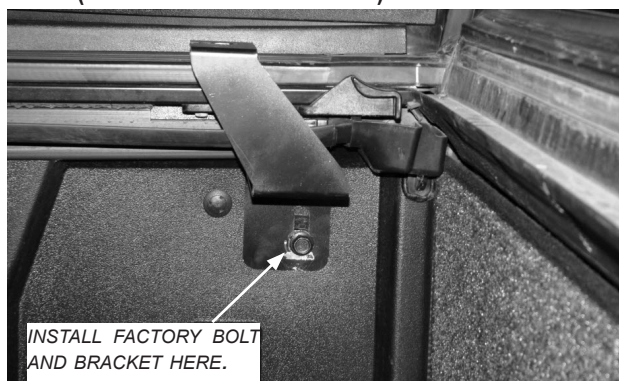

STEP 4: Make sure top surfaces of brackets are sitting flush with each other in order for the side rail to sit level.



NOTE: In older Avalanche models, you may encounter difficulty while threading the front bolt back into the bolt hole. If this happens, pulling back on the bolt while turning holds the nut, allowing the bolt to tighten.

By TruXedo, Inc.
 P.O. Box 1078, 2209 Kellen Gross Dr., Yankton, SD 57078
 Phone: 877-878-9336 • Fax: (605) 664-9304 www.truxedo.com



AVALANCHE TRUXEDO LO PRO INSTRUCTIONS

STEP 5: Align rear hole in Driver's Side Rail with the hole on the rear side rail bracket. Secure rail to bracket using fasteners E, D, and C.

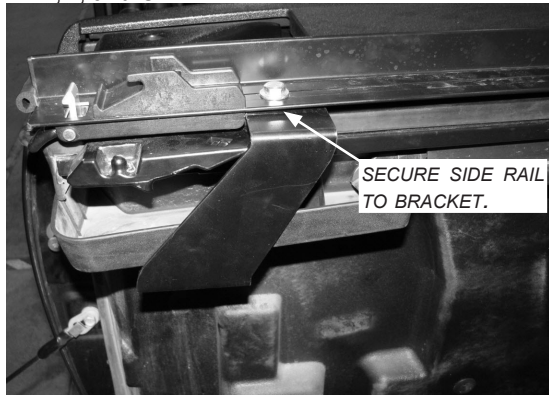

STEP 6: Align front hole in Driver's Side Rail with the hole on the front side rail bracket. Secure rail to bracket using fasteners E, D, C.

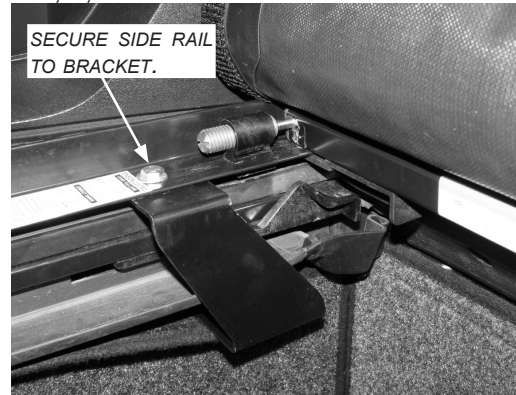

STEP 7: Now that the side rail has been secured and tightened to the brackets, you may tighten the factory bolts that attach the brackets to the side of the pickup bed (Steps 2 & 3). Repeat steps 1-7 on Passenger's Side using bracket (B) in front and bracket (A) in rear.

STEP 8: Next Install the cover assembly at the cab end of truck. For easier cover assembly installation take a flat head screw driver and rotate tension control screw away from cover assembly. Do this on both sides. Refer to owners manual (step 4) for how header guides function.

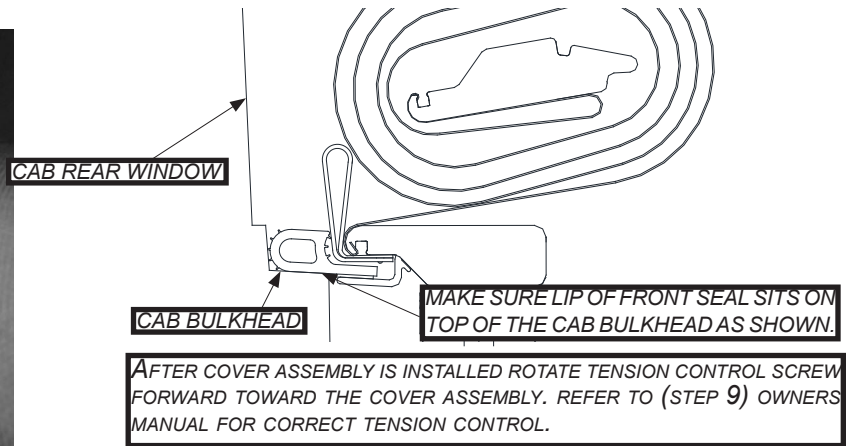
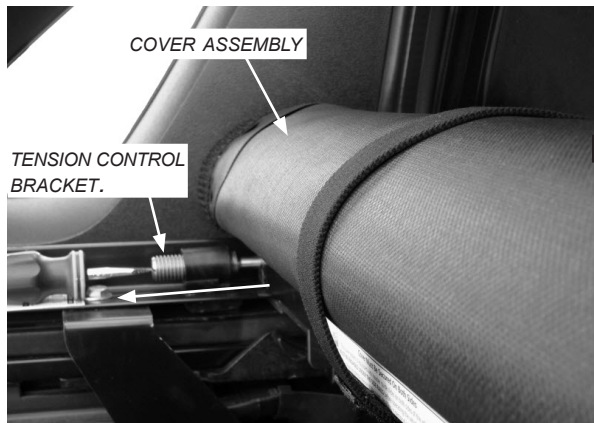

STEP 9: Close cover. Adjust fit by pulling cover side to side.



STEP 10: Latch release.



By TruXedo, Inc.
 P.O. Box 1078, 2209 Kellen Gross Dr., Yankton, SD 57078
 Phone: 877-878-9336 • Fax: (605) 664-9304 www.truxedo.com

TRUXEDO
Lo-Pro
Patented